

FILED

Date: 8-13-2002 By: J

OREGON CORNER RESTORATION FORM

This survey consists of:

Section 30 Township 24S Range 6W

Map: _____

County DOUGLAS

Date July 29, 2002 DOUGLAS COUNTY SURVEYOR

Name: _____

Corner: 65/44-8

Corner Designation

W 1/4 SEC. 30 T 24S R 6W

Condition Report Only

Not Found

Renewed

Unrecorded

Surveyed In

Referenced Out

Previous Renewals/Surveys, etc. 100240

Monument(s) & Accessories Found: (Condition and Source)

1959 IPBC

OBT 40" ROTTED STUMP N66°W, 119

OBT 30" D. FIR DOWN & ROTTED S13E, 403

32" MADRONE - ROTTEN STUMP - NO MARKS VISIBLE S50E, 432

19" RED CEDAR - HEALED - GOOD S16E, 713

17" MADRONE - STUMP - VISIBLE SCRIBING - N85E, 964

6" FIR - STUMP - NO MARKS VISIBLE S64E, 848

1" X 1" T' IRON S47W, 05

Monument Detail

Sketch

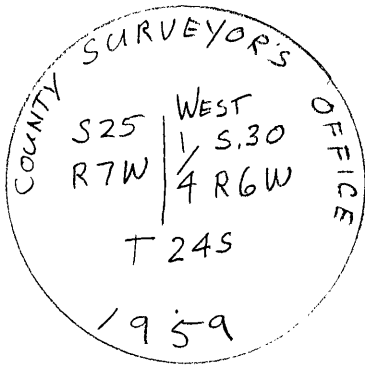

Monument Set (Procedures and Description)

New Accessories

BTs: 17" DOUG. FIR BEARS N. 86° W., 94' SCRIBED "1/4 S25 BT"

10" DOUG. FIR " N. 1° W, 39' " "1/4 S25 BT"

12" DOUG. FIR " S76° E, 20' " "1/4 S30 BT"

Location & Comments

CORNER IS 20' SE OF Compass Declination 18'

RD# 246-19.1 ROAD NOW Firm/Agency ROSEBURG

POCKED FOREST PRODUCTS

Address OLD HWY 99

DILLARD OR

Party Chief R. McMANIS

Notes _____

Witness _____

Surveyor's Seal
REGISTERED
PROFESSIONAL
LAND SURVEYOR

Mark F. Smalley
OREGON
JULY 26, 1988
MARK F. SMALLEY
2354

Renews 6/30/04