

FILED

Date: 6/12/2002 By: X

This survey consists of: \_\_\_\_\_

Map: \_\_\_\_\_

Narrative: \_\_\_\_\_

Corner Rpt: 65/44-5

OREGON CORNER RESTORATION FORM

Section 30 Township 315 Range 4W

DOUGLAS COUNTY SURVEYOR

County Douglas Date June 8, 2002

Corner Designation

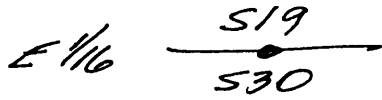

- Condition Report Only
- Not Found
- Renewed
- Unrecorded
- Surveyed In
- Referenced Out

Previous Renewals/Surveys, etc. \_\_\_\_\_

Surveyed in by U.S.B.L.M., 1985 Survey.

Monument(s) & Accessories Found: (Condition and Source)

Found 2 1/2" Iron Pipe with 3/4" Brass Cap, from which a:  
18" D. Fir BT, now blown down, bears N42°E, 16 1/2 Feet.  
18" D. Fir BT, " " " , bears S89 1/2°E, 17 3/4 Feet.

Monument Detail

Sketch

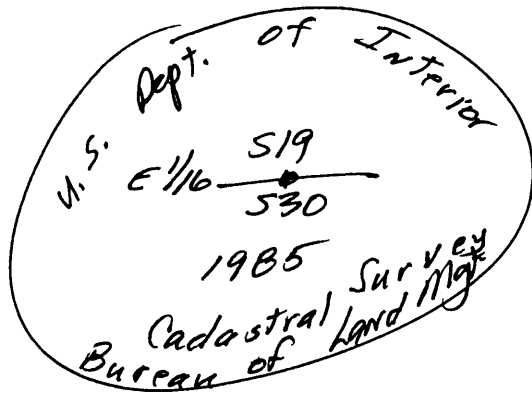

Monument Set (Procedures and Description)

None.

New Accessories

18" D. Fir BT, I scribed "E 1/16 519 BT," bears N75°W,  
22 3/4 Feet.  
12" D. Fir BT, I scribed "E 1/16, S30, BT" bears  
S6°E, 43 1/2 Feet.  
6 Foot Steel Fence Post bears South, 1 1/2 foot.

Location & Comments

The corner lies  
North, 80 feet, from  
an East-West  
Ridge Top Logging  
Spur Road.

Compass Declination 20°E  
 Firm/Agency Shaner  
Engineering, Inc.  
 Address P.O. Box 1430  
Roseburg, OR 97470  
 Party Chief B. Shaner  
 Notes " "  
 Witness Greg Danskin

Surveyor's Seal

REGISTERED  
 PROFESSIONAL  
 LAND SURVEYOR

Bruce A. Shaner  
 OREGON  
 OCT. 4, 1957  
 BRUCE A. SHANER  
 430

Renews June 30,  
2002

C.S. File No 65/44-5