

AFFIDAVIT OF CORRECTION (PLAT)

I, *Wayne L. Rogers*, being duly sworn, depose and say that I am the surveyor who surveyed the property as depicted, filed and recorded as Survey *M136-16*, Douglas County, Oregon Survey Records; and

The following corrections to the Plat are necessary and are as follows: The monument at the Northeast corner of Lot 9, John J. Thennes Grove, should be an offset monument on the north boundary of Lot 9, 1.50 feet, N. 65° 59' 44" W., of the calculated point for the Northeast corner of the lot and the 1/2" iron rod tied from the Northeast corner has been moved and now is located N. 61° 20' 16" W., 0.522 feet, from the calculated point for the Northeast corner of Lot 9.

The present fee owner of the property materially affected by said Affidavit is as follows:

There is no affect to any land owner.

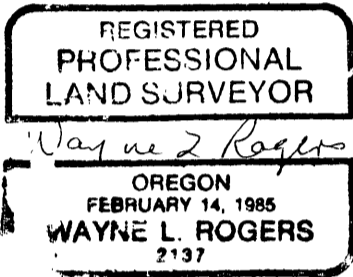

*Wayne L. Rogers*  
Wayne L. Rogers, P.L.S.  
License No. 2137

FILED

Date: *5/13/2002* By: *JR*

This survey consists of:

FOR Map: *M136-16*

Narrative: \_\_\_\_\_

Corner Rpt: \_\_\_\_\_

Expires 12/31/2002

NOTARY CERTIFICATE

STATE OF OREGON  
COUNTY OF DOUGLAS

DOUGLAS COUNTY  
SURVEYOR

Subscribed and sworn to before me this 9<sup>TH</sup> day of MAY, 2002.

*[Signature]*  
Notary Public for the State of Oregon  
My Commission Expires 1-19-2003

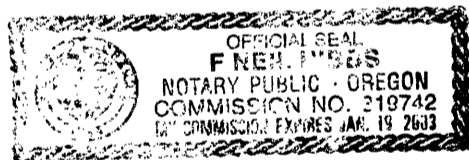

COUNTY SURVEYOR APPROVAL

I, *Romanso E. Ware*, Douglas County Surveyor, do hereby certify that said Affidavit of Correction for Survey *M136-16*, has been examined by me and that it complies with ORS 209.255.

STATE OF OREGON 1 SS  
COUNTY OF DOUGLAS 1  
I, DOYLE SHAVER JR., COUNTY CLERK AND  
RECORDER OF CONVEYANCES, DO HEREBY CERTIFY  
THAT THIS INSTRUMENT WAS RECORDED

*Romanso E. Ware*  
Romanso E. Ware, County Surveyor

02 MAY 10 PM 1:15

DOUGLAS COUNTY CLERK

IN THE OFFICIAL RECORDS OF DOUGLAS COUNTY

BY *[Signature]*

DEPUTY

16.00  
87 FEE 10.00  
26.00

V SURVEYOR