

FILED

Date: 4-15-2002 By: JC

This survey consists of:

Map: H139-72

Narrative:

Corner Rpt: 65/42-42 A-D

OREGON CORNER RESTORATION FORM

Section 36 Township 30S Range BW

DOUGLAS COUNTY  
SURVEYOR

County Douglas Date April 11, 2002

Corner Designation

$\frac{1}{4}$   $\frac{525}{536}$

- Condition Report Only
- Not Found
- Renewed
- Unrecorded
- Surveyed In
- Referenced Out

Previous Renewals/Surveys, etc.

County Surveyor's Office, 1965.

U.S. B.L.M., 1985 Survey in Sec. 25.

Monument(s) & Accessories Found: (Condition and Source)

Found 1" Iron Pipe with 2 1/2" Brass Cap from which a:  
32" D. Fir BT, new 6 foot High Stump, opened face,  
bears S33°W, 52<sup>8</sup> feet.

14" D. Fir BT, new 6 foot high stump, face overgrown,  
bears S7°W, 8<sup>6</sup> feet.

18" D. Fir BT, face overgrown, bears N34°W, 9<sup>2</sup> feet.

14" D. Fir BT, " " , bears S46°E, 22<sup>4</sup> feet.

Monument Detail

Sketch

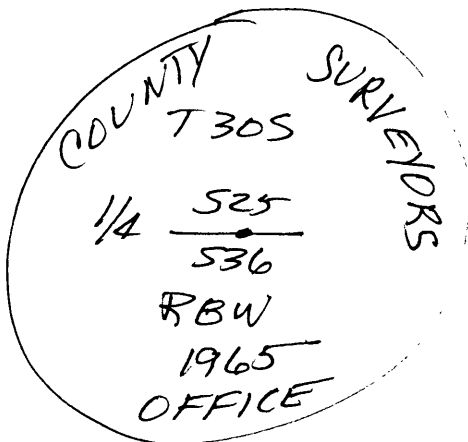

Monument Set (Procedures and Description)

N/A

New Accessories

Set 6 foot steel fence post West, 1<sup>0</sup> feet.

Location & Comments

Surveyor's Seal

Compass Declination 20°E

Firm/Agency Shaner

Engineering

Address P.O. Box 1430

Roseburg, OR 97470

Party Chief B. Shaner

Notes " "

Witness Ron Schneider

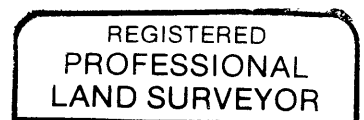

Bruce A Shaner

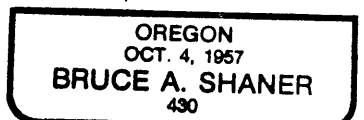

Renews June 30,  
2002

C.S. File No 65/42-42A