

OREGON CORNER RESTORATION FORM

Corner No. 11

Section 27 Township 325 Range 7W

County Douglas Date March, 2002

Corner Designation

C 1/4

- Condition Report Only
- Not Found
- Renewed
- Unrecorded
- Surveyed In
- Referenced Out

Previous Renewals/Surveys, etc. _____

R.L.S. Van Swearingen, Map M21-61, in 1961.*

(* We were requested to redo this survey.)

Monument(s) & Accessories ~~Found:~~ Set (Condition and Source)

I set a 3/4" x 40" Iron Rod with a 2 1/2" Alum. Cap, from which a:
16" Madrone BT, scribes "4186 BT" visible, bears N50°E,
23 feet.

12" Madrone BT, scribes "4186" visible, bears S53°W,
210 feet.

Drill steel set by V.S. bears S50°W, 5' feet.

52" D. Fir BT, I ~~was~~ scribed "C 1/4 BT" bears S28°E,

Monument Detail

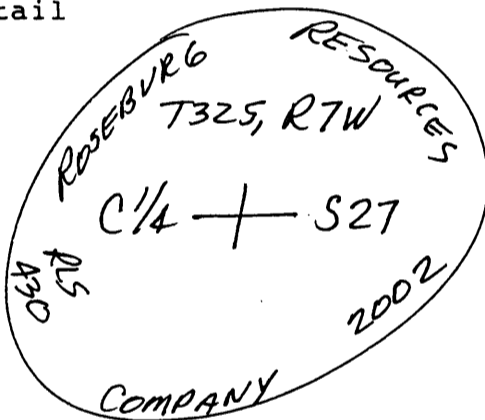

Sketch 248 feet

6 Foot Steel Fence Post,
bears West, 15 feet

FILED

Date: 3/27/2002 By: JC

This survey consists of:

Map: M137-35

Narrative: _____

Corner Rpt: 65/42-11 thru 39

Monument Set (Procedures and Description)

(See above)

DOUGLAS COUNTY
SURVEYOR

New Accessories

Location & Comments

Surveyor's Seal

Compass Declination 20°E

Firm/Agency Shaner

Engineering

Address P.O. Box 1430

Roseburg, OR 97470

Party Chief B. Shaner

Notes " "

Witness Ben Schneider

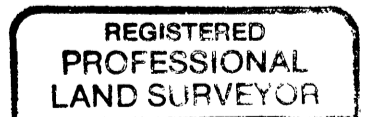

Bruce A. Shaner

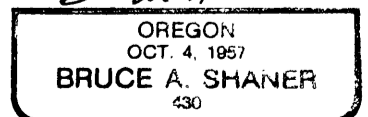

C.S. File No. 65/42-21 Renews June 30, 2002