

OREGON CORNER RESTORATION FORM

Corner No. 3

Section 27 Township 32S Range 7W

County Douglas Date March, 2002

Corner Designation

28 | 27
33 | 34

- Condition Report Only
- Not Found
- Renewed
- Unrecorded
- Surveyed In
- Referenced Out

Previous Renewals/Surveys, etc.

Corner re-established by Douglas County Surveyor's Office in 1977.

Monument(s) & Accessories Found: (Condition and Source)

Found 2" Iron Pipe with 2 1/2" Brass Cap, from which a:
10" Tan Oak BT, face rotten, bears N42°W, 87⁰ feet.
28" D. Fir BT, face overgrown, bears S44°W, 97⁰ feet.
20" Live Oak BT, face overgrown, bears S78°E (record
S81°E), 75⁵ feet (Record 76⁶ feet).
6 Foot Steel post bears N75°W, 15 feet.

Monument Detail

Sketch

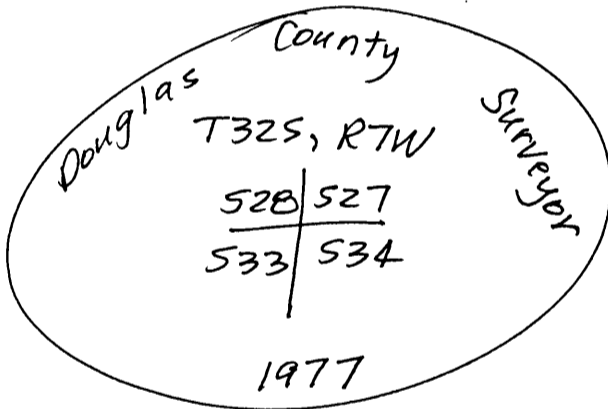

FILED

Date: 3/27/2002 By: JC
 This survey consists of:
 Map: M137-35
 Narrative: _____
 Corner Rpt: 65/42-11 thru 39

DOUGLAS COUNTY SURVEYOR

Monument Set (Procedures and Description)

N/A

New Accessories

6" D. Fir BT, I scribed "S27 BT" bears N16°E,
15⁰ feet.
6 Foot Steel fence post bears South, 1⁰ feet.

Location & Comments

Corner is 31 feet West of centerline of Cow Creek Road.

Compass Declination 20°E
 Firm/Agency Shaner Engineering
 Address P.O. Box 1430
Roseburg, OR 97470
 Party Chief B. Shaner
 Notes " "
 Witness Ron Schneider

Surveyor's Seal

REGISTERED PROFESSIONAL LAND SURVEYOR

Bruce A. Shaner
 OREGON
 OCT. 4, 1957
 BRUCE A. SHANER
 430

Renews June 30, 2002

C.S. File No. 65/42-13