

CERTIFIED RECORD OF LAND CORNER MONUMENTATION

History of original corner establishment:

Frederick W. Rase, Forest Service Surveyor, established original corner 4 of Homestead Entry Survey No. 178, in 1916. He set a 24x10x8 ins. stone, 14 ins. in the ground marked with a cross and "4 HES 178" on the side facing the homestead. He marked original bearing trees: a 14" oak, N.74°00'W., 128 links, scribed "X 4 HES 178 B T" and a 14" pine, N.75°15'E., 23 links, scribed "X 4 HES 178 B T".

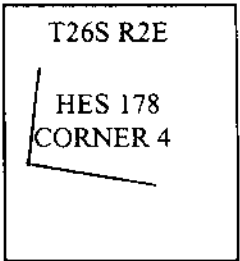

The corner was perpetuated by Ben B. Irving, County Surveyor, on plat M12-40 and C.S. File No. 38/31 (T26S, R2E Renewal No. 2) in 1945. He reset the original stone and drove a 5/8"x24" iron rod alongside.

The corner was perpetuated by Vernon R. Tracy, Deputy County Surveyor, in C.S. File No. 52/43 (T26S, R2E Renewal No. 30) in 1969. He found corner stone and replaced it with a brass cap marked as shown. He marked new bearing trees: an 18" Y. Pine, S.76 1/2 °E., 88.1 feet, scribed "4 HES 178 CS BT" and a 16" D. Fir, S.83°W., 77.2 feet, scribed "4 HES 178 CS BT".

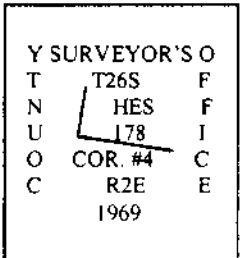

The corner was perpetuated by Robert G. Dean, L.S. 1808, on plat M98-20 and C.S. File No. 63/5 in 1985.

Description of corner evidence found: October 29, 2001

I found a 1" iron pipe with 2 1/2" brass cap established by Tracy in 1969 marked as shown above, firmly set in concrete, projecting 12" above ground. The remains of the original corner stone are now scattered on the ground. I place a 3-foot diameter mound of stone around the iron pipe, which now projects 4".

From which the remaining original bearing trees:

8" remains of ponderosa pine stump, bears N. 79° E., 14.7 feet (rec. N.75°15'E., 15.18 ft. per Rase, 1916, and N.78°30'E., 15.0 ft. per Dean, 1985), with scribe marks "S 178" visible on previously opened blaze.

A 18" white oak, bears N. 74° 45' W., 84.0 feet (rec. N.74°W., 84.48 ft. per Rase, 1916, and N.74°50'W., 84.5 ft. per Dean, 1985), with decayed face on a partially healed blaze.

And from which the following bearing trees marked by Tracy in 1969:

A 28" ponderosa pine stump, bears S. 78° E., 88.1 feet (rec. S.76 1/2 °E., 88.1 ft. per Tracy, 1969, and S.78° 00'E., 87.9 ft. per Dean, 1985), with healed blaze.

A 36" Douglas fir, bears S. 81° 30' W., 76.4 feet (rec. S.83°W., 77.2 ft. per Tracy, 1969, and S.81°30'W., 77.4 ft. per Dean, 1985), with healed blaze.

Description of monument and accessories I established to perpetuate the original location of this corner: October 29, 2001

I mark new accessories for the corner:

A steel fence post, bears S. 74° 30' E., 3.8 feet, projecting 3.5 feet above the ground, with Forest Service "Property Boundary" and "Land Survey Monument" signs attached.

An 8" Douglas fir, bears S. 52° 30' E., 29.8 feet, scribed "4-178 BT" on a single blaze with a 3/4" brass washer stamped "LS 2150" nailed to the face of the blaze.

A 6" diameter wood fence corner, bears N. 11° 15' W., 0.4 feet, projecting 4 feet above the ground, set in concrete.

Bearings are based on S. 74° 37' E. for the line between corners 4 and 3 per M98-20 and reported to the nearest 15 minutes. Tree measurements are to the center of the rootcrown. Tree diameters are at breast height.

Leonard E. Herzstein, P. O. Box 1008, Roseburg, Oregon 97470, for the Umpqua National Forest.

Witnesses: Chris Sturman, Katie Tobel

My certificate expires June 30, 2003

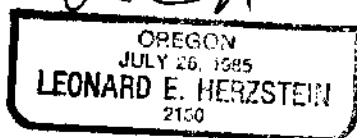
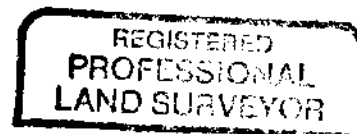

11/26/01

FILED

Date: 11-28-2001 By: JC

This survey consists of:

Map: _____

Narrative: _____

Corner Rpt: 65/40-9

**DOUGLAS COUNTY
SURVEYOR**

C.S. File No. 65/40-9