

FILED

Date: 8/2/2001 By: JP

This survey consists of:

Map: M138-46

Narrative: \_\_\_\_\_

Corner Rpt: C565/37-14 B

OREGON CORNER RESTORATION FORM

Section 8 Township 28 S Range 3W

County DOUGLAS Date 7-31-01

DOUGLAS COUNTY  
SURVEYOR

Corner Designation

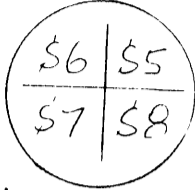

- Condition Report Only
- Not Found
- Renewed
- Unrecorded
- Surveyed In
- Referenced Out

Previous Renewals/Surveys, etc.

ORIGINAL BY GIBB IN 1910; PERPETUATED BY BYRON IN 1962  
(C.S. 52/126)

Monument(s) & Accessories Found: (Condition and Source)

FOUND BRASS CAP SET BY BYRON  
ALSO FOUND DOWN MAPLE N 23° E 18.8'

Monument Detail

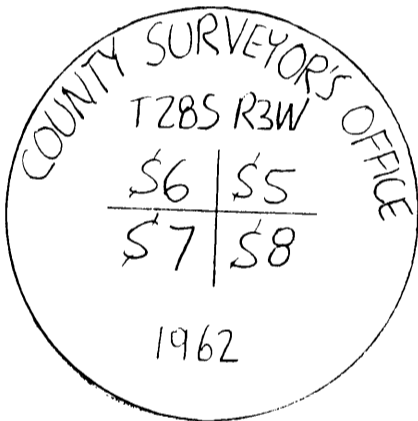

Sketch

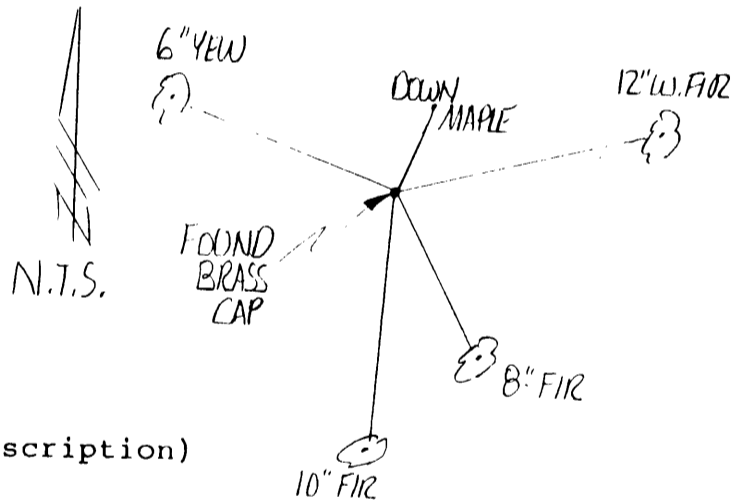

Monument Set (Procedures and Description)

N/A  
SET ALUMINUM POST BY CORNER MONUMENT

New Accessories

- \* 12" W. FIR BEARS N 81 1/4° E 124.0 FT. SCRIBED "T28SR3W S5" "BT"
  - \* 8" D. FIR BEARS S 15 3/4° E 75.2 FT. SCRIBED "T28S R3W S8" "BT"
  - \* 10" D. FIR BEARS S 0 3/4° W 132.9 FT. SCRIBED "T28S R3W S7" "BT"
  - \* 6" YEW BEARS N 74 3/4° W 83.2 FT. SCRIBED "T28S R3W S6" "BT"
- \* SET SPIKE IN THE BASE OF THE TREE & PLACED NEW TAG

Location & Comments

IN OPEN UNIT; APPROX. 950' N'LY OF MAIN GRAVEL ROAD ON NORTH SIDE OF SMALL RIDGE

Compass Declination N/A  
Firm/Agency MOUNTAIN TOP LAND SURVEYING  
Address 7550 WILLIS CR. RD. WINSTON, OREGON 97496  
Party Chief G. LANG  
Notes \_\_\_\_\_  
Witness T. LANG

Surveyor's Seal

