

FILED

Date: 8/2/2001 By: JD

This survey consists of:

Map: M138-46

Narrative: \_\_\_\_\_

Corner Rpt: CS 65/37-14 A

OREGON CORNER RESTORATION FORM

Section 8 Township 28S Range 3W

County DOUGLAS Date 7-31-01

DOUGLAS COUNTY SURVEYOR

Corner Designation

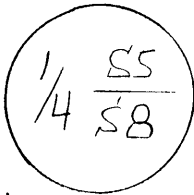

- Condition Report Only
- Not Found
- Renewed
- Unrecorded
- Surveyed In
- Referenced Out

Previous Renewals/Surveys, etc.

ORIGINAL BY GIBB IN 1910; PERPETUATED BY KEIR IN 1956 (C.S. 42/91);  
MONUMENTED WITH BRASS CAP BY BYRON IN 1962 (C.S. 52/126)

Monument(s) & Accessories Found: (Condition and Source)

FOUND BRASS CAP SET BY BYRON IN 1962

- \* ORIGINAL 1910 MAPLE NOW 21" DIAMETER BEARS N 10°W 3 LKS,
- KERR'S 1956 W. FIR NOW 20" DIAMETER " S 17 1/4°W 18.6'
- (WE SET A SPIKE IN THIS TREE BUT SCRATCHED OUR INFORMATION
- ON THE EXISTING BEARING TREE TAG)

ALSO FOUND A METAL "T" POST AT THE CORNER

Monument Detail

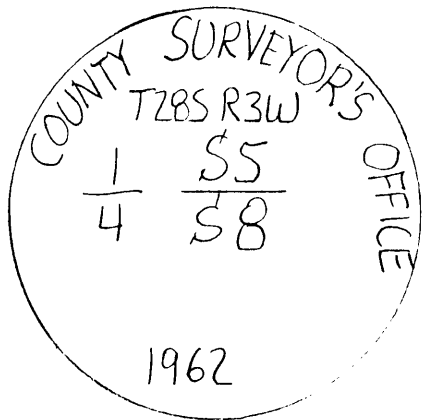

Sketch

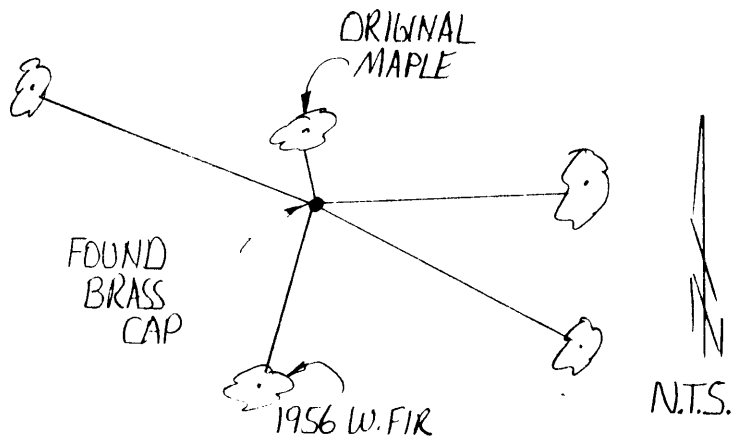

Monument Set (Procedures and Description)

N/A

New Accessories

- \* 7" HEMLOCK BEARS N 88 3/4°E 19.0 FT. SCRIBED "1/4 S5" "BT"
- \* 10" HEMLOCK BEARS S 70 1/2°E 24.3 FT. SCRIBED "1/4 S8" "BT"
- \* 6" HEMLOCK BEARS N 76 3/4°W 27.0 FT. SCRIBED "1/4 S5" "BT"

\* SET SPIKE IN THE BASE OF THE TREE & PLACED NEW TAG

Location & Comments

CORNER LIES ON A  
WESTERLY SLOPE LESS  
THAN 100' EAST OF A  
DRAINAGE; ALSO AT THE  
S. LY EDGE OF A LOGGED  
UNIT.

Compass Declination N/A  
 Firm/Agency MOUNTAIN TOP LAND SURVEYING  
 Address 7550 WILLIS CR. RD.  
WINSTON, OR. 97496  
 Party Chief G. LANG  
 Notes \_\_\_\_\_  
 Witness T. LANG

Surveyor's Seal

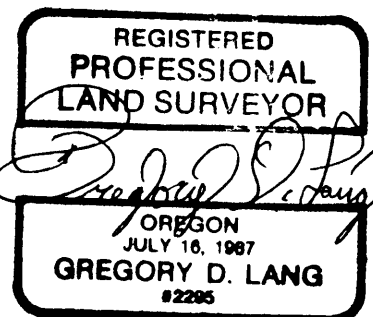

C.S. File No. 65/37-14A

EXPIRES 12-31-02

FILED

Date: 8/2/2001 By: JP

This survey consists of:

Map: M138-46

Narrative: \_\_\_\_\_

Corner Rpt: C565/37-14 B

OREGON CORNER RESTORATION FORM

Section 8 Township 28 S Range 3W

County DOUGLAS Date 7-31-01

DOUGLAS COUNTY  
SURVEYOR

Corner Designation

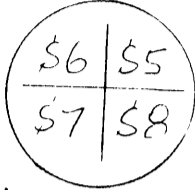

- Condition Report Only
- Not Found
- Renewed
- Unrecorded
- Surveyed In
- Referenced Out

Previous Renewals/Surveys, etc.

ORIGINAL BY GIBB IN 1910; PERPETUATED BY BYRON IN 1962  
(C.S. 52/126)

Monument(s) & Accessories Found: (Condition and Source)

FOUND BRASS CAP SET BY BYRON  
ALSO FOUND DOWN MAPLE N 23°E 18.8'

Monument Detail

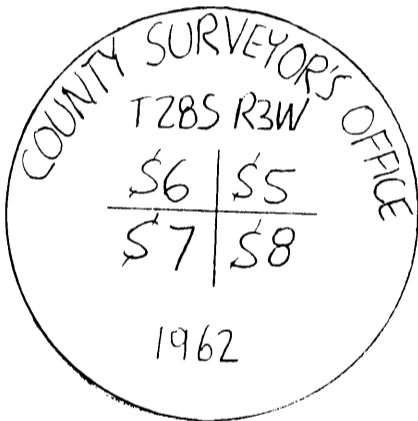

Sketch

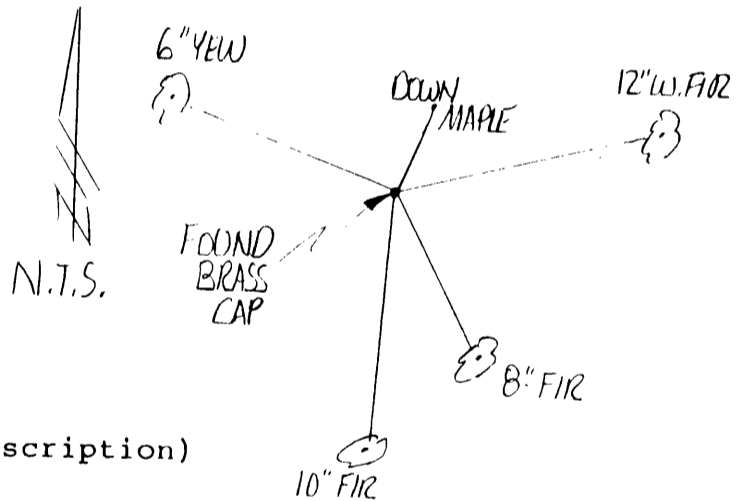

Monument Set (Procedures and Description)

N/A  
SET ALUMINUM POST BY CORNER MONUMENT

New Accessories

- \* 12" W. FIR BEARS N 81 1/4°E 124.0 FT. SCRIBED "T28SR3W S5" "BT"
  - \* 8" D. FIR BEARS S 15 3/4°E 75.2 FT. SCRIBED "T28S R3W S8" "BT"
  - \* 10" D. FIR BEARS S 0 3/4°W 132.9 FT. SCRIBED "T28S R3W S7" "BT"
  - \* 6" YEW BEARS N 74 3/4°W 83.2 FT. SCRIBED "T28S R3W S6" "BT"
- \* SET SPIKE IN THE BASE OF THE TREE & PLACED NEW TAG

Location & Comments

IN OPEN UNIT; APPROX. 950' N'LY OF MAIN GRAVEL ROAD ON NORTH SIDE OF SMALL RIDGE

Compass Declination N/A  
Firm/Agency MOUNTAIN TOP LAND SURVEYING  
Address 7550 WILLIS CR. RD. WINSTON, OREGON 97496  
Party Chief G. LANG  
Notes \_\_\_\_\_  
Witness T. LANG

Surveyor's Seal

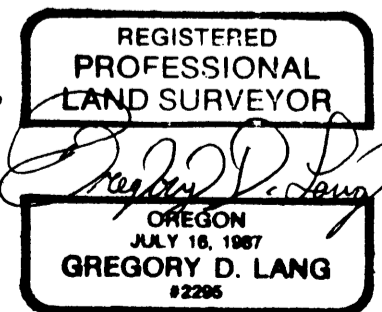

FILED

Date: 8/2/2004 By: JD

This survey consists of:

Map: M138-46

Narrative: \_\_\_\_\_

Corner Rpt: CS 65/37-14C

OREGON CORNER RESTORATION FORM

Section 8 Township 28 S Range 3W

County DOUGLAS Date 7-31-01

DOUGLAS COUNTY  
SURVEYOR

Corner Designation



- Condition Report Only
- Not Found
- Renewed
- Unrecorded
- Surveyed In
- Referenced Out

Previous Renewals/Surveys, etc.

ORIGINAL BY GIBB IN 1910

Monument(s) & Accessories Found: (Condition and Source)

FOUND ORIGINAL HEMLOCK BT (NOW 29") - GOOD FACE - WE CUT IN  
& FOUND SCRIBING APPROXIMATELY 6" FROM THE CORE OF THE TREE.  
"S8" & "4"

ORIGINAL CEDAR NOT FOUND

Monument Detail

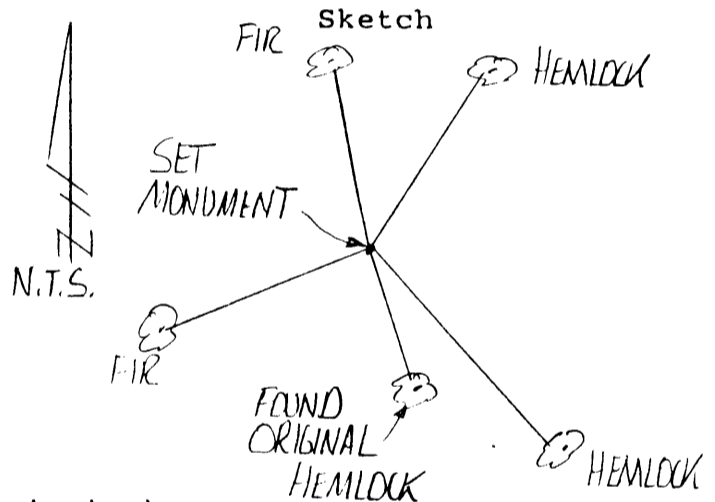
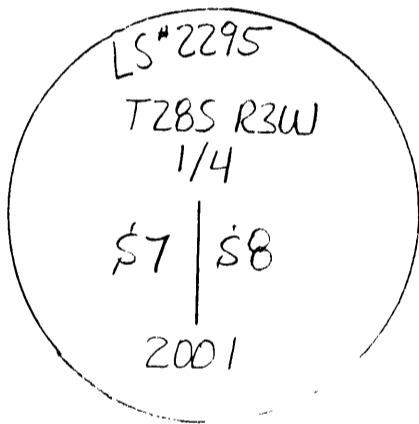

Monument Set (Procedures and Description)

SET 5/8" X 36" IRON ROD WITH A 2 1/2" ALUMINUM CAP

THIS MONUMENT WAS SET N 21° W 12.54 FEET OR 19 LKS.

(THE ORIGINAL RECORD BEARING & DISTANCE) FROM THE 1910 HEMLOCK  
DESCRIBED ABOVE.

ALSO SET AN ALUMINUM POST ALONGSIDE THE CORNER

New Accessories

\* 15 1/2" HEMLOCK BEARS N 35 1/2° E 51.0 FT. SCRIBED "1/4 S8" "BT"

\* 15 1/2" HEMLOCK BEARS S 48 3/4° E 46.4 FT. SCRIBED "1/4 S8" "BT"

\* 9 1/2" D. FIR BEARS S 60 1/4° W 33.5 FT. SCRIBED "1/4 S7" "BT"

\* 9 1/2" D. FIR BEARS N 17° W 44.5 FT. SCRIBED "1/4 S7" "BT"

\* SET SPIKE IN THE BASE OF THE TREE & PLACED NEW TAG.

Location & Comments

CORNER IS ON AN  
EASTERLY SLOPE

Compass Declination N/A

Firm/Agency MOUNTAINTOP LAND SURVEYING

Address 7550 WILLIS CR. RD.  
WINSTON, OREGON 97496

Party Chief G. LANG

Notes \_\_\_\_\_

Witness T. LANG

Surveyor's Seal

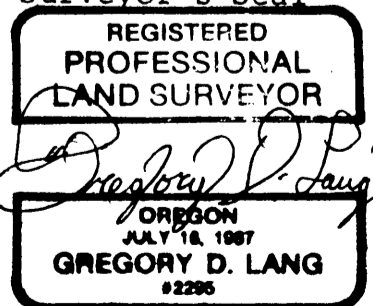

EXPIRES 12-31-02  
C.S. File No. 65/37-14C

FILED

Date: 8-2-01 By: JP

This survey consists of:

Map: M138-46

Narrative: \_\_\_\_\_

Corner Rpt: C565/37-14D

OREGON CORNER RESTORATION FORM

Section 8 Township 28S Range 3W

County DOUGLAS Date 7-31-01

DOUGLAS COUNTY SURVEYOR

Corner Designation

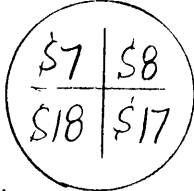

- Condition Report Only
- Not Found
- Renewed
- Unrecorded
- Surveyed In
- Referenced Out

Previous Renewals/Surveys, etc.

ORIGINAL BY GIBB IN 1910; PERPETUATED BY BYRON IN 1957 (C.S. 49122);  
ALSO PERPETUATED BY LANGUITZ IN 1975 (C.S. 57117); FD O.K. IN '93 (M119-11)

Monument(s) & Accessories Found: (Condition and Source)

FD. BYRON B. CAP; ALSO FD. ACCESSORIES ACCORDING TO THE 1975 RENEWAL  
BY LANGUITZ

Monument Detail

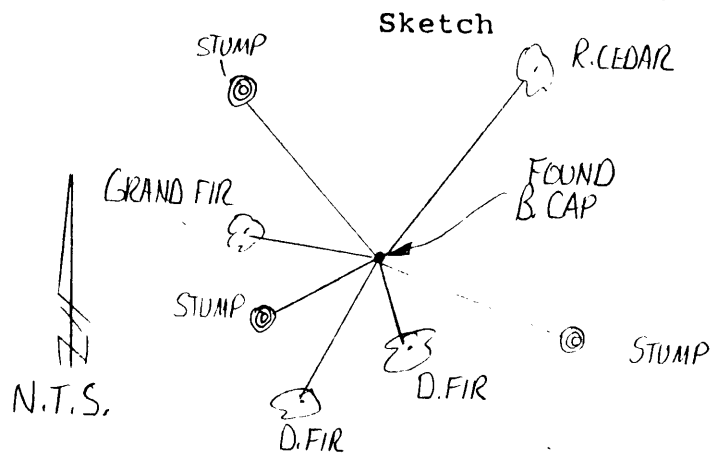
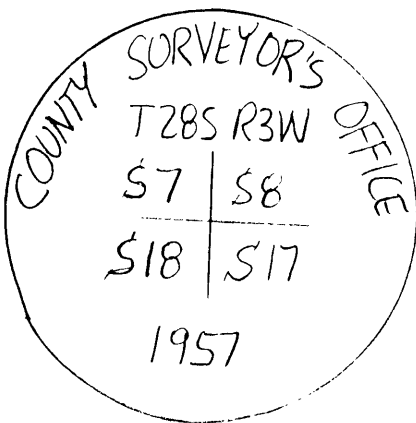

Monument Set (Procedures and Description)

N/A

SET ALUMINUM POST BY THE CORNER

New Accessories: NONE

I SET SPIKES IN THE FOLLOWING TREES:

29" CEDAR BEARS N 35 1/2° E 29.5 FT. (PLACED NEW TAG)

21 1/2" D. FIR BEARS S 11 1/2° E 5.4 FT.

18" D. FIR BEARS S 33 1/2° W 10.4 FT.

14" W. FIR BEARS N 84 3/4° W 12.4 FT. (PLACED NEW TAG)

Location & Comments

LESS THAN 100' N'LY

Compass Declination N/A

OF NORTH MYRTLE RD.

Firm/Agency \_\_\_\_\_

JUST BEFORE THE CURRENT

MOUNTAIN TOP LAND SURVEYING

END OF PAVEMENT,

Address 7550 WILLIS CR. RD.

WINSTON, OREGON 97496

Party Chief G. LANG

Notes \_\_\_\_\_

Witness T. LANG

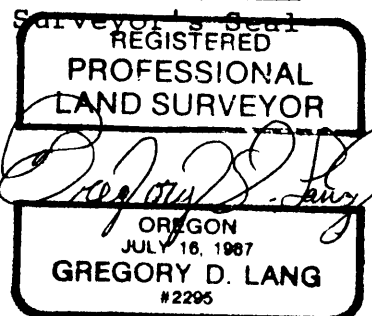

EXPIRES 12-31-02

C.S. File No. 65/37-14D

FILED

Date: 8-2-01 By: JP

This survey consists of:

Map: M 138-46

Narrative: \_\_\_\_\_

Corner Rpt: CS 65/37-14 E

OREGON CORNER RESTORATION FORM

Section 8 Township 28S Range 3W

County DOUGLAS Date 7-31-01

DOUGLAS COUNTY SURVEYOR

Corner Designation

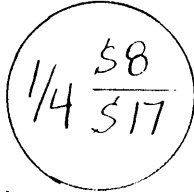

- Condition Report Only
- Not Found
- Renewed
- Unrecorded
- Surveyed In
- Referenced Out

Previous Renewals/Surveys, etc.

ORIGINAL BY GIBB IN 1910; PERPETUATED BY BYRON IN 1962  
(C.S. 52/126)

Monument(s) & Accessories Found: (Condition and Source)

FOUND B. CAP SET BY BYRON, LOOSE & LEANING, BUT STILL FIRMLY IN THE  
GROUND AT THE BASE. WE STRAIGHTEN & TIGHTEN; BUILD ROCK MOUND

\* THE ORIGINAL NE BT (NOW 14" HEMLOCK) BEARS N 13 1/4° E 5.6 FT.

ALSO FOUND BYRON'S SE B.T. - DOWN-ROOT HOLE MATCHES CAP POSITION

Monument Detail



Sketch

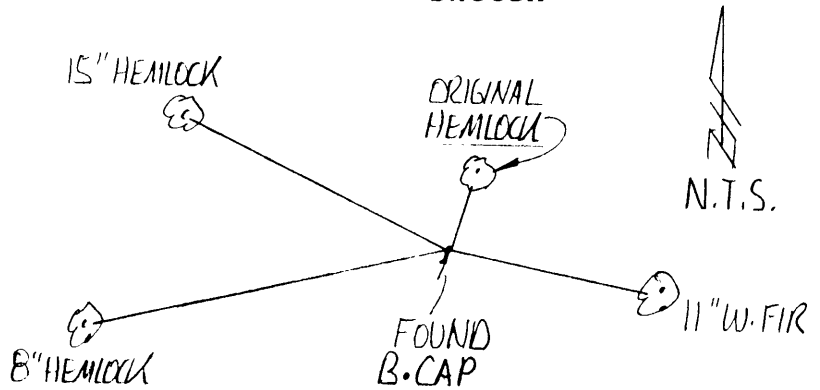

Monument Set (Procedures and Description)

N/A  
SET ALUMINUM POST ALONGSIDE THE CORNER

New Accessories

- \* 11" W. FIR BEARS S 81 1/4° E 14.8 FT. SCRIBED "1/4 S 17" BT"
- \* 8" HEMLOCK BEARS S 76° W 32.2 FT. SCRIBED "1/4 S 17" BT"
- \* 15" HEMLOCK BEARS N 58° W 24.8 FT. SCRIBED "1/4 S 8" BT"

\* SET SPIKE IN THE BASE OF THE TREE & PLACED NEW TAG

Location & Comments

CORNER LIES @ THE FOOT OF  
A NORTHWESTERLY SLOPE  
& APPROX. 30' WEST OF  
A SMALL CREEK.

Compass Declination N/A

Firm/Agency MOUNTAINTOP LAND SURVEYING

Address 7550 WILLIS CR. RD.  
WINSTON, OREGON 97496

Party Chief G. LANG

Notes \_\_\_\_\_

Witness T. LANG

Surveyor's Seal

