

FILED

Date: 5/8/2001 By: JP

This survey consists of:

Map: M 138-6

Narrative: \_\_\_\_\_

Corner Rpt: CS 65/37-5 A

OREGON CORNER RESTORATION FORM

Section 6 Township 25S Range 3W

County DOUGLAS Date 4-23-01

Corner Designation

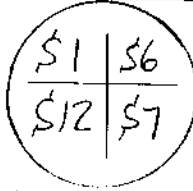

DOUGLAS COUNTY SURVEYOR

- Condition Report Only
- Not Found
- Renewed
- Unrecorded
- Surveyed In
- Referenced Out

Previous Renewals/Surveys, etc.

ORIGINAL BY GORDON & GARDENER IN 1855 - PROPORTIONED BY PRICE IN 1940; TRACY IN 1964 (C.S. 53/47); SMITH & FLOUSE IN 1998 (C.S. 64/79-9)

Monument(s) & Accessories Found: (Condition and Source)

<u>FOUND BRASS CAP</u>	
<u>26 1/2" FIR BEAMS N 64°E 99.0 FT.</u>	<u>PRICE</u>
<u>27 1/2" FIR BEAMS S 6 1/2°W 61.4 FT.</u>	<u>PRICE</u>
<u>26" FIR BEAMS S 55°E 21.9 FT.</u>	<u>TRACY</u>
<u>14" CEDAR BEAMS N 76°W 6.1 FT.</u>	<u>TRACY</u>

NOTE: THE ABOVE BEARINGS & DISTANCES ARE FROM THE RECORDS. TREE SIZES WERE MEASURED

Monument Detail

Sketch

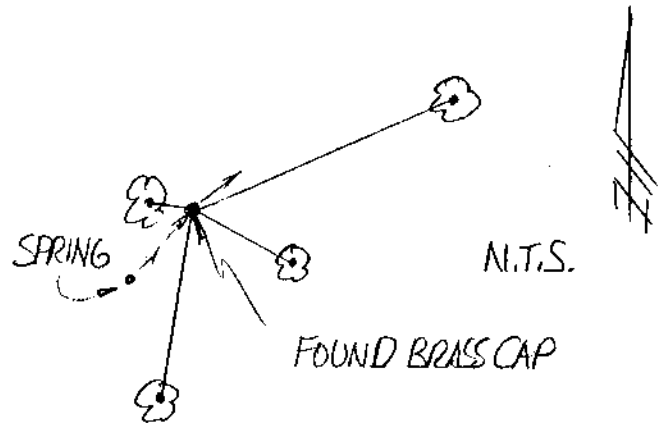
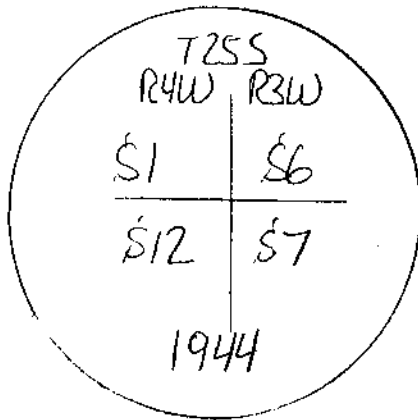

Monument Set (Procedures and Description)

N/A

New Accessories

SET ALUMINUM POST AT THE CORNER.  
PAINTED TREES

Location & Comments

IN DRAINAGE JUST BELOW SMALL SPRING

Compass Declination N/A

Firm/Agency \_\_\_\_\_

GREGORY D. LANG

Address 7550 WILLIS CR. RD.

WINSTON OREGON 97496

Party Chief G. LANG

Notes \_\_\_\_\_

Witness T. LANG

Surveyor's Seal

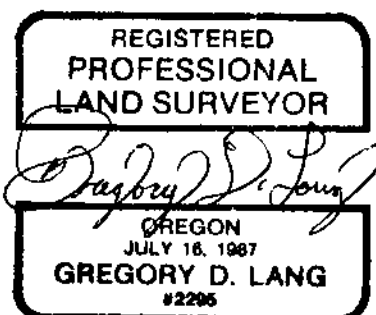

EXPIRES 12-31-02

C.S. File No. 65/37-5A

FILED

Date: 5/8/2001 By: JP  
This survey consists of:  
Map: M138-6  
Narrative: \_\_\_\_\_  
Corner Rpt: 65/37-5B

OREGON CORNER RESTORATION FORM

Section 6 Township 25S Range 3W  
County DOUGLAS Date 4-23-01

DOUGLAS COUNTY  
SURVEYOR

Corner Designation



- Condition Report Only
- Not Found
- Renewed
- Unrecorded
- Surveyed In
- Referenced Out

Previous Renewals/Surveys, etc.

ORIGINAL BY GORDON & GARDNER IN 1855; PROPORTIONED BY PRICE IN 1940; TRACY IN 1964 (C.S. 53/47); SMITH & FLAUSE IN 1998 (C.S. 64/79-34).

Monument(s) & Accessories Found: (Condition and Source)

FOUND BRASS CAP		
21" FIR BEANS S41°W	141.9 FT.	PRICE
16 1/2" FIR BEANS N36°W	19.9 FT.	TRACY
13" CEDAR BEANS N54°E	27.0 FT.	SMITH & FLAUSE
22" FIR BEANS S66°E	44.7 FT.	SMITH & FLAUSE
13" DEAD MADRONE BEANS S44°E	85.2 FT.	PRICE

NOTE: THE ABOVE READINGS & DISTANCES ARE FROM THE MOST RECENT RECORDS. TREE SIZES WERE MEASURED

Monument Detail

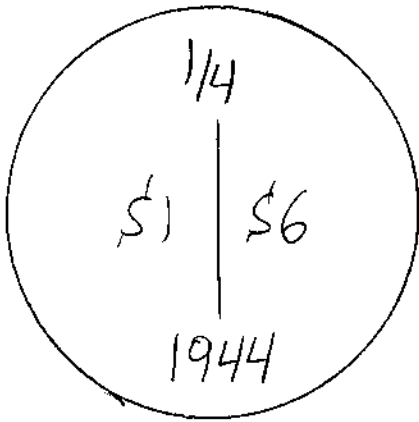

Sketch

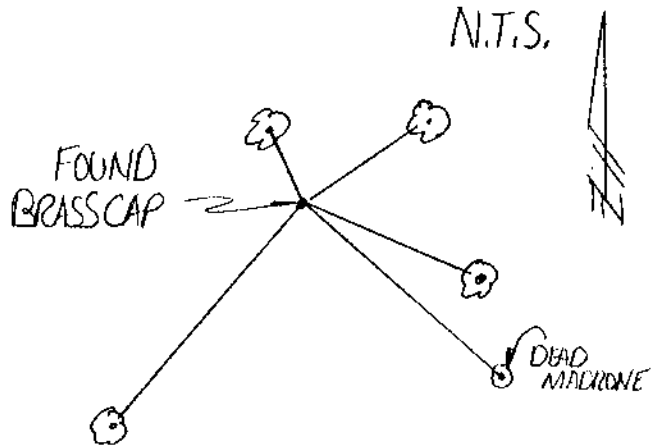

Monument Set (Procedures and Description)

N/A

New Accessories

SET ALUMINUM POST AT CORNER  
PAINTED TREES

Location & Comments

AT BASE OF WEST  
SLOPE & EAST OF  
CALAPOOIA CREEK.

Compass Declination N/A

Firm/Agency \_\_\_\_\_

GREGORY D. LANG

Address 7550 WILLIS CR. RD.

WINSTON, OREGON 97496

Party Chief G. LANG

Notes \_\_\_\_\_

Witness T. LANG

Surveyor's Seal

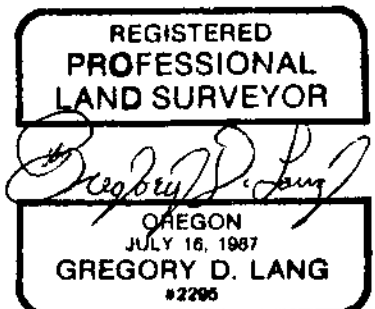

EXPIRES 12-31-02

C.S. File No. 65/37-5B

FILED

Date: 5/8/2001 By: JP

This survey consists of:

Map: M 138-6

Narrative: \_\_\_\_\_

Corner Rpt: CS 65/37-5C

OREGON CORNER RESTORATION FORM

Section 6 Township 25S Range 3W

County DOUGLAS Date 4-23-01

Corner Designation

TOWNSHIP  
CORNER

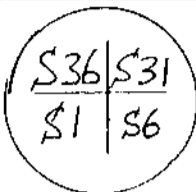

DOUGLAS COUNTY

- SURVEYOR**
- Condition Report Only
  - Not Found
  - Renewed
  - Unrecorded
  - Surveyed In
  - Referenced Out

Previous Renewals/Surveys, etc.

ORIGINAL BY GORDON & GARDINER IN 1855; PRICE IN 1940;  
GODFREY IN 1963 (CS. 53/9)

Monument(s) & Accessories Found: (Condition and Source)

FOUND BRASS CAP  
\* 24" FIR BEARS S 81° W 35.45 FT. GODFREY  
(NW, NE, & SE BT'S NOTED IN THE 1963 RENEWALS ARE NOW STUMPS.)

Monument Detail

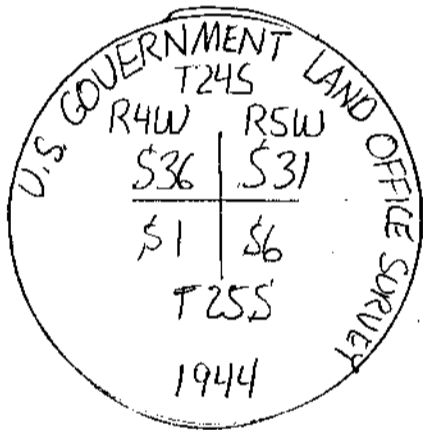

Sketch

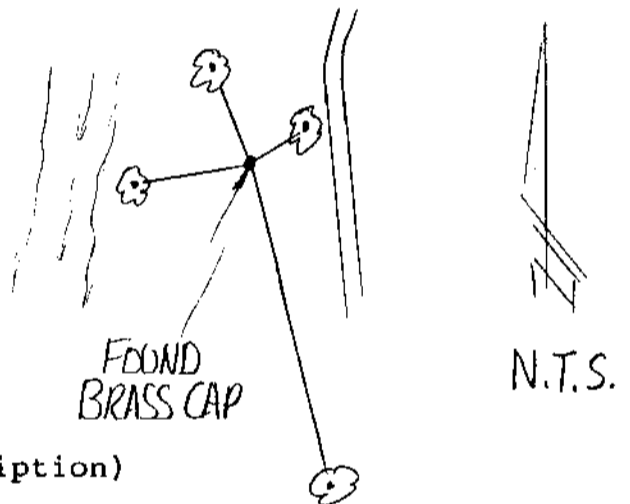

Monument Set (Procedures and Description)

N/A

New Accessories

- \* 13" FIR BEARS N 55° E 19.5 FT. SCRIBED "T24S R3W S31" "BT"
- \* 12" FIR BEARS S 9° E 156.5 FT. SCRIBED "T25S R3W S6" "BT"
- \* 18" CEDAR BEARS N 28° W 23.45 FT. SCRIBED "T24S R4W S36" "BT"
- SET ALUMINUM POST AT CORNER
- \* SET SPIKE IN THE BASE OF THE TREE & PLACED NEW TAG

Location & Comments

LIES EASTERLY OF  
CALAPOOIA CREEK  
BETWEEN THE CREEK &  
THE OLD RR. BED

Compass Declination N/A  
 Firm/Agency \_\_\_\_\_  
GREGORY D. LANG  
 Address 7550 WILLIS CR. RD,  
WINSTON, OR. 97496  
 Party Chief G. LANG  
 Notes \_\_\_\_\_  
 Witness T. LANG

Surveyor's Seal

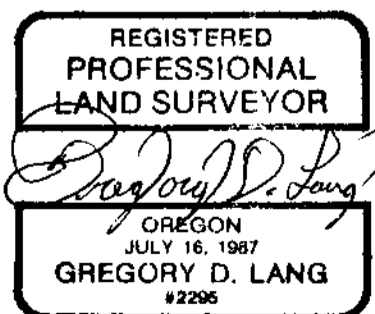

EXPIRES 12-31-02  
C.S. File No. 65/37-5C

FILED

Date: 5/3/2001 By: JP

This survey consists of:

Map: M138-6

Narrative: \_\_\_\_\_

Corner Fpt: CS 65/37-50

OREGON CORNER RESTORATION FORM

Section 6 Township 25S Range 3W

County DOUGLAS Date 4-18-01

DOUGLAS COUNTY SURVEYOR

Corner Designation

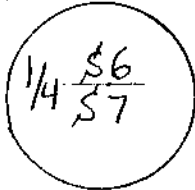

- Condition Report Only
- Not Found
- Renewed
- Unrecorded
- Surveyed In
- Referenced Out

Previous Renewals/Surveys, etc.

ORIGINAL BY SITRELL IN 1867; WHEELER IN 1883; PRICE IN 1940;  
TRACY IN 1966 (CS. 54/27); TRACY IN 1968 (CS. 54/27)

Monument(s) & Accessories Found: (Condition and Source)

FOUND BRASS CAP		
3 1/2" FIR BEAMS	S 81 1/2° W	9 9/16 FT. SITRELL
* 4 9/16" FIR BEAMS	S 23° W	28 8/16 FT. PRICE
* 31" CEDAR BEAMS	N 28 3/4° W	45 8/16 FT. TRACY

Monument Detail

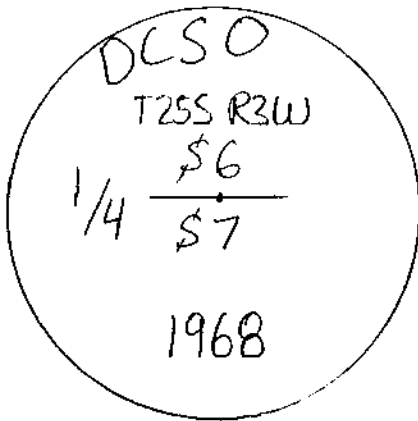

Sketch

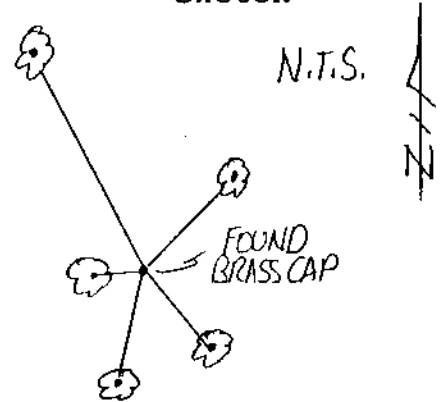

Monument Set (Procedures and Description)

N/A

New Accessories

- \* 2 1/2" CEDAR BEAMS N 46 1/2° E 28 6/16 FT. SCRIBED "1/4 S6" "BT"
- \* 1 5/16" CEDAR BEAMS S 38° E 21 2/16 FT. SCRIBED "1/4 S7" "BT"

- \* SET SPIKE IN THE BASE OF THE TREE & PLACED NEW TAG
- SET ALUMINUM POST AT CORNER

Location & Comments

ON SW SLOPE

Compass Declination N/A

Firm/Agency \_\_\_\_\_

GREGORY D. LANG

Address 7550 WILLIS CR. RD.

WINSTON, OR. 97496

Party Chief G. LANG

Notes \_\_\_\_\_

Witness T. LANG

Surveyor's Seal

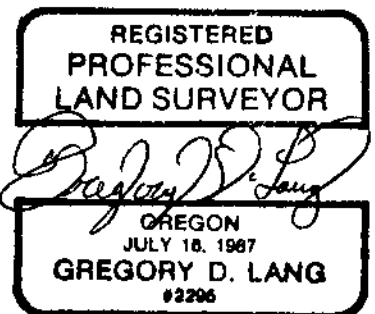

FILED

Date: 5/8/2001 By: JP

This survey consists of:

Map: M 138-6

Narrative: \_\_\_\_\_

Corner Rpt: CS 65/37-5 E

OREGON CORNER RESTORATION FORM

Section 6 Township 25 S Range 3 W

County DOUGLAS Date 4-18-01

DOUGLAS COUNTY  
SURVEYOR

Corner Designation

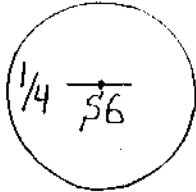

- Condition Report Only
- Not Found
- Renewed
- Unrecorded
- Surveyed In
- Referenced Out

Previous Renewals/Surveys, etc.

ORIGINAL BY SITTRELL IN 1867; BYRNS IN 1871; PRICE IN 1940; BYRON IN 1955.  
(CS 46/94); JENN IN 1958; TRACY IN 1966 (CS 54/27)

Monument(s) & Accessories Found: (Condition and Source)

FOUND BRASS CAP

<u>ORIGINAL FIR STUMP BEARS</u>	<u>S 5 1/4° E</u>	<u>48 ± FT.</u>	<u>SITTRELL</u>
<u>* 30" FIR BEARS</u>	<u>S 72 1/2° E</u>	<u>16 0 FT.</u>	<u>PRICE</u>
<u>* 15" FIR BEARS</u>	<u>S 27° W</u>	<u>27 0 FT.</u>	<u>BYRON</u>

Monument Detail

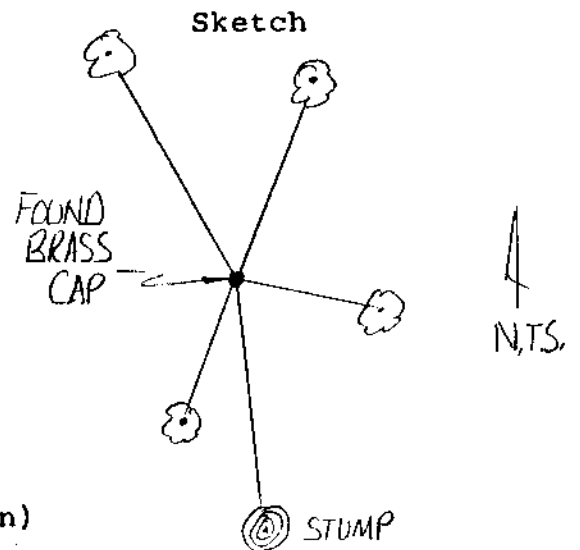
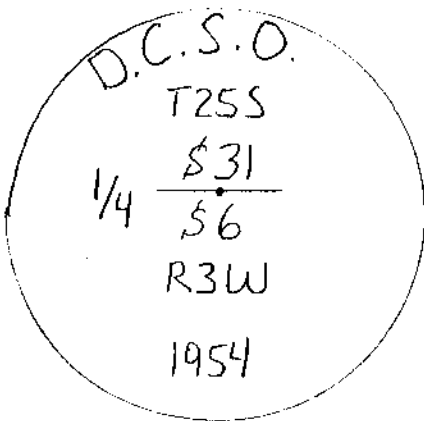

Monument Set (Procedures and Description)

N/A

New Accessories

\* 15" D. FIR BEARS N 35 1/2° E 31 7' SCRIBED "1/4 S6 ONLY" "BT"

\* 10" D. FIR BEARS N 35 1/2° W 42 3' SCRIBED "1/4 S6 ONLY" "BT"

SET ALUMINUM POST AT CORNER

\* SET SPIKE IN THE BASE OF THE TREE & PLACED NEW TAG

Location & Comments

ON RIDGE & APPROX. 8'  
NORTHERLY OF EAST-WEST  
FENCE

Compass Declination N/A

Firm/Agency GREGORY D. LANG

Address 7550 WILLIS CR. RD.  
WINSTON, OREGON 97496

Party Chief G. LANG

Notes \_\_\_\_\_

Witness T. LANG

Surveyor's Seal

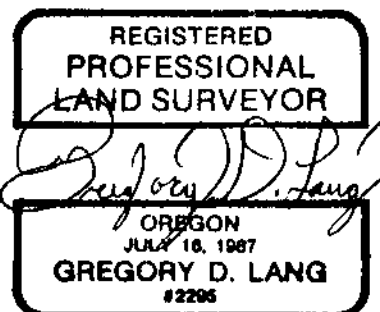

FILED

Date: 5/8/2001 By: JP

This survey consists of:

Map: M 138-6

Narrative: \_\_\_\_\_

Corner Rpt: CS 65/37-5 F

OREGON CORNER RESTORATION FORM

Section 31 Township 24 S Range 3 W

County DOUGLAS Date 4-18-01

DOUGLAS COUNTY SURVEYOR

Corner Designation

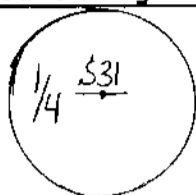

- Condition Report Only
- Not Found
- Renewed
- Unrecorded
- Surveyed In
- Referenced Out

Previous Renewals/Surveys, etc.

ORIGINAL BY BYARS IN 1871; PRICE IN 1940; BYRON IN 1955 (CS 46/94);  
GLENN IN 1958; TRACY IN 1966

Monument(s) & Accessories Found: (Condition and Source)

- \* 14" D. FIR BEARS N 65 3/4° E 26 9/16 FT. GLENN
- \* 26" D. FIR BEARS S 43° E 37 1/16 FT. BYARS
- \* 30" D. FIR BEARS N 85 1/2° W 56 1/16 FT. BYRON

FOUND BRASS CAP

Monument Detail

Sketch

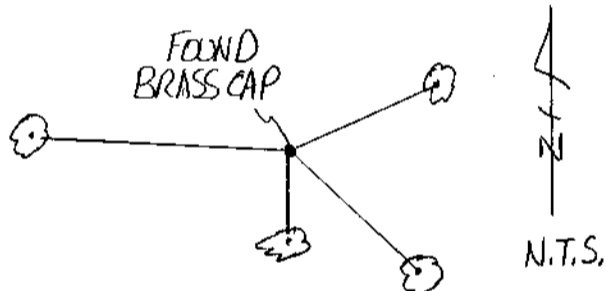
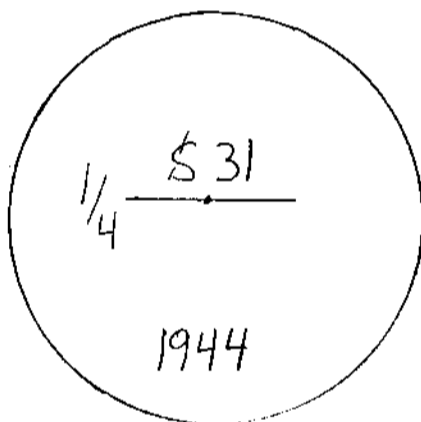

Monument Set (Procedures and Description)

N/A

New Accessories

- \* 14 1/2" D. FIR BEARS S 2 1/2° W 7 7/16 FT. SCRIBED "1/4 S 31 ONLY" BT
- \* SET SPIKE IN THE BASE OF THE TREE & PLACED NEW TAG
- \* SET ALUMINUM POST AT CORNER

Location & Comments

ON RIDGE AT FENCE CORNER.

Compass Declination N/A

Firm/Agency \_\_\_\_\_

GREGORY D. LANG

Address 7550 WILLIS CR. RD.

WINSTON, OR. 97496

Party Chief G. LANG

Notes \_\_\_\_\_

Witness T. LANG

Surveyor's Seal

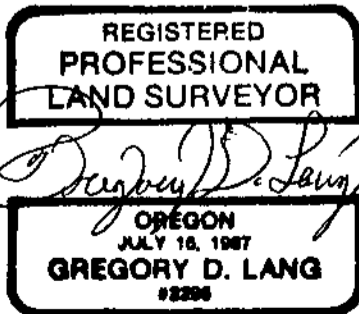

FILED

Date: 5/8/2001 By: JP

This survey consists of:

Map: M138-6

Narrative: \_\_\_\_\_

Corner Rpt: CS 65/37-56

OREGON CORNER RESTORATION FORM

Section 6 Township 25S Range 3W

County DOUGLAS Date 4-23-01

Corner Designation

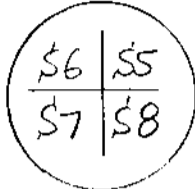

DOUGLAS COUNTY SURVEYOR

- Condition Report Only
- Not Found
- Renewed
- Unrecorded
- Surveyed In
- Referenced Out

Previous Renewals/Surveys, etc.

ORIGINAL BY WHEELER IN 1883; PRICE IN 1940; TRACY IN 1966  
(C.S. 54/27)

Monument(s) & Accessories Found: (Condition and Source)

FOUND BRASS CAP

* 30 1/2" FIR BEAMS S 84 1/4° E	54.9 FT.	TRACY
* 32" FIR BEAMS S 72 1/2° W	10.7 FT.	WHEELER
* 26" FIR BEAMS S 57 1/2° W	49.0 FT.	TRACY

Monument Detail

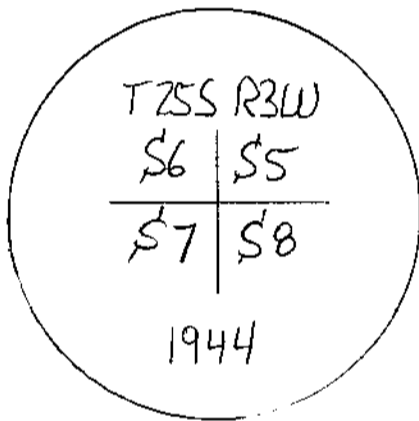

Sketch

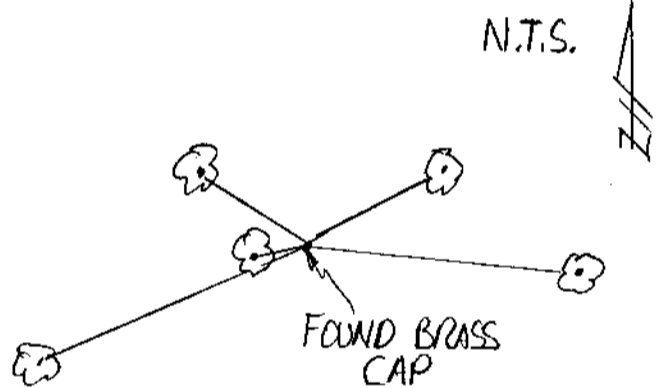

Monument Set (Procedures and Description)

N/A

New Accessories

\* 9 1/2" FIR BEAMS N 65 1/2° E 32.6 FT. SCRIBED "T25S R3W S5" "BT"

\* 8 1/2" FIR BEAMS N 59° W 27.7 FT. SCRIBED "T25S R3W S6" "BT"

SET ALUMINUM POST AT CORNER

\* SET SPIKE IN THE BASE OF THE TREE & PLACED NEW TAG

Location & Comments

CORNER IS ON STEEP  
SE SLOPE APPROX.  
200 FT. EASTERLY OF  
RIDGE ROAD

Compass Declination N/A

Firm/Agency \_\_\_\_\_

GREGORY D. LANG

Address 7550 WILLIS CR. RD.  
WINSTON, OREGON 97496

Party Chief G. LANG

Notes \_\_\_\_\_

Witness T. LANG

Surveyor's Seal

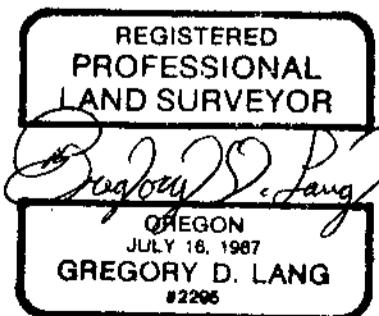

EXPIRES 12-31-02

C.S. File No. 65/37-56

FILED

Date: 5/8/2001 By: JP

This survey consists of:

Map: M 138-6

Narrative: \_\_\_\_\_

Corner Rpt: CS 65/37-5H

OREGON CORNER RESTORATION FORM

Section 6 Township 25S Range 3W

County DOUGLAS Date 4-23-01

Corner Designation



DOUGLAS COUNTY SURVEYOR

- Condition Report Only
- Not Found
- Renewed
- Unrecorded
- Surveyed In
- Referenced Out

Previous Renewals/Surveys, etc.

ORIGINAL BY WHEELER IN 1883; PROPORTIONED BY PRICE IN 1940;  
TRACY FOUND PRICE CORNER IN 1966 (CS 54127); BRYAN SEIBOLD IN 1996

Monument(s) & Accessories Found: (Condition and Source)

FOUND BRASS CAP

<u>* 18 1/2" FIR BEARS</u>	<u>N 9 1/4° E</u>	<u>11.5 FT.</u>	<u>PRICE</u>
<u>* 28" D. FIR BEARS</u>	<u>N 47° W</u>	<u>34.2 FT.</u>	<u>PRICE</u>
<u>* 12 1/2" HEMLOCK BEARS</u>	<u>N 37 1/4° E</u>	<u>20.9 FT.</u>	<u>TRACY</u>

Monument Detail

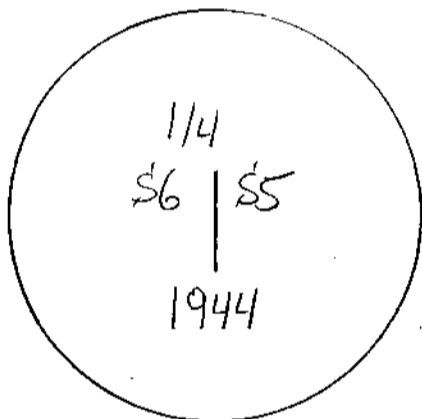

Sketch

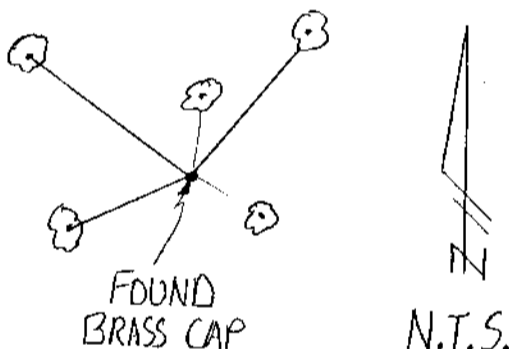

Monument Set (Procedures and Description)

N/A

New Accessories

- \* 11" HEMLOCK BEARS S 55 1/2° W 24.9 FT. SCRIBED "1/4 S6" "BT"
- \* 12 1/2" FIR BEARS S 58° E 11.0 FT. SCRIBED "1/4 S5" "BT"
- SET ALUMINUM POST AT CORNER

\* SET SPIKE IN THE BASE OF THE TREE & PLACED NEW TAG

Location & Comments

CORNER IS NEAR A  
DRAINAGE & ON A SF  
SLOPE APPROX. 230'  
SOUTH OF SPUR RIDGE

Compass Declination N/A  
Firm/Agency \_\_\_\_\_  
GREGORY D. LANG  
Address 7550 WILLIS CR. RD.  
WINSTON, OREGON 97496  
Party Chief G. LANG  
Notes \_\_\_\_\_  
Witness T. LANG

Surveyor's Seal

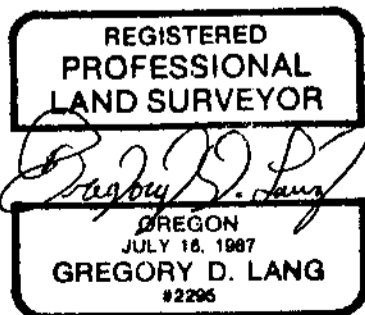

C.S. File No. 65/37-5H

EXPIRES 12-31-02

FILED

Date: 5/8/2001 By: JP

This survey consists of:

Map: M 130-6

Narrative: \_\_\_\_\_

Corner Rpt: CS 65/37-5 I

OREGON CORNER RESTORATION FORM

Section 6 Township 25 S Range 3W

County DOUGLAS Date 4-18-01

DOUGLAS COUNTY  
SURVEYOR

Corner Designation

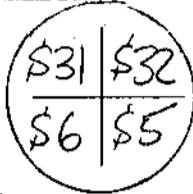

- Condition Report Only
- Not Found
- Renewed
- Unrecorded
- Surveyed In
- Referenced Out

Previous Renewals/Surveys, etc.

ORIGINAL BY BYARDS IN 1871; WEAHER IN 1884; PRICE IN 1940

Monument(s) & Accessories Found: (Condition and Source)

Monument(s) & Accessories Found	Condition	Source
<u>FOUND BRASS CAP</u>	<u>I STRAIGHTENED IT</u>	
<u>* 22" HEMLOCK BEAMS S 42 3/4° W</u>	<u>13 1/2 FT.</u>	<u>PRICE</u>
<u>* 18 1/2" D. FIR BEAMS S 34° E</u>	<u>13 1/2 FT.</u>	<u>PRICE</u>
<u>* 14" D. FIR BEAMS N 24 1/2° E</u>	<u>13 1/2 FT.</u>	<u>PRICE</u>

Monument Detail

Sketch

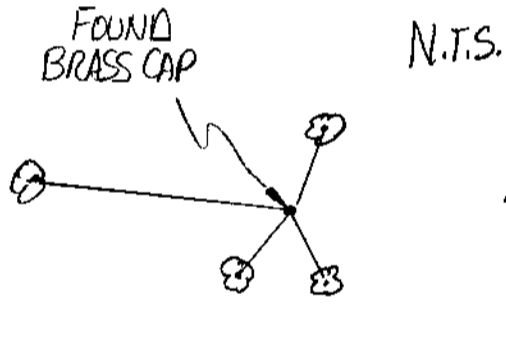
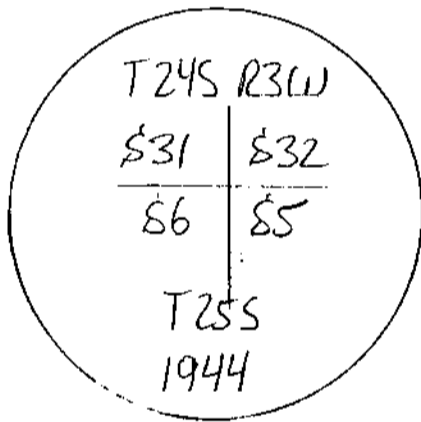

Monument Set (Procedures and Description)

N/A

New Accessories

\* 15" D. FIR BEAMS N 82 1/4° W 42° FT. SCRIBED "T 24S R 3W S 31" "BT"  
SET ALUMINUM POST AT CORNER

\* SET SPIKE IN THE BASE OF THE TREE & PLACED NEW TAB.

Location & Comments

Surveyor's Seal

Compass Declination N/A

Firm/Agency GREGORY D. LANG

Address 7550 WILLIS CR. RD.  
WINSTON, OR. 97496

Party Chief G. LANG

Notes \_\_\_\_\_

Witness T. LANG

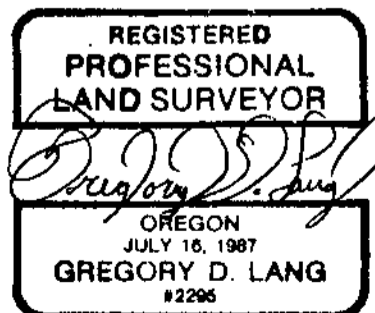

C.S. File No. 65/37-51 EXPIRES 12-31-02

FILED

Date: 5/8/2001 By: JP

This survey consists of:

Map: M 138-6

Narrative: \_\_\_\_\_

Corner Rpt: CS 65/37-5 J

OREGON CORNER RESTORATION FORM

Section 6 Township 25S Range 3W

County DOUGLAS <sup>31</sup> <sub>24</sub> Date 4-18-01

DOUGLAS COUNTY SURVEYOR

Corner Designation

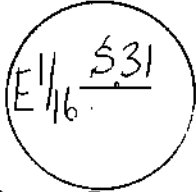

- Condition Report Only
- Not Found
- Renewed
- Unrecorded
- Surveyed In
- Referenced Out

Previous Renewals/Surveys, etc. \_\_\_\_\_

SET BY GLENN IN 1958

Monument(s) & Accessories Found: (Condition and Source)

FOUND BRASS CAP

\* 28 1/2" FIR BEAMS N 0 1/4° E 66 6 GLENN

\* 19" HEMLOCK BEAMS N 73 3/4° W 91 8 GLENN

Monument Detail

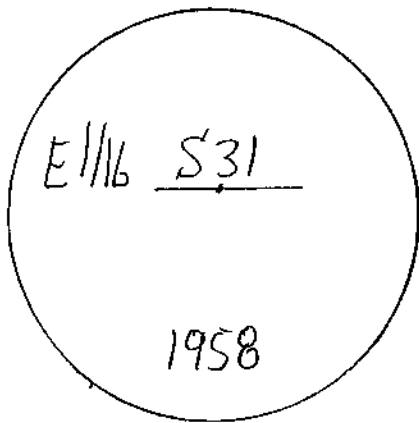

Sketch

N.T.S.

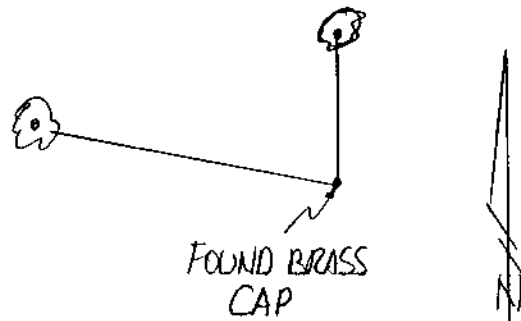

Monument Set (Procedures and Description)

N/A

New Accessories

\* SET SPIKE IN THE BASE OF THE TREE & PLACED NEW TAG.

SET ALUMINUM POST AT THE CORNER

Location & Comments

ON NW SLOPE, WEST OF RIDGETOP

Compass Declination N/A

Firm/Agency \_\_\_\_\_

GREGORY D. LANG

Address 7550 WILLIS CR. RD.

WINSTON, OREGON 97496

Party Chief G. LANG

Notes \_\_\_\_\_

Witness T. LANG

Surveyor's Seal

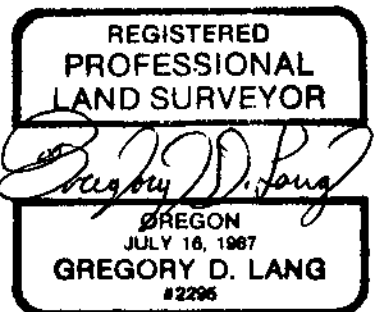

C.S. File No. 65/37-5 J EXPIRES 12-31-02

FILED

Date: 5/8/2001 By: JP

This survey consists of:

Map: M 138-6

Narrative: \_\_\_\_\_

Corner Rpt: CS 65/37-5K

OREGON CORNER RESTORATION FORM

Section 6 Township 25S Range 3W

County DOUGLAS Date 4-24-01

Corner Designation



DOUGLAS COUNTY SURVEYOR

- Condition Report Only
- Not Found
- Renewed
- Unrecorded
- Surveyed In
- Referenced Out

Previous Renewals/Surveys, etc. \_\_\_\_\_

N/A

Monument(s) & Accessories Found: (Condition and Source)

N/A

Monument Detail

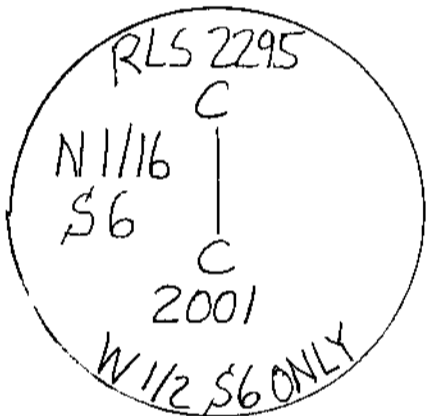

Sketch

N.T.S.

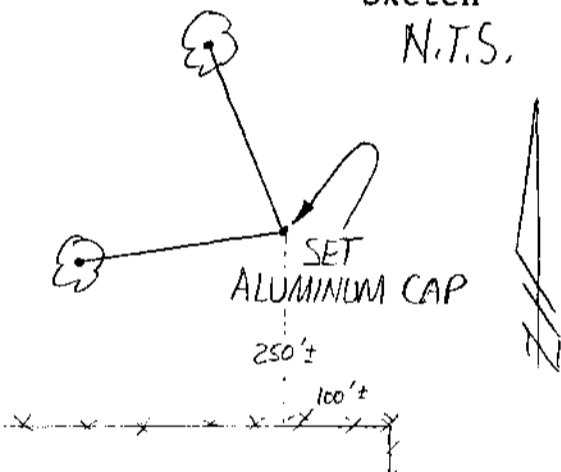

Monument Set (Procedures and Description)

SET 5/8" x 36" IRON ROD WITH 2 1/2" ALUMINUM CAP  
ALSO SET ALUMINUM POST @ CORNER

New Accessories

- \* 14" FIR BEARS S 73 1/2° W 22.0 FT. SCRIBED "CN 1/16 S6" "BT"
- \* 16 1/2" FIR BEARS N 73 1/4° W 28.8 FT. SCRIBED "CN 1/16 S6" "BT"
- \* SET SPIKE IN THE BASE OF THE TREE & PLACED BT TAG

Location & Comments

APPROX. 100' WESTERLY  
& 250' NORTHERLY  
OF THE CURRENT  
FENCE CORNER.

BEARINGS TO BE'S  
ARE RELATIVE TO MAP  
BEARINGS.

Compass Declination N/A

Firm/Agency \_\_\_\_\_

Address 7550 WILLIS CR. RD.  
WINSTON, OR. 97496

Party Chief G. LANG

Notes \_\_\_\_\_

Witness T. LANG

Surveyor's Seal



FILED

Date: 5/8/2001 By: JP

This survey consists of:

Map: M 138-6

Narrative: \_\_\_\_\_

Corner Rpt: CS 65/37-5 L

OREGON CORNER RESTORATION FORM

Section 6 Township 25S Range 3W

County DOUGLAS Date 4-24-01

Corner Designation



DOUGLAS COUNTY SURVEYOR

- Condition Report Only
- Not Found
- Renewed
- Unrecorded
- Surveyed In
- Referenced Out

Previous Renewals/Surveys, etc. \_\_\_\_\_

N/A

Monument(s) & Accessories Found: (Condition and Source)

N/A

Monument Detail

Sketch

N.T.S.

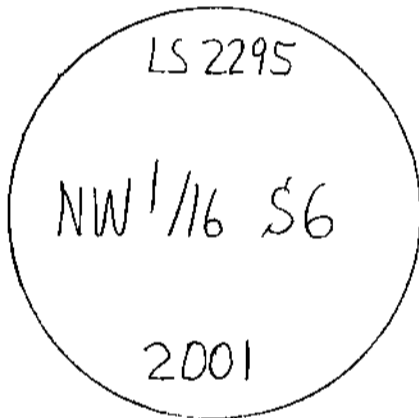

SET ALUMINUM CAP

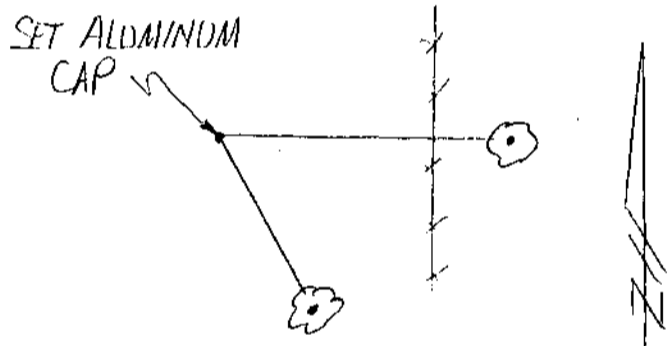

Monument Set (Procedures and Description)

SET 5/8" x 36" IRON ROD WITH 2 1/2" ALUMINUM CAP  
ALSO SET ALUMINUM POST @ CORNER

New Accessories

- \* 13" FIR BEAMS S 88 3/4° E 68.80' SCRIBED "NW 1/16 S6" "BT"
- \* 9 1/2" FIR BEAMS S 30 1/2° E 35.00' SCRIBED "NW 1/16 S6" "BT"
- \* SET SPIKE IN THE BASE OF THE TREE & PLACED BT TAG

Location & Comments

ON NW SLOPE  
APPROX. 50' WEST  
OF CURRENT FENCE LINE.

Compass Declination N/A

Firm/Agency \_\_\_\_\_

GREGORY D. LANG

Address 7550 WILLIS CR. RD.

WINSTON, OR. 97496

Party Chief G. LANG

Notes \_\_\_\_\_

Witness T. LANG

BEARINGS TO BT'S  
ARE RELATIVE TO MAP  
BEARINGS.

Surveyor's Seal

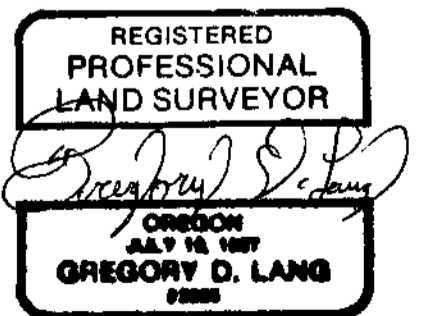

C.S. File No. 65/37-5L EXPIRES 12-31-02

FILED

Date: 5/8/2001 By: SP

This survey consists of:

Map: M138-6

Narrative: \_\_\_\_\_

Corner Rpt: CS 65/37-5M

OREGON CORNER RESTORATION FORM

Section 31 Township 24S Range 3W

County DOUGLAS Date 4-24-01

Corner Designation

W 1/16  
S 31 ONLY

DOUGLAS COUNTY SURVEYOR

- Condition Report Only
- Not Found
- Renewed
- Unrecorded
- Surveyed In
- Referenced Out

Previous Renewals/Surveys, etc.

SET BY VICTOR MCLIND IN MAY 1971 (C.S. 55/195-2)

Monument(s) & Accessories Found: (Condition and Source)

FD 5/8" IR ; NO BT'S MCLIND

Monument Detail

N/A

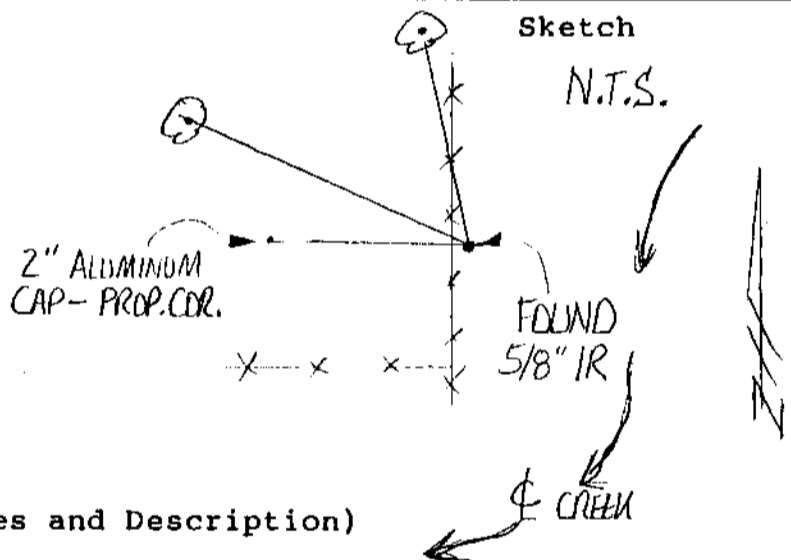

Monument Set (Procedures and Description)

N/A

New Accessories

- \* 13 1/2" FIR BEAMS N 52°W 72.5 FT. SCRIBED "W 1/16 S 31 ONLY" "BT"
- \* 10 1/2" CEDAR BEAMS N 16 3/4°W 69.6 FT. SCRIBED "W 1/16 S 31 ONLY" "BT"
- \* SET SPIKE IN THE BASE OF THE TREE & PLACED BT TAB.
- \* SET ALUMINUM POST AT FOUND IRON ROD

Location & Comments

APPROX. 50' WESTERLY  
OF CALAPOOIA CREEK &  
4" EASTERLY OF N-S  
FENCE

BEARINGS TO B.T.'S  
ARE RELATIVE TO MAP  
BEARINGS.

Compass Declination N/A

Firm/Agency GREGORY D. LANG

Address 7550 WILLIS CR. RD.  
WINSTON, OREGON 97496

Party Chief G. LANG

Notes \_\_\_\_\_

Witness T. LANG

Surveyor's Seal



C.S. File No. 65/37-5M EXPIRES 12-31-02

FILED

Date: 5/8/2001 By: JP

This survey consists of:

Map: M 138-6

Narrative: \_\_\_\_\_

Corner Rpt: 65/37-5 N

OREGON CORNER RESTORATION FORM

Section 6 Township 25S Range 3W

County DOUGLAS Date 4-24-01

Corner Designation



DOUGLAS COUNTY SURVEYOR

- Condition Report Only
- Not Found
- Renewed
- Unrecorded
- Surveyed In
- Referenced Out

Previous Renewals/Surveys, etc. \_\_\_\_\_

N/A

Monument(s) & Accessories Found: (Condition and Source)

N/A

Monument Detail

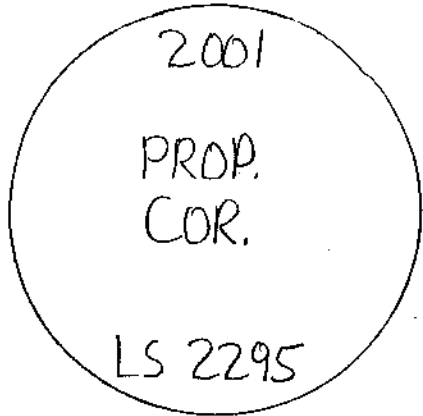

Sketch

N.T.S.

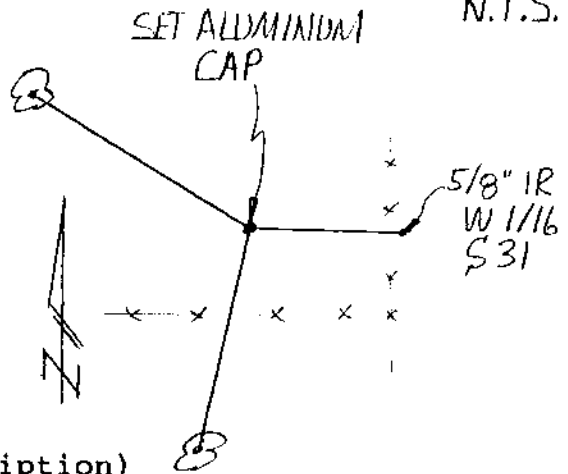

Monument Set (Procedures and Description)

SET 5/8" X 36" IR WITH 2" ALUMINUM CAP  
ALSO SET ALUMINUM POST AT CORNER

New Accessories

- \* 19" FIR BEARS N 66 1/2° W 71.7' SCRIBED "PROP. COR." "BT"
- \* 8 1/2" CEDAR BEARS S 9 1/4° W 61.1' SCRIBED "PROP. COR." "BT"

\* SET SPIKE IN THE BASE OF THE TREE & PLACED BT TAG.

Location & Comments

APPROX. 35' WEST'LY  
OF THE W 1/16 SECTION  
31 ONLY, T24S R3W.

Compass Declination N/A

Firm/Agency GREGORY D. LANG

Address 7550 WILLIS CR. RD.  
WINSTON, OR. 97496

Party Chief G. LANG

Notes \_\_\_\_\_

Witness T. LANG

Surveyor's Seal

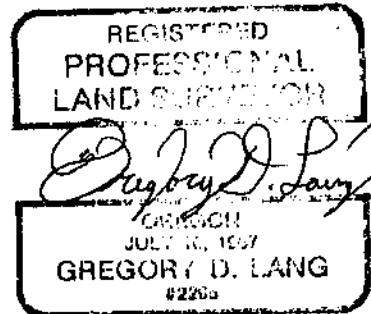

BEARINGS TO B.T.'S  
ARE RELATIVE TO MAP  
BEARINGS.

C.S. File No. 65/37-5 N

EXPIRES 12-31-02