

FILED

Date: 2/1/2001 By: JP

This survey consists of:

Map: M 132-70

Narrative: \_\_\_\_\_

Corner Rpt: LS 65/36-2 A

OREGON CORNER RESTORATION FORM

Section 34 Township 26S Range 2W

County Douglas Date Jan. 24, 2001

DOUGLAS COUNTY SURVEYOR

Corner Designation

T26S, R2W

533 | 534

54 | 53

T27S, R2W

Previous Renewals/Surveys, etc. \_\_\_\_\_

U.S. B.L.M., Harold D. Corbin, 1957

U.S. B.L.M., Wayne Rogers, 1979

Monument(s) & Accessories Found: (Condition and Source)

All found substantially as reported by  
U.S. B.L.M. Wayne Rogers in 1979.

Monument Detail

Sketch

Monument Set (Procedures and Description)

New Accessories

Location & Comments

Compass Declination 20°E

Firm/Agency Shaner

Engineering

Address P.O. Box 1430

Roseburg, Oregon 97470

Party Chief B. Shaner

Notes " "

Witness Claude McLean

David Snyder

Surveyor's Seal

REGISTERED  
PROFESSIONAL  
LAND SURVEYOR

Bruce A. Shaner

OREGON  
OCT. 4, 1957  
BRUCE A. SHANER  
430

Renews June 30,  
2002

C.S. File No. 65/36-2A

FILED

Date: 2/1/2001 By: JP

This survey consists of:

Map: M 132-70

Narrative: \_\_\_\_\_

Corner Rpt: CS 65/36-2B

OREGON CORNER RESTORATION FORM

Section 34 Township 26S Range 2W

County Douglas Date Jan. 24, 2001

DOUGLAS COUNTY SURVEYOR

Corner Designation

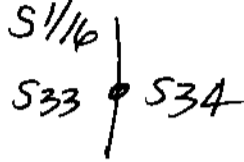

- Condition Report Only
- Not Found
- Renewed
- Unrecorded
- Surveyed In
- Referenced Out

Previous Renewals/Surveys, etc.

U.S. B.L.M., Wayne Rogers, 1979

Monument(s) & Accessories Found: (Condition and Source)

Found 3 1/4" Brass Cap on a 2 1/2" Iron Pipe, from which a:  
11" Grand Fir BT, now short snag, scribes visible,  
bears N 31 3/4° E, 50 feet.  
9" Grand Fir BT, now rotten stump, bears N 67 1/4° W, 92 feet.

Monument Detail

Sketch

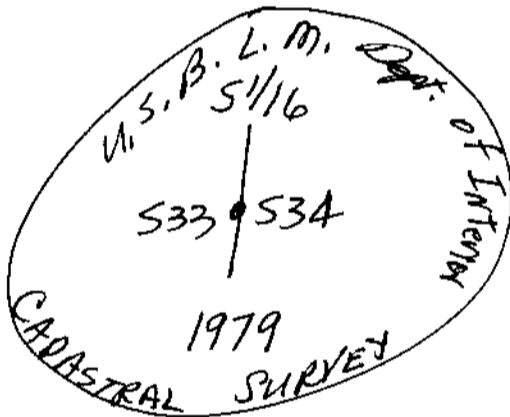

Monument Set (Procedures and Description)

None.

New Accessories

16" White Fir BT, I scribed " S1/16 S34 BT" bears S 61° E,  
92 feet.  
10" D. Fir BT, I scribed " S1/16 S33 BT" bears S 16° W,  
288 feet.

Location & Comments

Corner lies SE,  
150 feet, from  
switchback of  
rocked access  
road.

Compass Declination 20° E  
 Firm/Agency Shaner  
Engineering  
 Address P.O. Box 1430  
Roseburg, Oregon 97470  
 Party Chief B. Shaner  
 Notes " "

Witness David Snyder  
Claude McLean

Surveyor's Seal

REGISTERED  
 PROFESSIONAL  
 LAND SURVEYOR

Bruce A Shaner  
 OREGON  
 OCT. 4, 1957  
 BRUCE A. SHANER  
 430

Renews June 30,  
2002

C.S. File No. 65/36-2B

FILED

Date: 2/1/2001 By: JP

This survey consists of:

Map: M 132-70

Narrative: \_\_\_\_\_

Corner Fpt: C.S. 65/36-2C

OREGON CORNER RESTORATION FORM

Section 34 Township 26S Range 2W

County Douglas Date Jan. 24, 2001

DOUGLAS COUNTY  
SURVEYOR

Corner Designation

1/4  
533 | 534

- Condition Report Only
- Not Found
- Renewed
- Unrecorded
- Surveyed In
- Referenced Out

Previous Renewals/Surveys, etc.

Tom Shrum, 1979, M 76-56.

U.S.B.L.M., 1979, Wayne Rogers

Monument(s) & Accessories Found: (Condition and Source)

Found 2 1/2" Alum. Cap on a 3/4" Iron Pipe, from which a:

26" D. Fir BT, face overgrown, bears S64°W (B.M. <sup>B.M.</sup> 567°W),  
38 3 feet.

20" D. Fir BT, scribes visible, bears S23 1/2°E (B.M. <sup>B.M.</sup> 520 1/2°E),  
28 7 feet.

Monument Detail

Sketch

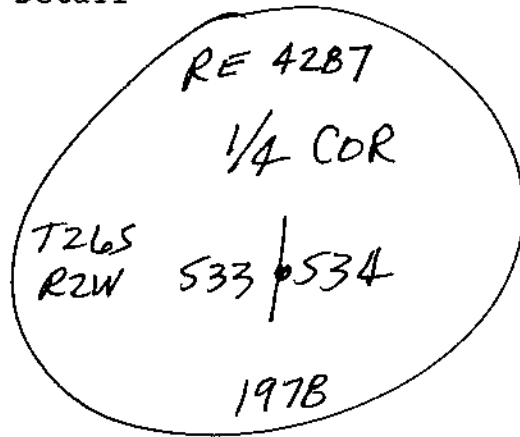

Monument Set (Procedures and Description)

None.

New Accessories

None.

Location & Comments

Corner sits 150 feet NE of switchback on rock access road. Compass Declination 20°E

Firm/Agency Shaner Engineering.

Address P.O. Box 1430 Roseburg, Oregon 97470

Party Chief B. Shaner

Notes " "

Witness David Snyder  
Claude McLean

Surveyor's Seal

REGISTERED  
PROFESSIONAL  
LAND SURVEYOR

Bruce A. Shaner

OREGON  
OCT. 4, 1957  
BRUCE A. SHANER  
430

Renews June 30,  
2002

C.S. File No. 65/36-2C

FILED

Date: 2/1/2001 By: JP

This survey consists of:

Map: M132-70

Narrative: \_\_\_\_\_

Corner Rpt: 65/36-20

OREGON CORNER RESTORATION FORM

Section 34 Township 26S Range 2W

County Douglas Date Jan. 24, 2001

DOUGLAS COUNTY SURVEYOR

Corner Designation

SW 1/16  
+

- Condition Report Only
- Not Found
- Renewed
- Unrecorded
- Surveyed In
- Referenced Out

Previous Renewals/Surveys, etc. \_\_\_\_\_

None.

Monument(s) & Accessories Found: (Condition and Source)

None.

Monument Detail

Sketch

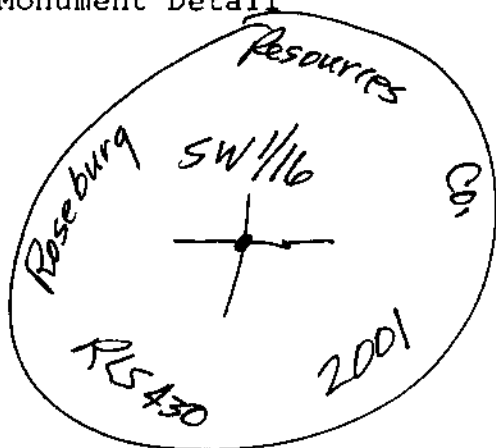

Monument Set (Procedures and Description)

I set a 3/4" x 40" Iron Rod with a 2 1/2" Alum. Cap  
from which a:

New Accessories

10" W. Red Cedar BT, I scribed "SW 1/16 BT" bears N30°W,  
6 1/2 feet.

36" W. Red Cedar BT, I scribed "SW 1/16 BT" bears  
S21°W, 24 1/2 feet.

6 Foot Steel Post bears East, 10 feet.

Location & Comments

Surveyor's Seal

Compass Declination 20°E

Firm/Agency Shaner

Engineering

Address P.O. Box 1430

Roseburg, Oregon 97470

Party Chief B. Shaner

Notes " "

Witness Claude McKean

Ron Schneider

REGISTERED  
PROFESSIONAL  
LAND SURVEYOR

Bruce A. Shaner

OREGON  
OCT. 4, 1957  
BRUCE A. SHANER  
430

Renews June 30,  
2002

C.S. File No. 65/36-20

FILED

Date: 2/1/2001 By: JP

This survey consists of:

Map: M132-70

Narrative: \_\_\_\_\_

Corner Rpt: 65/36-2E

OREGON CORNER RESTORATION FORM

Section 34 Township 26S Range 2W

County Douglas Date Jan. 24, 2001

DOUGLAS COUNTY SURVEYOR

Corner Designation

CW 1/16

- Condition Report Only
- Not Found
- Renewed
- Unrecorded
- Surveyed In
- Referenced Out

Previous Renewals/Surveys, etc. \_\_\_\_\_

None.

Monument(s) & Accessories Found: (Condition and Source)

None.

Monument Detail

Sketch

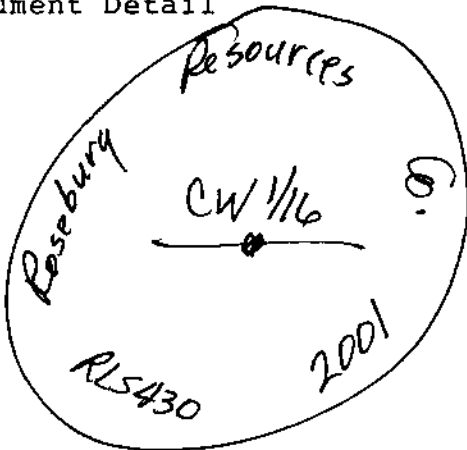

Monument Set (Procedures and Description)

I set a 3/4" x 90" Iron Rod with a 2 1/2" Alum. Cap from which a:

New Accessories

24" Hembok BT, I scribed "CW 1/16 BT" bears N86°E, 27.4 feet.  
20" W. Red Cedar BT, " " " " " " " " bears S53D°E, 97 feet.

Location & Comments

Corner sets in  
Rock Pile (Rubble),  
Rocks 4' to 6' Diameter  
in Shivigny Creek.

Compass Declination 20°E

Firm/Agency Shaner

Engineering

Address PO. Box 1430

Roseburg, Oregon 97470

Party Chief B. Shaner

Notes " "

Witness Claude McLean

Ron Schneider

Surveyor's Seal

REGISTERED PROFESSIONAL LAND SURVEYOR

Bruce A. Shaner

OREGON OCT. 4, 1957 BRUCE A. SHANER 430

Renewal June 30,

2002

C.S. File No. 65/36-2E

FILED

Date: 2/1/2001 By: JP

This survey consists of:

Map: M 132-70

Narrative: \_\_\_\_\_

Corner Rpt: 65 65/36-2F

OREGON CORNER RESTORATION FORM

Section 34 Township 26S Range 2W

County Douglas Date Jan. 24, 2001

DOUGLAS COUNTY  
SURVEYOR

Corner Designation

$\frac{1}{4} S \frac{534}{53}$  T26S, R2W  
T27S, R2W

- Condition Report Only
- Not Found
- Renewed
- Unrecorded
- Surveyed In
- Referenced Out

Previous Renewals/Surveys, etc.

U.S.B.L.M., Harold D. Corbin, 1957

U.S.B.L.M., Wayne Rogers, 1979

Monument(s) & Accessories Found: (Condition and Source)

All found as reported by U.S.B.L.M.'s  
Wayne Rogers, 1979.

Monument Detail

Sketch

Monument Set (Procedures and Description)

New Accessories

Location & Comments

Surveyor's Seal

Compass Declination 20°E

Firm/Agency Shaner

ENGINEERING

Address P.O. Box 1430

Roseburg, Oregon 97470

Party Chief B. Shaner

Notes " "

Witness Ben Schneider

REGISTERED  
PROFESSIONAL  
LAND SURVEYOR

Bruce A Shaner  
OREGON  
OCT. 4, 1957  
BRUCE A. SHANER  
430

Renews June 30,  
2002

C.S. File No. 65/36-2F

FILED

Date: 2/1/2001 By: JP

This survey consists of:

Map: M 132-70

Narrative: \_\_\_\_\_

Corner Rpt: C5 65/36-2 G

OREGON CORNER RESTORATION FORM

Section 34 Township 26S Range 2W

County Douglas Date Jan. 24, 2001

DOUGLAS COUNTY SURVEYOR

Corner Designation

C5 1/16  
↓

- Condition Report Only
- Not Found
- Renewed
- Unrecorded
- Surveyed In
- Referenced Out

Previous Renewals/Surveys, etc. \_\_\_\_\_

None.

Monument(s) & Accessories Found: (Condition and Source)

None.

Monument Detail

Sketch

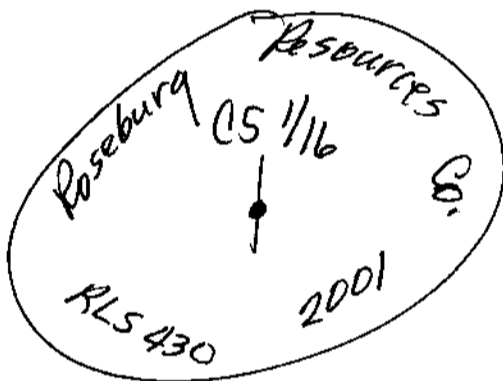

Monument Set (Procedures and Description)

I set a 3/4" x 40" Iron Rod with a 2 1/2" Alum. Cap, from which a:

New Accessories

- 12" D. Fir BT, I scribed "C5 1/16, BT" bears N 39° W, 8 1/2 feet
- 22" D. Fir BT, " " " " " " bears S 85° W, 23 1/2 feet
- 6 Foot Steel Fence Post bears West, 10 feet
- " " " " " " South, 10 feet

Location & Comments

Surveyor's Seal

Compass Declination 20° E

Firm/Agency Shaner

Engineering

Address P.O. Box 1430

Roseburg, Oregon 97470

Party Chief B. Shaner

Notes " "

Witness Claude McKeon

REGISTERED PROFESSIONAL LAND SURVEYOR

Bruce A. Shaner

OREGON OCT. 4, 1957 BRUCE A. SHANER 430

Ron Schneider

Renews June 30,

C.S. File No. 65/36-2G 2002

FILED

Date: 2/1/2001 By: JP

This survey consists of:

Map: M132-70

Narrative: \_\_\_\_\_

Corner Rpt: CS 65/36-2H

OREGON CORNER RESTORATION FORM

Section 34 Township 26S Range 2W

County Douglas Date JAN. 24, 2001

DOUGLAS COUNTY  
SURVEYOR

Corner Designation

C1/4

- Condition Report Only
- Not Found
- Renewed
- Unrecorded
- Surveyed In
- Referenced Out

Previous Renewals/Surveys, etc.

Tom Shrum, 1979, M76-56

Monument(s) & Accessories Found: (Condition and Source)

Found 2 1/2" Alum. Cap on a 3/4" Iron Pipe, from which:  
5" White Oak BT, scribes visible, bears S33°E, 12 1/2 ft.  
6" White Oak BT, face overgrown, bears N19°E, 15 3/4 ft.

Monument Detail

Sketch

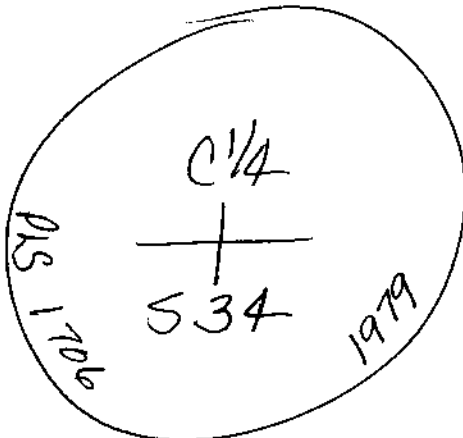

Monument Set (Procedures and Description)

None.

New Accessories

6 Foot Alum. Post bears West, 10 feet.  
" " " " " East, 10 feet.

Location & Comments

Corner sits on  
upper edge of  
major bluff  
opening.

Compass Declination 20°E  
 Firm/Agency Shaner  
Engineering  
 Address P.O. Box 1430  
Roseburg Oregon 97470  
 Party Chief B. Shaner  
 Notes " "  
 Witness C. Mclean  
D. Snyder

Surveyor's Seal

REGISTERED  
PROFESSIONAL  
LAND SURVEYOR

Bruce A. Shaner  
 OREGON  
 OCT. 4, 1957  
 BRUCE A. SHANER  
 430

Renews June 30,  
2002

C.S. File No. 65/36-2H

FILED

Date: 2/1/2001 By: JP

This survey consists of:

Map: M132-70

Narrative: \_\_\_\_\_

Corner Rpt: CS 65/36-21

OREGON CORNER RESTORATION FORM

Section 34 Township 26S Range 2W

County Douglas Date Jan. 24, 2001

DOUGLAS COUNTY SURVEYOR

Corner Designation

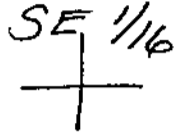

- Condition Report Only
- Not Found
- Renewed
- Unrecorded
- Surveyed In
- Referenced Out

Previous Renewals/Surveys, etc. \_\_\_\_\_

None.

Monument(s) & Accessories Found: (Condition and Source)

None.

Monument Detail

Sketch



Monument Set (Procedures and Description)

I set a 3/4" x 3/8" Iron Rod with a 2 1/2" Alum. Cap, from which a:

New Accessories

12" Madrone B.T., I bark scribed "SE 1/16 BT", bears N2°W, 2° feet.

36" Q. Fir B.T., I scribed "SE 1/16 BT", bears 54°E, 23 1/2 feet.

6 Foot Alum. Post bears East, 1° feet.

Location & Comments

Surveyor's Seal

Corner lies 40 feet below small bluff.

Compass Declination 20°E

Firm/Agency Shaner Engineering

Address P.O. Box 1430

Roseburg, Oregon 97470

Party Chief A. Shaner

Notes " "

Witness Ron Schneider

REGISTERED PROFESSIONAL LAND SURVEYOR

Bruce A. Shaner  
OREGON  
OCT. 4, 1957  
BRUCE A. SHANER  
430

Gregg Panski

C.S. File No. 65/36-21

Renews June 30, 2002

FILED

Date: 2/1/2001 By: JP

This survey consists of:

Map: M 132-70

Narrative: \_\_\_\_\_

Corner Rpt: CS 65/36-2-J

OREGON CORNER RESTORATION FORM

Section 34 Township 26S Range 2W

County Douglas Date Jan. 24, 2001

DOUGLAS COUNTY  
SURVEYOR

Corner Designation

CE 1/16

- Condition Report Only
- Not Found
- Renewed
- Unrecorded
- Surveyed In
- Referenced Out

Previous Renewals/Surveys, etc. \_\_\_\_\_

Tom Shrum, 1979, Map M76-56.

Monument(s) & Accessories Found: (Condition and Source)

Found 2 1/2" Alum. Cap on a 3/4" Iron Pipe, from which a:  
16" Cedar BT, face overgrown, bears S 73° E, 7<sup>2</sup> feet.  
8" Hemlock BT, now a rotten stump, bears N 37° W, 25<sup>0</sup> feet.

Monument Detail

Sketch

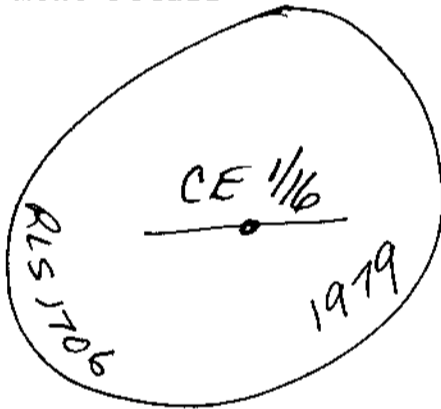

Monument Set (Procedures and Description)

None.

New Accessories

12" Cedar BT, I scribed "CE 1/16 BT", bears N 70° W, 23<sup>9</sup> feet,  
6 feet Alum. Post bears South, 1<sup>0</sup> feet.

Location & Comments

Surveyor's Seal

Compass Declination 20° E

Firm/Agency Shaner

Engineering

Address PO Box 1430

Roseburg, Oregon 97470

Party Chief B. Shaner

Notes " "

Witness Ren Schneider

Gregg Danskin

REGISTERED  
PROFESSIONAL  
LAND SURVEYOR

Bruce A. Shaner

OREGON  
OCT. 4, 1957  
BRUCE A. SHANER  
430

Renews June 30,  
2002

C.S. File No. 65/36-2-J

FILED

Date: 2/1/2001 By: JP

This survey consists of:

Map: M 132-70

Narrative: \_\_\_\_\_

Corner Rpt: CS 65/36-2K

OREGON CORNER RESTORATION FORM

Section 34 Township 26S Range 2W

County Douglas Date Jan. 24, 2001

DOUGLAS COUNTY  
SURVEYOR

Corner Designation

T26S, R2W	
534	535
53	52
T27S, R2W	

Condition Report Only  
 Not Found  
 Renewed  
 Unrecorded  
 Surveyed In  
 Referenced Out

Previous Renewals/Surveys, etc.

U.S.B. L.M. Harold D. Corbin, 1957

Douglas County Surveyor V. Ray Tracy, 1967, File CS 5440

Monument(s) & Accessories Found: (Condition and Source)

Found 3 1/4" Brass Cap with 2 1/2" Iron Pipe from which a:  
30" D. Fir BT, face agrown, bears N25 1/2° E, 25 1/2 feet.  
24" D. Fir BT, " " , bears S29 1/4° W, 57 1/2 feet.  
24" D. Fir BT, " " , bears N76° W, 73 1/2 feet.  
22" Madrone BT, " " , bears S82° E, 55 1/2 feet.  
28" D. Fir BT, " " , (record 15"), bears S75° E,  
20 3/4 feet.

Monument Detail

Sketch

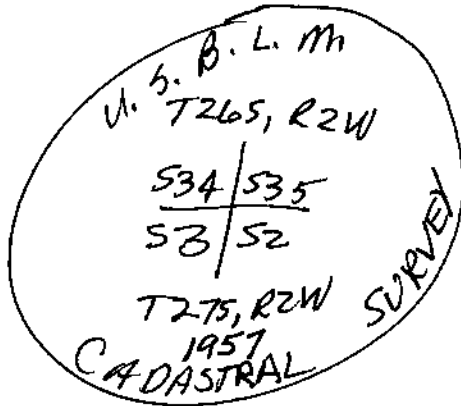

Monument Set (Procedures and Description)

None.

New Accessories

6 Foot Alum Post, bears West, 10 foot  
" " " " , bears North, 10 foot.

Location & Comments

Corner lies on  
top of major  
ridge, runs  
NW-SE.

Compass Declination 20° E  
 Firm/Agency Shaner  
Engineering  
 Address P.O. Box 1430  
Roseburg, Oregon 97470  
 Party Chief B. Shaner  
 Notes " "

Witness Ron Schneider  
Claude McLean

Surveyor's Seal

REGISTERED  
PROFESSIONAL  
LAND SURVEYOR

Bruce A. Shaner

OREGON  
OCT. 4, 1957  
BRUCE A. SHANER  
430

Renews June 30,  
2002

C.S. File No. 65/36-2K

FILED

Date: 2/1/2001 By: JP

This survey consists of:

Map: M 132-70

Narrative: \_\_\_\_\_

Corner Rpt: CS 65/36-2L

OREGON CORNER RESTORATION FORM

Section 34 Township 26S Range 2W

County Douglas Date Jan. 24, 2001

DOUGLAS COUNTY SURVEYOR

Corner Designation

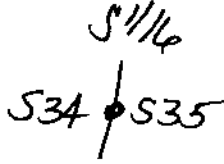

- Condition Report Only
- Not Found
- Renewed
- Unrecorded
- Surveyed In
- Referenced Out

Previous Renewals/Surveys, etc. \_\_\_\_\_

None.

Monument(s) & Accessories Found: (Condition and Source)

None.

Monument Detail

Sketch

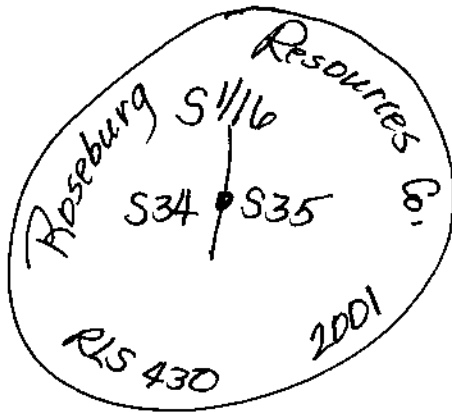

Monument Set (Procedures and Description)

I set a 3/4" x 40" Iron Rod with a 2 1/2" Alum. Cap from which a:

New Accessories

14" D. Fir BT, I scribed "S35 S 1/16 BT" bears N70°E, 125 feet.

12" D. Fir BT, I scribed "S34 S 1/16 BT" bears S68°W, 31 feet.

6 Foot Alum. Post bears South, 10 feet.

Location & Comments

Surveyor's Seal

Compass Declination 20°E

Firm/Agency Shaner

Engineering

Address P.O. Box 1430

Roseburg, Oregon 97470

Party Chief B. Shaner

Notes " "

Witness Ren Schneider

Gregg Panskine

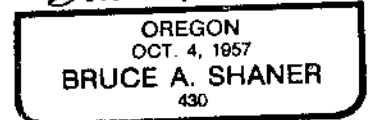
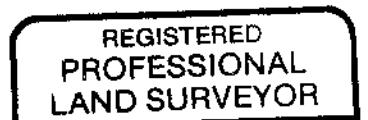

Bruce A. Shaner

OREGON  
OCT. 4, 1957  
BRUCE A. SHANER  
430

Renews June 30,

C.S. File No. 65/36-2L 2002

FILED

Date: 2/1/2001 By: SP

This survey consists of:

Map: M 132-70

Narrative: \_\_\_\_\_

Corner Rpt: CS 65/36-2M

OREGON CORNER RESTORATION FORM

Section 34 Township 26S Range 2W

County Douglas Date Jan. 24, 2001

DOUGLAS COUNTY SURVEYOR

Corner Designation

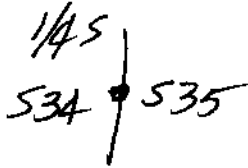

- Condition Report Only
- Not Found
- Renewed
- Unrecorded
- Surveyed In
- Referenced Out

Previous Renewals/Surveys, etc.

Douglas County, V. Ray Tracy, 1967, CS-65; Tom Shrum, 1979, M 76-56;  
U.S.B.L.M. Plat., 1997.

Monument(s) & Accessories Found: (Condition and Source)

Found 2 1/2" Brass Cap on a 1" Iron Pipe, from which a:  
28" Hemlock BT, Scribes visible, bears S 26° E, 110 2/3 feet.  
6" Cedar BT, face overgrown, bears N 16 1/4° W, 25 1/2 feet.

2 1/2" Brass Cap on a 1" Iron Pipe, SW Corner of Tract 38,  
bears South, 125 Feet.

Monument Detail

Sketch

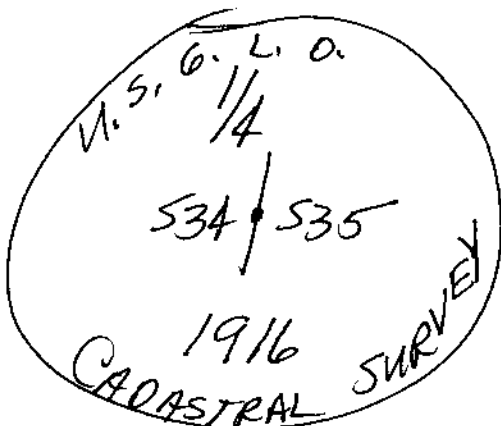

Monument Set (Procedures and Description)

None.

New Accessories

6" Red Cedar BT, I scribed "1/4 S 534 BT"  
bears N 75° W, 7 3/4 feet.

Location & Comments

Corner lies at  
bottom of small  
bluff in rock.

Compass Declination 20° E

Firm/Agency Shaner

Engineering

Address P.O. Box 1430

Roseburg, Oregon 97470

Party Chief B. Shaner

Notes " "

Witness Ron Schneider

Gregg Panssive

Surveyor's Seal

REGISTERED  
PROFESSIONAL  
LAND SURVEYOR

Bruce A Shaner

OREGON  
OCT. 4, 1957  
BRUCE A. SHANER  
430

Renews June 30,  
2002

C.S. File No. 65/36-2M