

2001-29096

AFFIDAVIT OF CORRECTION

I, Bruce R. Rogers, being duly sworn, depose and say that I am the surveyor who surveyed Land Partition Plat No. 1999-0092 (Instrument No. 99-27776) as recorded in the Land Partition Records of Douglas County, Oregon and that the following correction to said Plat shown as Exhibit A attached hereto is necessary and is as follows:

"See Concurrence to platting (Exhibit A) recorded in Book ____, Page ____ (Instrument No. _____) in the Deed Records of Douglas County, Oregon"

The fee owners materially affected by said Consent Affidavit are as follows:

Lloyd J. Veach, Jr.
3644 Old Highway 99
Roseburg, Oregon 97470

Mary M. Veach
3644 Old Highway 99
Roseburg, Oregon 97470

Richard R. Thornley
5114 SW Grange Road
Roseburg, Oregon 97470

Joyce N. Thornley
5114 SW Grange Road
Roseburg, Oregon 97470

A-1 Auto Sales, Inc.
3704 Old Highway 99
Roseburg, Oregon 97470

FILED
Date: 12/17/2001 By: JP
This survey consists of:
Map: 1999-0092
Narrative: _____
Corner Rpt: CS 65/35-18

DOUGLAS COUNTY
SURVEYOR

By: Bruce R. Rogers
Bruce R. Rogers
1727 SE Mill St.
Roseburg, Oregon 97470

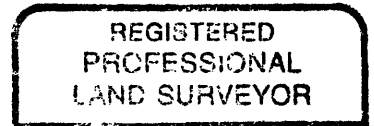

Bruce R. Rogers

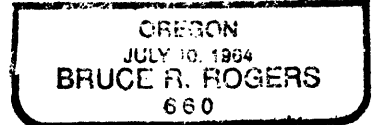

Exp. 12/31/02

NOTARY CERTIFICATE:

State of Oregon)
)SS
County of Douglas)

Subscribed and sworn to before me this 11th day of Sept, 2001

Jean H Crawford
Notary Public for the State of Oregon
My Commission Expires 4-17-2002

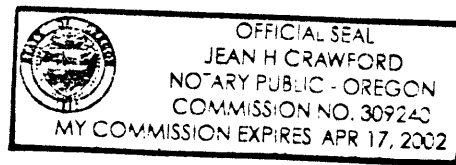

APPROVAL:

I, Romey Ware, Douglas County Surveyor, do hereby certify that said affidavit of correction for Land Partition No. 1999-0092 (Instrument No. 99-27776) as recorded in the Land Partition Records of Douglas County, Oregon has been examined by me and that it complies with O.R.S. 92.170.

Romey Ware
Romey Ware
Douglas County Surveyor

Surveyor
MADE

C.S. File No. 65/35-18A

