

AFFIDAVIT OF CORRECTION (SURVEY)

I, *F. Neil Hibbs*, being duly sworn, depose and say that I am the surveyor who surveyed the property as depicted, filed and recorded as *Survey Plat No. M135-44*, Douglas County, Oregon Survey Records; and

The following correction to said plat is necessary and is as follows:

THE POINT, "D", NEEDS TO BE SHOWN AS A SET MONUMENT

The present fee owner of the property materially affected by said Affidavit is as follows:
E. Lansdon and Pat Black
145 Melon Ln.
Roseburg, Or, 97470

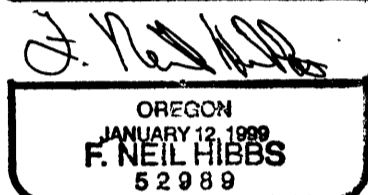
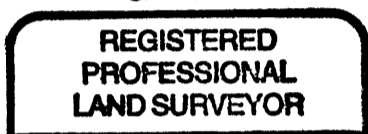

Expires 6/30/01

F. Neil Hibbs

F. Neil Hibbs, P.L.S.
License No. 52989

FILED

Date: 6/13/2001 By: JP

This survey consists of:

For Map: M135-44

Narrative: _____

Corner Rpt: _____

NOTARY CERTIFICATE

STATE OF OREGON
COUNTY OF DOUGLAS

DOUGLAS COUNTY
SURVEYOR

Subscribed and sworn to before me this 11 day of June,
2001.

Nancy A. Winchell
Notary Public for the State of Oregon
My Commission Expires 10/20/01

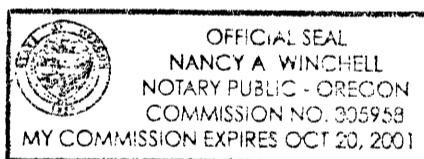

COUNTY SURVEYOR APPROVAL

I, *Romanso E. Ware*, Douglas County Surveyor, do hereby certify that said Affidavit of Correction for *Survey Plat No. M135-44* has been examined by me and that it complies with ORS 209.255.

Romanso E. Ware
Romanso E. Ware, County Surveyor

STATE OF OREGON |
COUNTY OF DOUGLAS | 98
I, DOYLE SHAVER JR., COUNTY CLERK AND
RECORDER OF CONVEYANCES, DO HEREBY CERTIFY
THAT THIS INSTRUMENT WAS RECORDED

01 JUN 12 AM 9:09

DOYLE SHAVER JR.
DOUGLAS COUNTY CLERK

IN THE OFFICIAL RECORDS OF DOUGLAS COUNTY

BY *David G. Burnett*

81 FEE 10.00

2001-13102

HANDED SURVEYOR

C.S. File No. 65/35-12