

AFFIDAVIT OF CORRECTION (PLAT)

I, F. Neil Hibbs, being duly sworn, depose and say that I am the surveyor who surveyed the property as depicted, filed and recorded as Land Partition 2000-0045 A&B of the Survey Records of Douglas County, Oregon; and

The following corrections to said plat are necessary and are as follows:

A statement reading, " THE BEARINGS AND DISTANCES SHOWN IN REGARDS TO COMPUTED POINTS ARE APPROXIMATE ONLY AND SHOULD NOT BE RELIED UPON AS BEING THE TRUE BEARINGS AND DISTANCES.", is to be added to the face of the Plat.

The present fee owners of the property materially affected by said Affidavit are as follows: PJ and Shari Washburn
Bill D. and Sharyn A. Adams

F. Neil Hibbs

F. Neil Hibbs, P.L.S.
License No. 52989

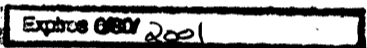
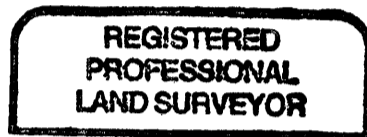

NOTARY CERTIFICATE

STATE OF OREGON
COUNTY OF DOUGLAS

Subscribed and sworn to before me this 30th day of April, 2001.

Jean Crawford
Notary Public for the State of Oregon
My Commission Expires 4-17-2002

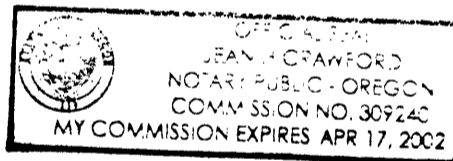

BANDED

COUNTY SURVEYOR APPROVAL

I, Romanso E. Ware, Douglas County Surveyor, do hereby certify that said Affidavit of Correction for Land Partition 2000-0045 A&B, has been examined by me and that it complies with ORS 92.170.

Romanso E. Ware
Romanso E. Ware, County Surveyor

STATE OF OREGON | 98
COUNTY OF DOUGLAS |
I, DOYLE SHAVER JR., COUNTY CLERK AND
RECORDER OF CONVEYANCES, DO HEREBY CERTIFY
THAT THIS INSTRUMENT WAS RECORDED

01 MAY -1 AM 8:00

DOYLE SHAVER JR.
DOUGLAS COUNTY CLERK

IN THE OFFICIAL RECORDS OF DOUGLAS COUNTY

BY *[Signature]*

DEPUTY
80
FEE 10
10

FILED

Date: 5/7/2001 By: JP

This survey consists of:

Map: 2000-0045 A&B

Narrative: _____

Corner Rpt: _____

DOUGLAS COUNTY
SURVEYOR