

AFFIDAVIT OF CORRECTION (PLAT)

I, *Wayne L. Rogers*, being duly sworn, depose and say that I am the surveyor who surveyed the property as depicted, filed and recorded as Boundary Line Adjustment *M135-10*, Douglas County, Oregon Survey Records; and

The following correction to the Plat is necessary and is as follows The record tie from the Southwest corner of Unit 1 to the 1/4 corner of sections 25 and 30 should be (N89° 30' 45" E., 546.45 feet).

The present fee owner of the property materially affected by said Affidavit is as follows:

There is no affect to any landowner.

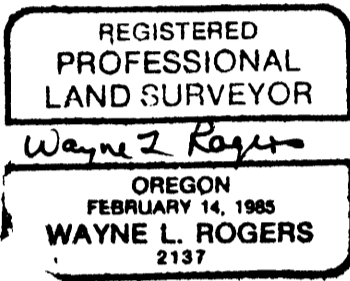

Wayne L. Rogers
Wayne L. Rogers, P.L.S.
License No. 2137

FILED

Date: 2/13/2001 By: JP

This survey consists of:

For Map: M135-10

Narrative: _____

Corner Rpt: CS 65/35-1

Expires 12/31/2002

NOTARY CERTIFICATE

STATE OF OREGON
COUNTY OF DOUGLAS

DOUGLAS COUNTY
SURVEYOR

Subscribed and sworn to before me this 9th day of FEBRUARY,
2001.

J. Neil Hibbs
Notary Public for the State of Oregon
My Commission Expires 1-19-2003

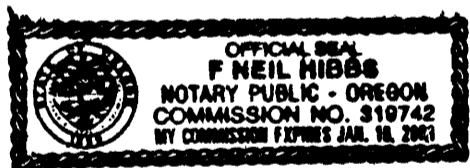

COUNTY SURVEYOR APPROVAL

I, *Romanso E. Ware*, Douglas County Surveyor, do hereby certify that said Affidavit of Correction for Survey *M135-10*, has been examined by me and that it complies with ORS 209.255.

STATE OF OREGON }
COUNTY OF DOUGLAS } ss
I, DOYLE SHAVER JR., COUNTY CLERK AND
RECORDER OF CONVEYANCES, DO HEREBY CERTIFY
THAT THIS INSTRUMENT WAS RECORDED

Romanso E. Ware
Romanso E. Ware, County Surveyor

01 FEB 12 PM 1:41

DOYLE SHAVER JR.
DOUGLAS COUNTY CLERK
IN THE OFFICIAL RECORDS OF DOUGLAS COUNTY

BY *Glenn Bennett*
REPORT 16⁰⁰
(81) FEB 10⁰⁰
26⁰⁰ ml

2001-03482

C.S. File No. 65/35-1

✓ SURVEYOR