



GARY T. SMITHER

Professional Land Surveyor
Certified Water Rights Examiner

FILED

Date: 1-8-2001 By: JS

This survey consists of:

Map: _____

Narrative: _____

Course Rpt: 65/33-21

DOUGLAS COUNTY
SURVEYOR

Dec. 2000

**Township 21 South, Range 8 West
Section 6**

Southwest Corner for Section Six: Found 1966 Brass Cap on Iron Pipe firmly set with an aluminum post with an International Paper Sign driven alongside the Brass Cap.

Old Bearing Trees:

37" Fir, now 46" in diameter, N 77° E, 36 links, with opened and burned face and tag, found in 1966.

18" Fir, S 4 1/2° E, 51 links, taken in 1945 and recovered in 1966 is gone.

10" Alder, N 67° W, 19.4 feet, with visible scribes on open face, with tag, taken in 1989.

12" Alder, now 13" in diameter, N 66° E, 48.2 feet, with visible scribes on open face, with tag, taken in 1989.

10" Alder, taken in 1989, at S 62° E, 33.2 feet, is gone.

New Bearing Trees:

12" Alder, N 33° W, 19.0 feet to spike driven in side center, marked "X" at breast height and bark scribed "BT" at base, with bearing tree tag.

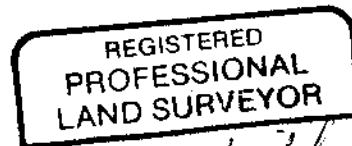

Gary T. Smither



Expires 6/2002

FAX and Phone (541) 751-9624
P.O. Box 545, North Bend, OR 97459

C.S. File No. 65/33-21