

FILED

Date: 10/4/2000 By: JP

This survey consists of:

Map: M.132-51

Narrative: _____

Corner Rpt: CS 65/33-1A

OREGON CORNER RESTORATION FORM

Section 12 Township 31S Range 5W

County Douglas Date Oct. 2, 2000

DOUGLAS COUNTY
SURVEYOR

Corner Designation

S 1/16
S11 • S12

- Condition Report Only
- Not Found
- Renewed
- Unrecorded
- Surveyed In
- Referenced Out

Previous Renewals/Surveys, etc.

U.S. B. L. M. 1973

B. T. S. 1987 (RM 3-67)

Monument(s) & Accessories Found: (Condition and Source)

Found 3/4" Brass Cap with 2 1/2" Iron Pipe from which a:
10" D. Fir BT (New snag) face overgrown, bears
S 59 1/2° E, 27.7 feet.

14" D. Fir BT, face overgrown, bears S 12 1/2° W (record
S 8 1/2° W), 57.4 feet.

Monument Detail

Sketch

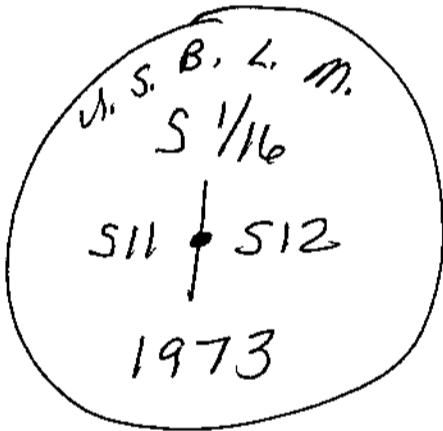

Monument Set (Procedures and Description)

None.

New Accessories

None.

Location & Comments

This corner is
on West side of
Main ridge top
access road,
Some 8 feet off
roadway.

Compass Declination 20° E

Firm/Agency Shaner
Engineering, INC.

Address P.O. Box 1430
Roseburg, Oregon 97470

Party Chief B. Shaner

Notes " "

Witness David Snyder

Claude McLean

Surveyor's Seal

REGISTERED
PROFESSIONAL
LAND SURVEYOR

Bruce A. Shaner

OREGON
OCT. 4, 1957
BRUCE A. SHANER
430

RENEW'S JUNE 30,
2002

C.S. File No. 65/33-1A

FILED

Date: 10/4/2000 By: JP

This survey consists of:

Map: M 132-51

Narrative: _____

Corner Rpt: CS 65/33-LB

OREGON CORNER RESTORATION FORM

Section 12 Township 31S Range 5W

County Douglas Date Oct. 2, 2000

DOUGLAS COUNTY
SURVEYOR

Corner Designation

1/4 S
S11 • S12

- Condition Report Only
- Not Found
- Renewed
- Unrecorded
- Surveyed In
- Referenced Out

Previous Renewals/Surveys, etc.

U.S. B.L.M. 1973

B.T.S. 1987 (RM 3-67)

Monument(s) & Accessories Found: (Condition and Source)

Found a 3 1/4" Brass Cap on a 2 1/2" Iron Post, from which a:

26" (record 17") D. Fir BT, face overgrown, bears

S22 1/2° E, 38.0 feet.

18" (record 12") D. Fir BT stump, face overgrown,

bears N29 1/2° W, 29.0 feet.

Monument Detail

Sketch

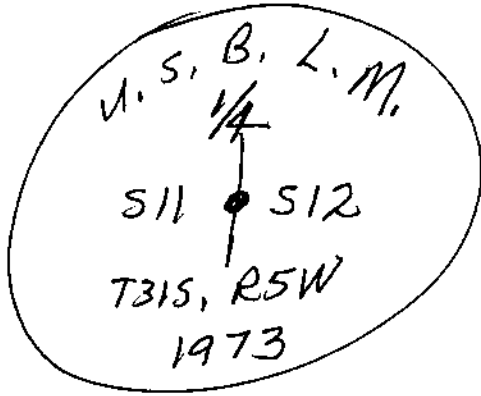

Monument Set (Procedures and Description)

None.

New Accessories

6" D. Fir BT, I scribed " 1/4 S11 BT "
bears N48 1/2° W, 34.1 feet.

Location & Comments

None.

Compass Declination 20° E

Firm/Agency Shaner

Engineering, Inc.

Address P.O. Box 1430

Roseburg, Oregon 97470

Party Chief B. Shaner

Notes " "

Witness David Snyder

Claude McLean

Surveyor's Seal

REGISTERED
PROFESSIONAL
LAND SURVEYOR

Bruce A. Shaner

OREGON
OCT. 4, 1987
BRUCE A. SHANER
430

Renews June 30,
2002

C.S. File No. 65/33-LB

FILED

Date: 10/4/2000 By: JP

This survey consists of:

Map: M 132-51

Narrative: _____

Corner Rpt: CS 65/33-1C

OREGON CORNER RESTORATION FORM

Section 12 Township 31S Range 5W

County Douglas Date Oct. 3, 2000

DOUGLAS COUNTY
SURVEYOR

Corner Designation

SW 1/16

Condition Report Only

Not Found

Renewed

Unrecorded

Surveyed In

Referenced Out

Previous Renewals/Surveys, etc. _____

None.

Monument(s) & Accessories Found: (Condition and Source)

None.

Monument Detail

Sketch

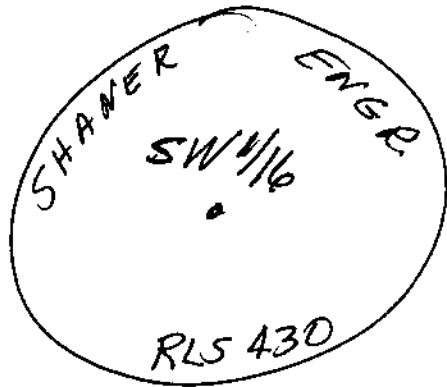

Monument Set (Procedures and Description)

I set a 5/8" x 30" Iron Rod with a 1 1/2" Aluminum Cap, marked as above, from which a:

New Accessories

10" D. Fir BT, I scribed "SW 1/16 BT" bears

S81°W, 20.4 feet.

6" D. Fir BT, I scribed "SW 1/16 BT" bears

N62°E, 8.4 feet.

6 Foot Steel Fence Post bears North, 1.0 foot.

Location & Comments

Surveyor's Seal

None.

Compass Declination 20°E

Firm/Agency Shawer Engineering, INC.

Address P.O. Box 1430

Roseburg, OR 97470

Party Chief B. Shawer

Notes " "

Witness David Snyder

Claude McLean

REGISTERED
PROFESSIONAL
LAND SURVEYOR

Bruce A. Shawer

OREGON
OCT. 4, 1957
BRUCE A. SHAWER
430

Renews June 30,

2002

C.S. File No. 65/33-1C

FILED

Date: 10/4/2000 By: JP
This survey consists of:
Map: M132-51
Narrative: _____
Corner Rpt: 65/33-1D

OREGON CORNER RESTORATION FORM

Section 12 Township 31S Range 5W
County Douglas Date Oct. 3, 2000

DOUGLAS COUNTY
SURVEYOR

Corner Designation



- Condition Report Only
- Not Found
- Renewed
- Unrecorded
- Surveyed In
- Referenced Out

Previous Renewals/Surveys, etc. _____

None

Monument(s) & Accessories Found: (Condition and Source)

None

Monument Detail

Sketch

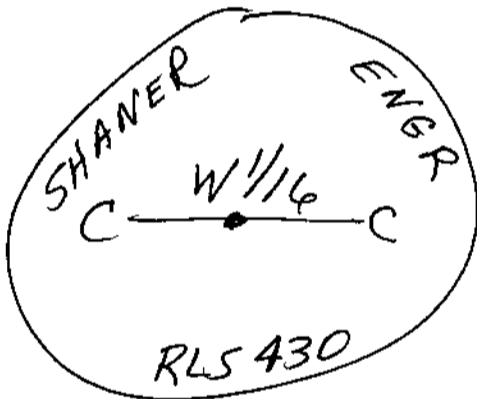

Monument Set (Procedures and Description)

I set a 5/8" x 30" Iron Rod with a 1 1/2" Aluminum Cap, marked as above, from which a:

New Accessories

8" D. Fir BT, I scribed "CW 1/16 BT", bears 517°W, 5.0 feet.

6" D. Fir BT, I scribed "CW 1/16 BT" bears 579°W, 9.3 feet.

6 Foot Steel Fence Post bears South, 1.0 foot.

Location & Comments

Surveyor's Seal

None

Compass Declination 20°E

Firm/Agency Shaner

Engineering, Inc.

Address P.O. Box 1430

Roseburg, OR 97470

Party Chief B. Shaner

Notes " "

Witness David Snyder

Claude McLean

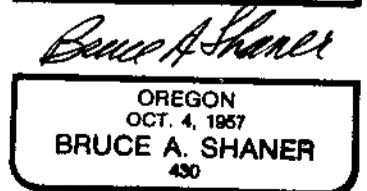

Renewed June 30, 2002

CS File No. 65/33-1D

FILED

Date: 10/4/2000 By: JP

This survey consists of:

Map: M 135-51

Narrative: _____

Corner Rpt: CS 65/33-1 E

OREGON CORNER RESTORATION FORM

Section 12 Township 31S Range 5W

County Douglas Date Oct. 3, 2000

DOUGLAS COUNTY
SURVEYOR

Corner Designation

NW 1/16

- Condition Report Only
- Not Found
- Renewed
- Unrecorded
- Surveyed In
- Referenced Out

Previous Renewals/Surveys, etc. _____

None.

Monument(s) & Accessories Found: (Condition and Source)

None.

Monument Detail

Sketch

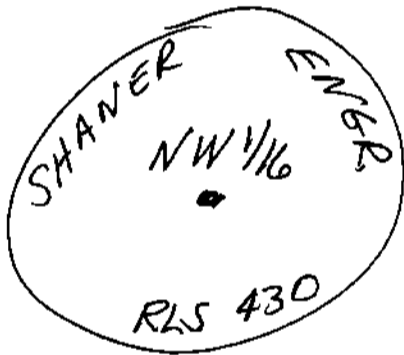

Monument Set (Procedures and Description)

I set a 5/8" x 30" Iron Rod with a 1 1/2" Alum. Cap, marked as above, from which a:

New Accessories

16" D. Fir BT, I scribed "NW 1/16 BT", bears S22°W, 8.0 feet.

16" D. Fir BT, I scribed "NW 1/16 BT", bears N54°E, 17.5 feet.

2 each 6 Foot Steel Fence Posts set at 1st feet, East & South

Location & Comments

None.

Surveyor's Seal ^{From} _{Corner.}

Compass Declination 20°E

Firm/Agency Shaner

Engineering, Inc.

Address P.O. Box 1430

Roseburg, Oregon 97470

Party Chief B. Shaner

Notes " "

Witness David Snyder

Claude McLean

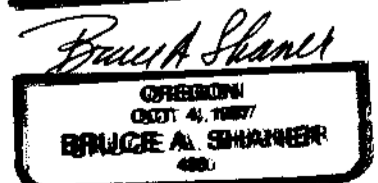

Renewed June 30,

C.S. File No. 65/33-LE

FILED

Date: 10/4/2000 By: JP

This survey consists of:

Map: M/32-51

Narrative: _____

Corner Rpt: CS 65/33-1F

OREGON CORNER RESTORATION FORM

Section 12 Township 31S Range 5W

County Douglas Date Oct. 3, 2000

DOUGLAS COUNTY
SURVEYOR

Corner Designation

1/4 S12
●
S13

- Condition Report Only
- Not Found
- Renewed
- Unrecorded
- Surveyed In
- Referenced Out

Previous Renewals/Surveys, etc.

U.S. B. L. M. 1973

Monument(s) & Accessories Found: (Condition and Source)

Found 3/4" Brass Cap on a 2 1/2" Iron Post, from which a:
26" D. Fir BT, face overgrown, bears N28°E, 29.0 feet.

18" D. Fir BT, " " , bears S30°E, 16.5 feet.

Monument Detail

Sketch

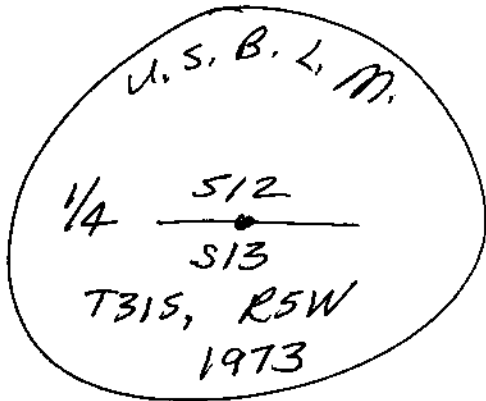

Monument Set (Procedures and Description)

None.

New Accessories

None.

Location & Comments

About 500 feet
West of BPA
Transmission Line
Tower.

Compass Declination 20°E

Firm/Agency Shaner
Engineering, Inc.

Address P.O. Box 1430
Roseburg, OR 97470

Party Chief B. Shaner

Notes " "

Witness David Snyder
Claude McLean

Surveyor's Seal

REGISTERED
PROFESSIONAL
LAND SURVEYOR

Bruce A. Shaner

OREGON
OCT. 4, 1957
BRUCE A. SHANER
430

Renew June 30,
2002

C.S. File No. 65/33-1F

FILED

Date: 10/4/2000 By: JP

This survey consists of:

Map: M 132-51

Narrative: _____

Corner Rpt: LS 65/33-1G

OREGON CORNER RESTORATION FORM

Section 12 Township 31S Range 5W

County Douglas Date Oct. 3, 2000

DOUGLAS COUNTY
SURVEYOR

Corner Designation

$\frac{1}{4}$ $\frac{51}{512}$

- Condition Report Only
- Not Found
- Renewed
- Unrecorded
- Surveyed In
- Referenced Out

Previous Renewals/Surveys, etc.

U.S. B.L.M. 1973

Monument(s) & Accessories Found: (Condition and Source)

Found 3 1/4" Brass Cap on a 2 1/2" Iron Post, from which a:
12" D. Fir BT, face overgrown, bears N 9° W (record
N 12° W), 40.9 feet.

26" D. Fir BT, face overgrown, bears S 61° W, 30.1 feet
(record 31.7 feet).

Monument Detail

Sketch

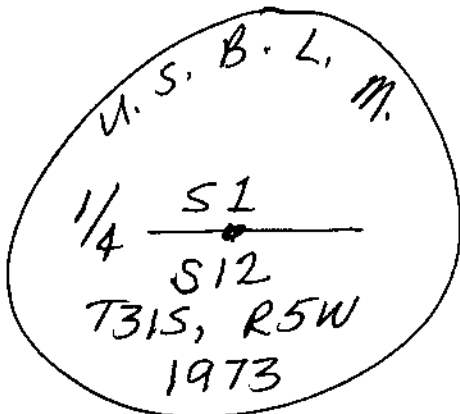

Monument Set (Procedures and Description)

None.

New Accessories

None.

Location & Comments

Corner is 200
feet South of
maid timber
access road at
timber cutting
corner

Compass Declination 20°E
Firm/Agency Shaner
Engineering, Inc.
Address P.O. Box 1430
Roseburg, Oregon 97470
Party Chief B. Shaner
Notes " "
Witness David Snyder
Claude McLean

Surveyor's Seal

REGISTERED
PROFESSIONAL
LAND SURVEYOR

Bruce A. Shaner

OREGON
OCT. 4, 1957
BRUCE A. SHANER
430

Renews June 30,
2002

C.S. File No. 65/33-1G

FILED

Date: 10/4/2000 By: JP

This survey consists of:

Map: M 132-51

Narrative: _____

Corner Rpt: CS 65/33-1H

OREGON CORNER RESTORATION FORM

Section 12 Township 31S Range 5W

County Douglas Date Oct. 2, 2000

DOUGLAS COUNTY SURVEYOR

Corner Designation

East 1/4 5

Section 12 Only

- Condition Report Only
- Not Found
- Renewed
- Unrecorded
- Surveyed In
- Referenced Out

Previous Renewals/Surveys, etc. _____

U.S. B.L.M., 1973

Monument(s) & Accessories Found: (Condition and Source)

Found 3 1/4" Brass Cap on a 2 1/2" Iron Post, from which a;
16" D. Fir BT, face overgrown bears S 41° W (Record
534 1/2° W), 42.2 feet. (Record). (Record size tree was 7")

14" (Record 6") D. Fir BT, face overgrown, bears
N 88° W, 42.2 feet (Record 40.3 feet).

Monument Detail

Sketch

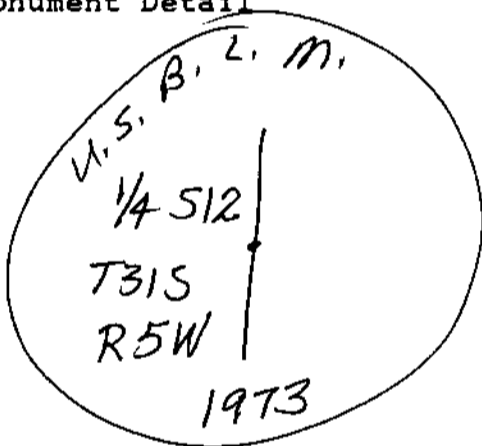

Monument Set (Procedures and Description)

None.

New Accessories

None.

Location & Comments

None.

Compass Declination 20° E

Firm/Agency Shaner

Engineering, Inc.

Address P.O. Box 1430

Roseburg, OR 97470

Party Chief B. Shaner

Notes _____

Witness David Snyder

& Claude McLean

Surveyor's Seal

REGISTERED
PROFESSIONAL
LAND SURVEYOR

Bruce A. Shaner
OREGON
OCT. 4, 1957
BRUCE A. SHANER
430

Renews June 30,
2002

C.S. File No. 65/33-1H