

Date: 8/24/2000 By: JC

This survey consists of:

Map: \_\_\_\_\_

Narrative: \_\_\_\_\_

Corner Fip: 65/30-22

OREGON CORNER RESTORATION FORM

Section 33 Township 22S Range 8W

County Douglas Date 6/15/00

DOUGLAS COUNTY SURVEYOR

Corner Designation

South 1/4 corner section  
33 only T22S, R8W,  
W.M.

- Condition Report Only
- Not Found
- Renewed
- Unrecorded
- Surveyed In
- Referenced Out

Previous Renewals/Surveys, etc. \_\_\_\_\_

Monument(s) & Accessories Found: (Condition and Source)

3 1/4" BLM Brass Cap

BT: 17" G. Fir bears N 76 1/2° E 25 1/4 ft healed face

BT: 24" D. Fir bears N 6° W 21 1/2 ft healed face

Monument Detail

Sketch

T22S R8W  
1/4 S 33

1962

Monument Set (Procedures and Description)

None

New Accessories

BT: 13" G. Fir Bears S 03° W 6 1/2 ft  
blazed and scribed X BT

BT: 22" D. Fir Bears S 31° E 16 1/2 ft  
blazed and scribed X BT

Location & Comments

Surveyor's Seal

All BT's have Compass Declination  
red painted bands Firm/Agency Ward  
and faces plus North West Inc  
yellow BT tags. Address P.O. Box 105  
Steel post set Florence OR 97439  
adjacent to Party Chief Rob Ward  
corner. Notes 00-33  
Witness Ron Rice

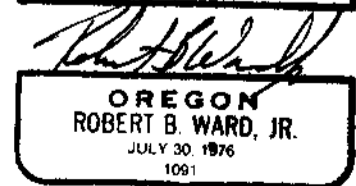
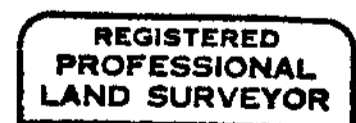

expires 6/30/02

C.S. File No. 65/30-22