

FILED

Date: 6-5-2000 By: JP

This survey consists of:

Map: M132-32

Narrative: _____

Corner Rpt: CS 65/30-11A

OREGON CORNER RESTORATION FORM

Section 15 Township 30S Range 6W

County Douglas Date May 25, 2000

DOUGLAS COUNTY SURVEYOR

Corner Designation

1/4S S15
 322

- Condition Report Only
- Not Found
- Renewed
- Unrecorded
- Surveyed In
- Referenced Out

Previous Renewals/Surveys, etc.

Mark Smalley for Roseburg Forest Products,
May 4, 1995, File 63/161-25

Monument(s) & Accessories Found: (Condition and Source)

Found Douglas Co. Surveyor Brass Cap on iron pipe from which a:
26" Oak BT, face of ground, bears N52°W (record N56 1/2°W), 31 1/2 feet.
24" Oak BT, face chopped out, bears N69°W (record N75°W), 14 1/2 feet.
24" Oak BT, face of ground, bears S9°E, 32 1/2 feet.
2B" Oak BT, face chopped out, bears S80°W, 22 1/2 feet.
14" Oak BT, scribes visible, bears S28°E, 40 1/2 feet.

Monument Detail

Sketch

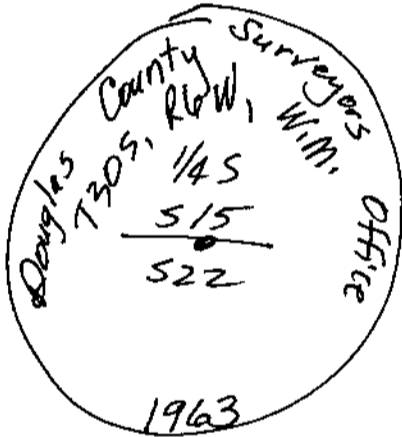

Monument Set (Procedures and Description)

N/A

New Accessories

N/A

Location & Comments

Corner on old
N-S fence.

Compass Declination 20°E

Firm/Agency Shaner

Engineering

Address P.O. Box 1430

Roseburg, Oregon 97470

Party Chief B. Shaner

Notes " "

Witness David Snyder

Surveyor's Seal

REGISTERED
PROFESSIONAL
LAND SURVEYOR

Bruce A. Shaner

OREGON
OCT. 4, 1957
BRUCE A. SHANER
430

Claude McLean Renews June 30,
2000

C.S. File No. 65/30-11A

FILED

Date: 6/5/2000 By: JP

This survey consists of:

Map: M 132-32

Narrative: _____

Corner Rpt: CS 65/30-11 B

OREGON CORNER RESTORATION FORM

Section 15 Township 30S Range 6W

County Douglas Date May 25, 2000

DOUGLAS COUNTY SURVEYOR

Corner Designation

CS 1/16
↓
Sec. 15

- Condition Report Only
- Not Found
- Renewed
- Unrecorded
- Surveyed In
- Referenced Out

Previous Renewals/Surveys, etc. _____

None

Monument(s) & Accessories Found: (Condition and Source)

None.

Monument Detail

Sketch

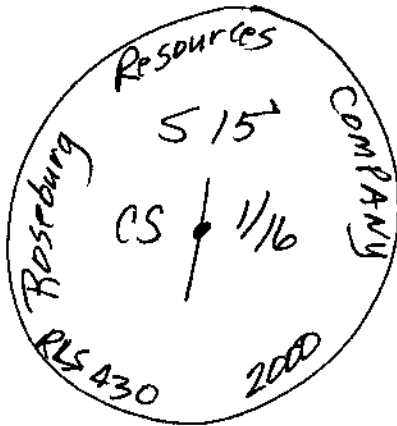

Monument Set (Procedures and Description)

I set a 1/2" x 40" Iron Rod with a 2 1/2" Alum. Cap from which a;

New Accessories

18" D. Fir BT, I scribed "S15 CS 1/16 BT" bears S34°W,
57° feet

18" D. Fir BT, I scribed "S15 CS 1/16 BT"
bears N1°E, 47° feet

I set 2 ea 6 foot Steel Posts, 1 @ East, 1 @ South, 1 @ feet.

Location & Comments

Surveyor's Seal

Near old fence Compass Declination 20°E

Corner fence going Firm/Agency Shaner

South & East from Engineering

Corner. Address P.O. Box 1430

Roseburg, OR 97470

Party Chief B. Shaner

Notes "

Witness David Snyder

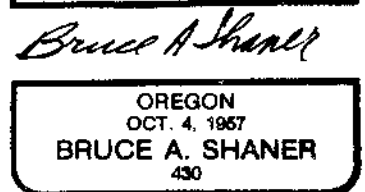
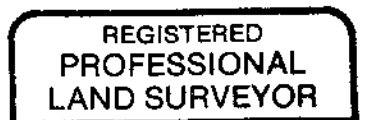

C.S. File No. 65/30-11 B

Renews June 30,
2000

FILED

Date: 6/5/2000 By: JP

This survey consists of:

Map: M 132-32

Narrative: _____

Corner Rpt: CS 65/30-11C

OREGON CORNER RESTORATION FORM

Section 15 Township 30S Range 6W

County Douglas Date May 25, 2000

DOUGLAS COUNTY SURVEYOR

Corner Designation

C¹/₄ +
Section 15

- Condition Report Only
- Not Found
- Renewed
- Unrecorded
- Surveyed In
- Referenced Out

Previous Renewals/Surveys, etc.

U.S. B.L.M. Survey by Wayne Rogers, 1988.

Monument(s) & Accessories Found: (Condition and Source)

Found Brass Cap on Stainless Steel Pipe, from which a
16" D. Fir BT, face overgrown, bears S42°E, 8 1/2 feet.

10" D. Fir BT, " " , bears S27°W, 2 1/2 feet.

Monument Detail

Sketch

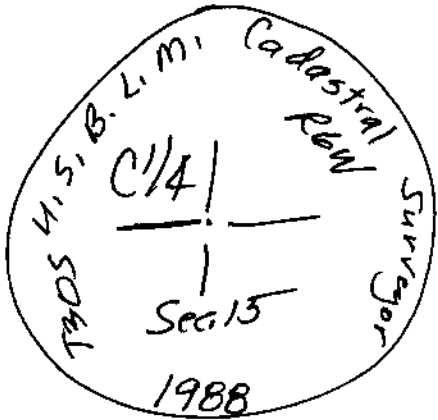

Monument Set (Procedures and Description)

N/A

New Accessories

None.

Location & Comments

On old N-S
fence.

Compass Declination 20°E

Firm/Agency Shaner
Engineering

Address P.O. Box 1430
Roseburg, Oregon 97470

Party Chief B. Shaner

Notes " "

Witness David Snyder

Claude McLean

C.S. File No. 65/30-11C

Surveyor's Seal

REGISTERED
PROFESSIONAL
LAND SURVEYOR

Bruce A. Shaner

OREGON
OCT. 4, 1957
BRUCE A. SHANER
430

Renews June 30,
2000

FILED

Date: 6/5/2000 by: JP

This survey consists of:

Map: M 132-32

Narrative: _____

Corner Rpt: C565/30-11D

OREGON CORNER RESTORATION FORM

Section 15 Township 30S Range 6W

County Douglas Date May 25, 2000

DOUGLAS COUNTY SURVEYOR

Corner Designation

S15	S14
S22	S23

- Condition Report Only
- Not Found
- Renewed
- Unrecorded
- Surveyed In
- Referenced Out

Previous Renewals/Surveys, etc. _____

U.S.G.L.D., Addison Flint, 1855.

Monument(s) & Accessories Found: (Condition and Source)

Found one BT, the one in Section 15 with reverse scribes visible "S15", in proper position on old N-S fence. See below.

No other evidence found

Monument Detail

Sketch

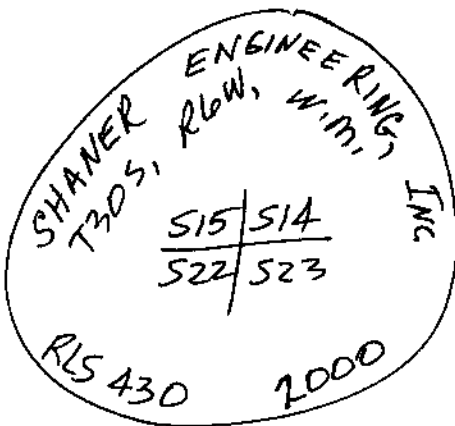

Monument Set (Procedures and Description)

Set 2 1/2" x 30" Alum. Pipe with 3/4" Alum. Cap from which a:

36" Black Oak, original BT, Reverse Scribe "S15" visible, bears N7°W, 48.8 feet. I have scribed this "T30S, R6W, S15, BT". (No other original BT's found.)

New Accessories

26" O. Fir BT, I scribed "T30S, R6W, S22, BT" bears S58°W, 31.4 feet.

12" Madrone BT, I scribed "T30S, R6W, S14, BT" bears N25°E, 15.8 feet.

16" O. Fir BT, I scribed "T30S, R6W, S23, BT" bears S60°E,

Location & Comments

On very old N-S fence, Compass Declination 20°E
Some 300 feet NE'ly, Firm/Agency Shaner
on contour, from Engineering
E'ly switchback of Address RD, Box 1430
new access road. Roseburg, Oregon 97470

Party Chief B. Shaner

Notes _____

Witness David Snyder

Claude McLean

C.S. File No. 65/30-11D

Surveyor's Seal 32.8 Feet.

REGISTERED
PROFESSIONAL
LAND SURVEYOR

Bruce A Shaner

OREGON
OCT. 4, 1957
BRUCE A. SHANER
430

Renewed June 30, 2000

Date: 6/5/2000 By: JP

This survey consists of:

Map: M 132-32

Narrative: _____

Corner Rpt: C565/30-11 E

OREGON CORNER RESTORATION FORM

Section 15 Township 30S Range 6W

County Douglas Date May 25, 2000

DOUGLAS COUNTY
SURVEYOR

Corner Designation

S 1/16
S15 | S14

- Condition Report Only
- Not Found
- Renewed
- Unrecorded
- Surveyed In
- Referenced Out

Previous Renewals/Surveys, etc. _____

None

Monument(s) & Accessories Found: (Condition and Source)

None.

Monument Detail

Sketch

"X"
on Rock Bluff

Monument Set (Procedures and Description)

Chiselled "X" on Rock Bluff.
*Painted it Red.

& from which a:

New Accessories

12" O. Fir BT, I scribed "S 1/16, S15, BT" bears
S89°W, 20 1/2 feet.

14" O. Fir BT, I scribed "S 1/16, S14, BT" bears
S16°E, 31 1/2 feet.

Location & Comments

Corner is 50 feet
West of old N-S
fence.
Corner is at inter-
section of newly
marked blazed
lines, from North
& West.

Compass Declination 20°E
Firm/Agency Shaner
Engineering
Address P.O. Box 1430
Roseburg, Oregon 97470
Party Chief B. Shaner
Notes " "
Witness David Snyder

Surveyor's Seal

REGISTERED
PROFESSIONAL
LAND SURVEYOR

Bruce A Shaner

OREGON
OCT. 4, 1957
BRUCE A. SHANER
430

Renews June 30,
2000.

FILED

Date: 6/5/2000 By: JP

This survey consists of:

Map: M 132-32

Narrative: _____

Corner Rpt: 6565/30-11E

OREGON CORNER RESTORATION FORM

Section 15 Township 30S Range 6W

County Douglas Date May 25, 2000

DOUGLAS COUNTY SURVEYOR

Corner Designation

1/4 S
S15 + S14

- Condition Report Only
- Not Found
- Renewed
- Unrecorded
- Surveyed In
- Referenced Out

Previous Renewals/Surveys, etc.

U.S. B.L.M. Survey by Wayne Rogers, 1988.

Monument(s) & Accessories Found: (Condition and Source)

Found Brass Cap or 2 1/2" Steel Pipe, from which a:

- 30" Madrone BT, healed face, bears S17 1/4° E, 52[±] feet.
- 20" D. Fir Stump^{BT}, 6 feet high, Sides Visible, bears S19° W, 2[±] feet.
- 12" D. Fir BT, face of growth, bears N 30° E (record N 23° E), 20[±] feet.
- 10" D. Fir BT, face of growth bears N 73 1/4° W, 26[±] feet.

Monument Detail

Sketch

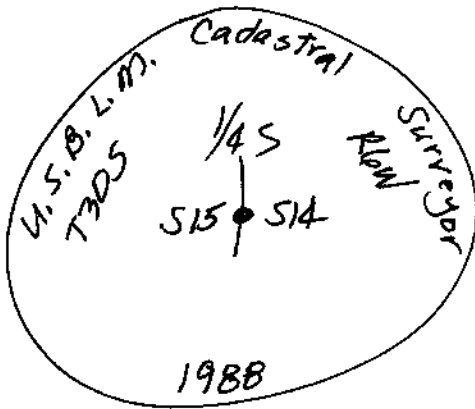

Monument Set (Procedures and Description)

N/A

New Accessories

None.

Location & Comments

ON N-S FENCE.

Compass Declination 20E

Firm/Agency Shaner

Engineering

Address P.O. Box 1430

Roseburg, Oregon 97470

Party Chief B. Shaner

Notes " "

Witness D. Snyder

C. McLean

C.S. File No. 65/30-11F

Surveyor's Seal

REGISTERED
PROFESSIONAL
LAND SURVEYOR

Bruce A. Shaner

OREGON
OCT. 4, 1957
BRUCE A. SHANER
430

Renew June 30, 2000