

Date: 2-17-2000 By: JC

This survey consists of:

Map: _____

Narrative: _____

Corner Rpt: 65/30-1

OREGON CORNER RESTORATION FORM

Section 22 Township 29S Range 8W

County DOUGLAS Date 1-31-00

DOUGLAS COUNTY
SURVEYOR

Corner Designation

N.W. SECTION CORNER
400400

- Condition Report Only
- Not Found
- Renewed
- Unrecorded
- Surveyed In
- Referenced Out

Previous Renewals/Surveys, etc. _____

Monument(s) & Accessories Found: (Condition and Source)

- 1958 D.C.S.O. I.P.B.C. SOLID IN GROUND
- 12" FIR N18 1/2 W 16° GOOD CONDITION - HEALED FACE
- 65" FIR STUMP S81E 12°
- 26" MADRONE N70E 30° GOOD CONDITION - HEALED FACE
- 15" - 9' TALL FIR SNAG N21E 68° AX MARKS NO SCRIBE WORK
- 18" L. CEDAR N82E 31° GOOD CONDITION - HEALED FACE
- 20" FIR S17W 29° GOOD CONDITION - HEALED FACE
- 24" FIR S33 1/2 E 120° GOOD CONDITION - HEALED FACE

Monument Detail

Sketch

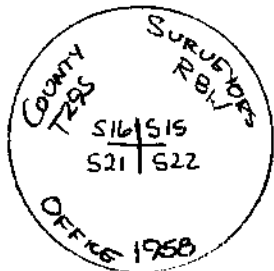

Monument Set (Procedures and Description)

New Accessories

Location & Comments

Surveyor's Seal

Compass Declination 19 1/2°

Firm/Agency ROSEBURG

FOREST PRODUCTS

Address PO Box 1088

ROSEBURG OR 97470

Party Chief BILL OLSON

Notes _____

Witness RALPH McMANUS

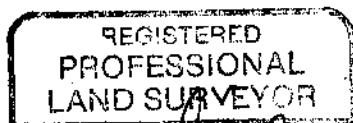

Mark F. Smalley
 OREGON
 JULY 28, 1983
 MARK F. SMALLEY
 2354

RENEWS 6-30-00

C.S. File No. 65/30-1