

27-7-2*

AFFIDAVIT OF CORRECTION (Plat)

2000-26098

I, *Wayne L. Rogers*, being duly sworn, depose and say that I am the surveyor who surveyed the property as depicted, filed and recorded as LAND PARTITION, 2000-0091, Douglas County, Oregon Plat Records; and

The following correction to said plat is necessary and is as follows:

The portion of the boundary of Parcel 1 shown as 50.16 feet, should be N.0° 00' 39" W., 50.16 feet.

The present users of the property materially affected by said Affidavit is as follows:

There is no affect to the owner.

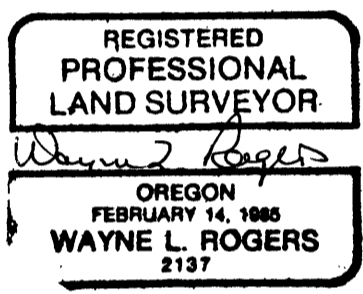

Expires 12/31/2000

STATE OF OREGON]
COUNTY OF DOUGLAS] 98
I, DOYLE SHAVER JR., COUNTY CLERK AND
RECORDER OF CONVEYANCES, DO HEREBY CERTIFY
THAT THIS INSTRUMENT WAS RECORDED

Wayne L. Rogers
Wayne L. Rogers, P.L.S.
License No. 2137

00 DEC 22 AM 8:40

DOYLE SHAVER JR.
DOUGLAS COUNTY CLERK

IN THE OFFICIAL RECORDS OF DOUGLAS COUNTY
BY *Heidi G. Bennett*
DEPUTY
FEE 16.00
81 FEE 10.00
26.00 ml

NOTARY CERTIFICATE

STATE OF OREGON
COUNTY OF DOUGLAS

Subscribed and sworn to before me this 21st day of DECEMBER, 2000.

[Signature]
Notary Public for the State of Oregon
My Commission Expires 1-19-2003



COUNTY SURVEYOR APPROVAL

I, *Romanso E. Ware*, Douglas County Surveyor, do hereby certify that said Affidavit of Correction for LAND PARTITION, 2000-0091, has been examined by me and that it complies with ORS 92.170.

FILED

Date: 1-2-2001 By: JP
This survey consists of:
FOR Map: 2000-0091
Narrative: _____
Corner Rpt: _____

Romanso E. Ware
Romanso E. Ware, County Surveyor

DOUGLAS COUNTY
SURVEYOR

HANDED SURVEYOR

2000-26098

C.S. File No. 65/28-13