

AFFIDAVIT OF CORRECTION (Plat)

I, *Wayne L. Rogers*, being duly sworn, depose and say that I am the surveyor who surveyed the property as depicted, filed and recorded as LONE OAK SUBDIVISION, PHASE II, *Volume 20, Page 28*, Douglas County, Oregon Plat Records; and

The following corrections to said plat are necessary and are as follows:

- (1) The 5.00 foot wide utility easement along the west side of Lot 23 will be deleted.
- (2) The 10.00 foot wide sewer easement along the west side of Lot 18 will be deleted.
- (3) A 10.00 foot wide utility easement is to be created over the westerly 10.00 feet of Lots 17, 18, and 23.

The present users of the property materially affected by said Affidavit is as follows:

There is no affect to the owner.

FILED

Date: 10/30/2000 By: JP
 This survey consists of:
 For Map: Vol 20 Pg 28
 Narrative: _____
 Corner Rpt: _____

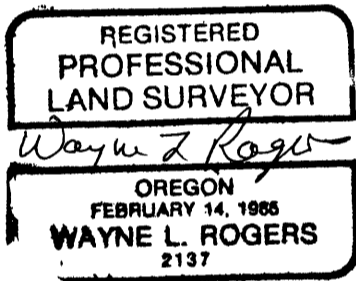

Expires 12/31/2000

NOTARY CERTIFICATE

STATE OF OREGON
COUNTY OF DOUGLAS

Subscribed and sworn to before me this 18th day of OCTOBER, 2000.

[Signature]
 Notary Public for the State of Oregon
 My Commission Expires 1-19-2003

Wayne L. Rogers
 Wayne L. Rogers, P.L.S.
 License No. 2137

DOUGLAS COUNTY SURVEYOR

DOYLE SHAVER JR.
DOUGLAS COUNTY CLERK

00 OCT 23 AM 8:00

IN THE OFFICIAL RECORDS OF DOUGLAS COUNTY

BY [Signature]

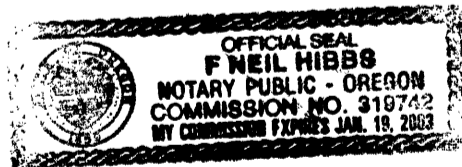

COUNTY SURVEYOR APPROVAL

I, *Romanso E. Ware*, Douglas County Surveyor, do hereby certify that said Affidavit of Correction for LONE OAK SUBDIVISION, PHASE II, *Volume 20, Page 28*, has been examined by me and that it complies with ORS 92.170.

[Signature]
 Romanso E. Ware, County Surveyor

Surveyor