

AFFIDAVIT OF CORRECTION (PLAT)

I, F. Neil Hibbs, being duly sworn, depose and say that I am the surveyor who surveyed the property as depicted, filed and recorded as Volume 20, Page 16, Douglas County, Oregon Survey Records; and

The following corrections to the Declaration of said plat are necessary and are as follows: Delete "ROADS AS SHOWN" and add "HEREBY DEDICATE TO THE PUBLIC THE STREETS AS PLATTED AND SHOWN HEREON."

The present fee owners of the property materially affected by said Affidavit is as follows: C. A. Galpin and John Schleining

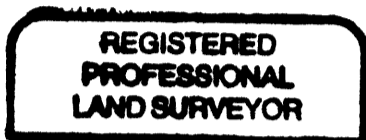

F. Neil Hibbs

F. Neil Hibbs, P.L.S.
License No. 52989

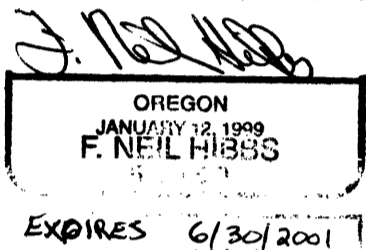

FILED

Date: 2/23/2000 By: JP

This survey consists of:

for Map: Vol 20 Pg 16

Narrative: _____

Corner Rpt: _____

NOTARY CERTIFICATE

STATE OF OREGON
COUNTY OF DOUGLAS

DOUGLAS COUNTY
SURVEYOR

Subscribed and sworn to before me this 7th day of FEBRUARY, 2000

Nancy A. Winchell
Notary Public for the State of Oregon
My Commission Expires 10/20/01

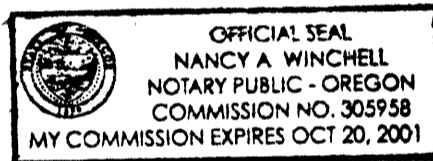

We are the owners of the land represented hereon and hereby consent to the corrections as shown hereon

C. A. Galpin
C. A. Galpin Date 2/2/00

John Schleining
John Schleining Date 2/2/00

NOTARY CERTIFICATE

STATE OF OREGON
COUNTY OF JACKSON

Subscribed and sworn to before me this 2nd day of FEBRUARY, 2000

Corrine E. Mahoney
Notary Public for the State of Oregon
My Commission Expires Oct 18, 2003

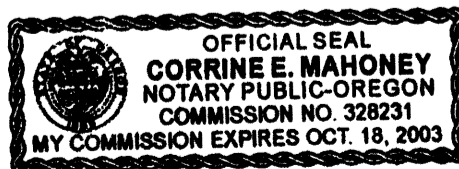

APPROVAL:

Jera Hunter 2/17/2000
Community Development Director Date
City of Sutherlin

COUNTY SURVEYOR APPROVAL

I, **Romanso E. Ware**, Douglas County Surveyor, do hereby certify that said Affidavit of Correction for **Volume 20, Page 16**, has been examined by me and that it complies with ORS 92.170.

Romanso E. Ware
Romanso E. Ware, County Surveyor

STATE OF OREGON |
COUNTY OF DOUGLAS | SS
I, DOYLE SHAVER JR., COUNTY CLERK AND
RECORDER OF CONVEYANCES, DO HEREBY CERTIFY
THAT THIS INSTRUMENT WAS RECORDED
00 FEB 23 AM 8:40
DOYLE SHAVER JR.
DOUGLAS COUNTY CLERK
IN THE OFFICIAL RECORDS OF DOUGLAS COUNTY
BY [Signature]
87 FEB 21
81 FEB 10
31

HANDED
Surveyor

2000-04375
C.S. File No. 02/20-13