

# GOVERNMENT CORNER VISITATION

CORNER SECTIONS 7, 8, 17 & 18 T. 25S. R. 2W., W.M.

EVIDENCE FOUND 3/4" DIAM. BLM BRASS CAP ON 2 1/2" DIAM. IRON PIPE, PROTRUDING 2" ABOVE GROUND LEVEL, SET FIRMLY IN PLACE, SET STEEL POST NORTH 1.0'

ACCESSORIES FOUND 53" FIR N. 65° W. 38.3' TO CTR. WITH CHOPPED OUT BLAZE  
FOUND 23" HEMLOCK STUMP N. 28° E. 137.0' TO CTR., PAINTED  
FOUND 22" HEMLOCK STUMP S. 76 1/2° E. 113.5' TO CTR., PAINTED  
NEW PTS: 8" D. FIR N. 62° E. 14.3' TO CTR. BLAZED & SCRIBED "T255 R2W S8 BT"  
8" D. FIR S. 71° E. 35.4' TO CTR. BLAZED & SCRIBED "T255 R2W S17 BT"  
9" D. FIR S. 80° W. 12.3' TO CTR. BLAZED & SCRIBED "T255 R2W S18 BT"

NOTES AND OTHER INFORMATION \_\_\_\_\_

BY: HARVEY M. CHRISTENSEN FIRM: NW TIMBERLAND CONSULTING INC.  
TITLE: PRESIDENT DATE: JANUARY 1999

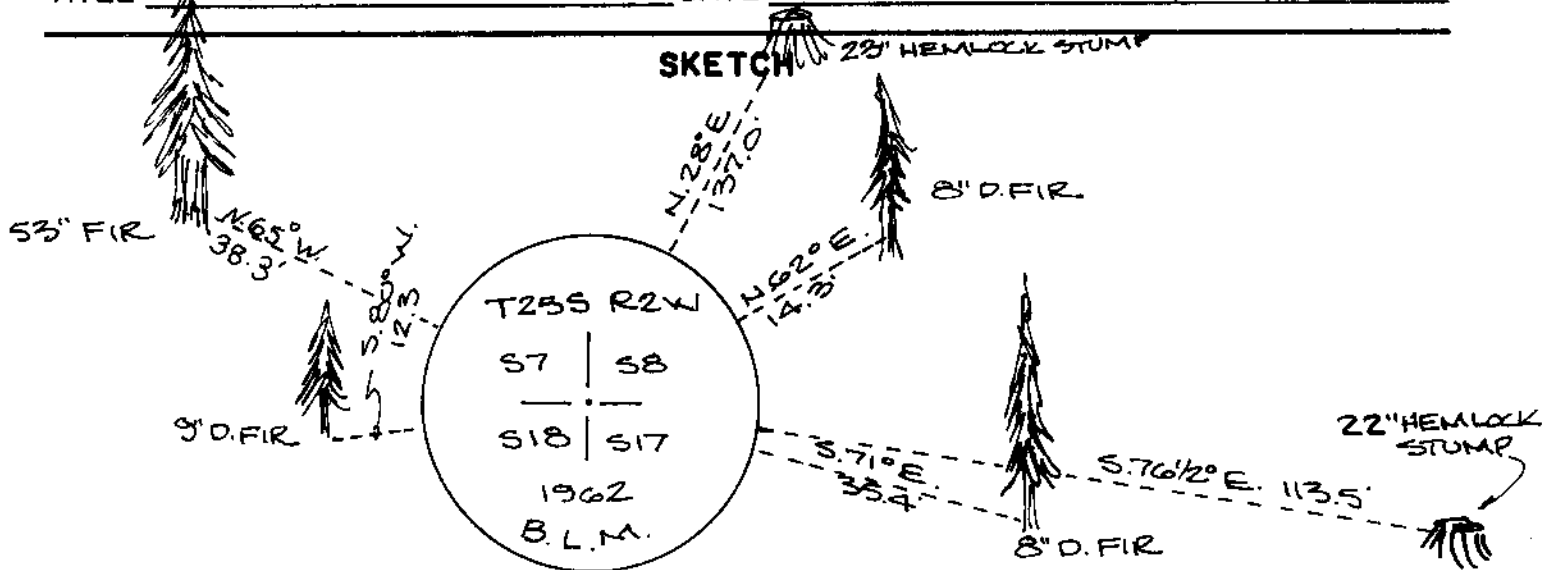

SECTION DIAGRAM GRID

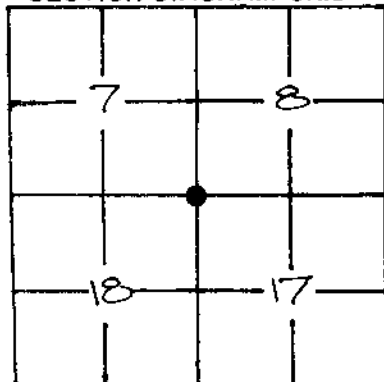

FILED

Date: 6-23-1999 By: JC  
This survey consists of:  
Map: \_\_\_\_\_  
Narrative: \_\_\_\_\_  
Corner Rpt: 65/23-12

DOUGLAS COUNTY SURVEYOR

SEAL

