

BTS ENGINEERING AND SURVEYING, INC.

CERTIFIED RECORD OF LAND CORNER MONUMENTATION

History of original corner establishment: This corner was originally established in 1968 by Thomas E. Shrum under Survey M 37-17 as follows:

Set a 2 1/2" dia. aluminum cap marked "T28S R2W 1/4 S6 RE 4287 1968"
Madrone 24" dia. N.46°E., 54.4' marked "1/4 S6 BT RE 4287"
Madrone 26" dia. S.79°E., 82.3' marked "1/4 S6 BT RE 4287"

T28S R3W R2W 1/4 S6

Description of corner evidence found:

A 1" (O.D.) iron pipe, firmly set, projecting 18" above the ground with a 2 1/2" aluminum cap stamped:

USPC PROP COR
T28S R2W
1/4 | 6
RE 4287
1968

from which bearing trees by Shrum in 1968 :
a 25" Madrone bears N.46°E., 54.4 ft. with illegible scribemarks visible.
a 24" Madrone bears S.79°E., 81.8 ft. with scribe marks "6 BT" visible.
(Rec. 82.3 ft.)

Description of monument and accessories I established to perpetuate the original location:

I paint a 6" red band and BT faces red and nail USFS "BEARING TREE" and "LAND SURVEY MONUMENT" signs to all bearing trees:
Magnetic declination: 20°E.
Witnesses: Les Fanning, Matt Dixon, Aaron Fanning

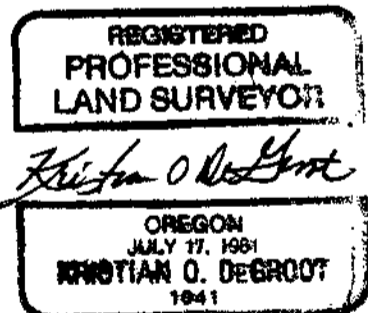

Exp 12/31/99

FILED

Date: 6/29/1998 By: JC

This survey consists of:

Map: _____

Narrative: _____

Corner Rpt: 65/20-37

DOUGLAS COUNTY
SURVEYOR