

R.M. 4-4

FILED

Date: 6/15/1998 By: JP

This survey consists of:

Map: RM 4-4

Narrative: \_\_\_\_\_

Corner Rpt: CS 65/20-23A

OREGON CORNER RESTORATION FORM

Section 29 Township 29S Range 7W

County Douglas Date May, 1998

DOUGLAS COUNTY  
SURVEYOR

Corner Designation

CS 1/16

- Condition Report Only
- Not Found
- Renewed
- Unrecorded
- Surveyed In
- Referenced Out

Previous Renewals/Surveys, etc. \_\_\_\_\_

None

Monument(s) & Accessories Found: (Condition and Source)

I set a 5/8" x 30" Iron Rod w/ 1 1/2" Alum. Cap, from which a:  
10" D. Fir BT, I scribed "CS 1/16 S29 BT" bears S14°W,  
117 feet.

12" D. Fir BT, " " " " " " " "  
bears N45°E, 15 feet.

6 Foot Steel Fence Post, bears West, 10 feet

" " " " " " , bears N45°W, 10 feet.

Monument Detail

Sketch

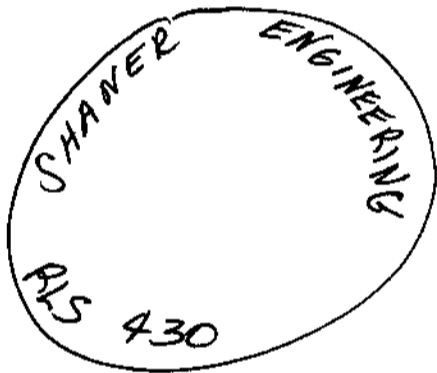

Monument Set (Procedures and Description)

See above.

New Accessories

See above.

Location & Comments

None.

Compass Declination 20°E

Firm/Agency Shaner

Engineering

Address P.O. Box 1430

Roseburg, OR 97470

Party Chief B. Shaner

Notes " "

Witness C. Berlier

B. Snyder

Surveyor's Seal

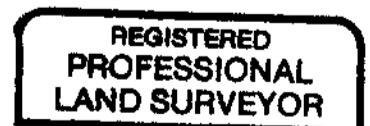

Bruce A. Shaner

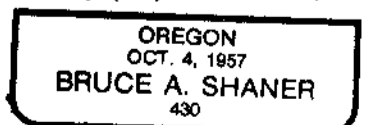

Renews June 30, 2000  
O.S. File No. 65/20-23A

Date: 6/15/98 By: JP

This survey consists of:

Map: R.M. 4-4

Narrative: \_\_\_\_\_

Corner Apt: C.S. 65/20-23 B

OREGON CORNER RESTORATION FORM

Section 29 Township 29S Range 7W

County Douglas Date May, '98

DOUGLAS COUNTY  
SURVEYOR

Corner Designation

C1/4

- Condition Report Only
- Not Found
- Renewed
- Unrecorded
- Surveyed In
- Referenced Out

Previous Renewals/Surveys, etc.

Set by Howard Johnstone in 1980, MB3-68.

Monument(s) & Accessories Found: (Condition and Source)

Found Same as Record

Monument Detail

Sketch

Monument Set (Procedures and Description)

New Accessories

Location & Comments

At <sup>NE</sup> Corner of  
Clearcut in SW 1/4  
Section 29,

Compass Declination 20°E

Firm/Agency Shaner  
Engineering

Address P.O. Box 1430  
Roseburg, OR 97470

Party Chief B. Shaner

Notes " "

Witness D. Snyder  
C. Berlier

Surveyor's Seal

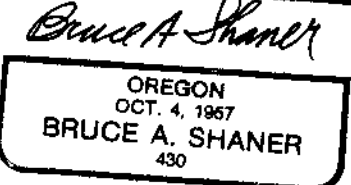

Renews June 30, 2000

C.S. File No. 65/20-23-B

R.M. 4-4

FILED

Date: 6/15/98 By: JP

This survey consists of:

Map: R.M. 4-4

Narrative: \_\_\_\_\_

Corner Rpt: C.S. 65/20-23 C

OREGON CORNER RESTORATION FORM

Section 29 Township 29S Range 7W

County Douglas Date May, 1998

DOUGLAS COUNTY  
SURVEYOR

Corner Designation

$\frac{1}{4}S \frac{529}{532}$

- Condition Report Only
- Not Found
- Renewed
- Unrecorded
- Surveyed In
- Referenced Out

Previous Renewals/Surveys, etc.

Douglas County Surveyor, Jim Byron, 1970  
Howard Johnstone, M 83-63, 1980

Monument(s) & Accessories Found: (Condition and Source)

Found U.S.G.L.O. Brass Cap, from which a:  
22" Oak BT, face o/b, bears N17°E, 59± feet.  
24" D. Fir BT, " " , bears N73°E, 54± feet.  
14" D. Fir BT, " " , bears S59°W, 19± feet (Record 204)

Monument Detail

Sketch

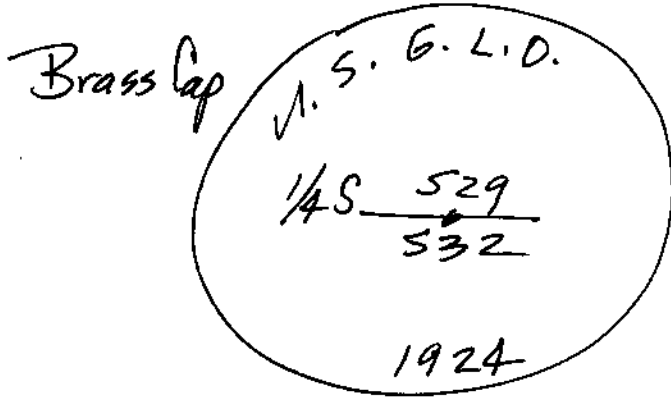

Monument Set (Procedures and Description)

None

New Accessories

Set 6 Foot Steel Fence Post, West, 10 Feet.  
" " " " " " , North, 10 Feet.

Location & Comments

None

Compass Declination 20°E

Firm/Agency Shaner

Engineering

Address P.O. Box 1430

Roseburg, OR 97470

Party Chief B. Shaner

Notes " "

Witness D. Snyder

C. Berlier

Surveyor's Seal

REGISTERED  
PROFESSIONAL  
LAND SURVEYOR

Bruce A. Shaner

OREGON  
OCT. 4, 1967  
BRUCE A. SHANER  
430

Renews June 30, 2000  
C.S. File No. 65/20-23 C