

BTS ENGINEERING AND SURVEYING, INC.Date: 3-17-1998 By: JC

This survey consists of: _____

Map: _____

Narrative: _____

Corner Rpt: 65/20-1 fCERTIFIED RECORD OF LAND CORNER MONUMENTATION**DOUGLAS COUNTY
SURVEYOR**

History of original corner establishment: This corner was originally established in 1930 by Otto L. Draper, U.S.G.L.O. Transitman, as follows:
Set an iron post, 3 ft. long, 1 in. diam., 27 ins. in the ground, for the ¼ sec. cor., with brass cap mkd.

1/4
S9 | S10
1930

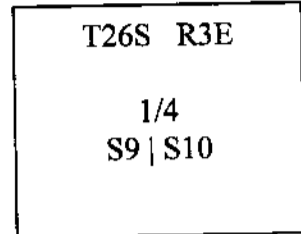

from which

A fir, 22 ins. diam., bears N.44°E., 53 lks. dist., mkd. ¼ S10 BT.

A fir 30 ins. diam., bears N.45°W., 46 lks. dist., mkd. ¼ S9 BT.

Gary L. Langlitz of the Douglas County Surveyor's Office restored the corner in 1976 as follows:

Found- 1" iron pipe, loosely set and extending 16" above grd., brass cap attached.

Cap is G.L.O. set 1930. Cap marked erroneously ¼ cor. secs. 3 and 10.

from which

Orig. B.T. 22" now 24" D.fir, N.44°E., 35.0 ft. alive and well healed.

Orig. B.T. 30" D.fir, now a 34" snag, N.45°W., 30.4 ft., scribe "S9 BT" on

unhealed face.

We reset the found monument 27" in the grd., and obliterate the erroneous markings on the cap. We restamp the monument to read as follows:

U.S. General Land Office Survey

T26S R3E
CS 1976
S9 | S10
1/4
1930

Marked a new bearing tree- 16" D.fir, S77 1/2° W., 35.3 ft., scribed "1/4 S9 CS BT" on a double blaze.

Description of corner evidence found: A 1" (O.D.) iron pipe, firmly set, projecting 8" above the ground with a 2 ½" brass cap stamped:

U.S. General Land Office

T26S R3E
CS 1976
S9 | S10
1/4
1930

from which bearing trees by Draper in 1930:

A 26" fire killed D.fir snag bears N.44°E., 35.0 ft. with a healed blaze.

A root hole with burnt fir remnants bears N.45°W., 30.4 ft.

and a bearing tree by Langlitz in 1976:

A 16" fire killed D.fir snag bears S.77°30'W., 35.3 ft. with a healed blaze.

Description of monument and accessories I established to perpetuate the

original location: I build a stone mound, 48" diam. base to top of monument and set new bearing objects as follows:

A 5/8"x30" iron rod, set 26" in the ground with plastic cap "BTS ENG-SURV" bears S.44°W., 20.0 ft. with a 6 ft. alum. post set alongside.

A 5/8"x30" iron rod, set 26" in the ground with plastic cap "BTS ENG-SURV" bears S.45°E., 20.0 ft. with a 6 ft. alum. post set alongside.

I paint a 6" red band and BT faces red and nail USFS "BEARING TREE" and "LAND SURVEY MONUMENT" signs to all bearing trees.

Magnetic declination: 20°E.

Witnesses: Les Fanning, Matt Dixon, Aaron Fanning

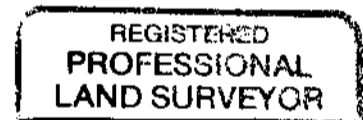

Kristian O. DeGroot

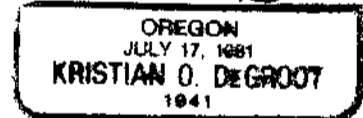

Expires 12/31/99