

REC'D JAN 14 1998

PUBLIC LAND CORNER

INDEX NO. _____

WEYERHAEUSER COMPANY WILLAMETTE REGION

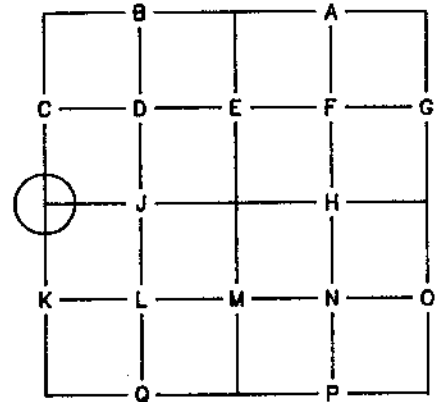

TOWNSHIP 23 S RANGE 3 W
 SECTION 28 CORNER W 1/4 CORNER
 COUNTY LANE/DOUGLAS OREGON

ORIGINAL CORNER DATED: 1882 BY: J.P. CURRIN

CORNER: POST

ACCESSORIES: # 8

24" FIR, N 10 E, 75 LKS.

24" HEMLOCK, S 40 W, 50 LKS.

REESTABLISHMENT NOTES DATED: 3/31/59 BY: M.D. HALE - WEYERHAEUSER CO.

EVIDENCE RECOVERED: 34" HEMLOCK STUMP, S 40 W, 33.0 FT. - FOUND PARTIAL FACE.

SCRIBING GONE MOSTLY DESTROYED BY LOGGING

FILED

CORNER SET: 1/2" X 34" GALV. IRON PIPE

ACCESSORIES ESTABLISHED: _____

30" CEDAR STUMP, N 75 W, 43.6 FT. TO "W" NAIL

39" HEMLOCK STUMP, S 70 E, 65.5 FT. TO "W" NAIL

REESTABLISHMENT NOTES DATED: UNKNOWN BY: UNKNOWN

EVIDENCE RECOVERED: _____

Date: 1-21-98 By: JP

This survey consists of:

Map: _____
Narrative: _____

Corner Rpt: C.S. 65/20-3

DOUGLAS COUNTY
SURVEYOR

CORNER SET: _____

ACCESSORIES ESTABLISHED: _____

BLM TAG, 54" X 30' FIR SNAG, N 10 E, 60' SLOPE DISTANCE TO CORNER

REESTABLISHMENT NOTES DATED: _____ BY: _____

EVIDENCE RECOVERED: _____

CORNER SET: _____

ACCESSORIES ESTABLISHED: _____

REMONUMENTATION

DATE: 1/8/98 BY: DAVID WELLMAN TITLE: PLS 2163 FIRM: BAKER & ASSOC.

EVIDENCE RECOVERED: 1/2" X 34" GALV. IRON PIPE

30" CEDAR STUMP, N 75 W, 43.6 FT. TO "W" NAIL

39" HEMLOCK STUMP, S 70 E, 65.5 FT. TO "W" NAIL

BLM TAG, 54" X 30' FIR SNAG, N 10 E, 60' SLOPE DISTANCE TO CORNER

CORNER SET: 1-1/2" X 30" IRON PIPE WITH 2-1/2" CAP DATED 1998

ACCESSORIES ESTABLISHED: _____

14" FIR, N 66 E, 23.7 FT. TO "W" NAIL - SCRIBED "1/4 S28"

18" FIR, S 33 E, 5.7 FT. TO "W" NAIL - SCRIBED "1/4 S28"

17" FIR, S 47-1/2 W, 15.8 FT. TO "W" NAIL - SCRIBED "1/4 S29"

20" FIR, N 43-1/2 W, 29.1 FT. TO "W" NAIL - SCRIBED "1/4 S29"

OTHER INFORMATION: _____

C.S. File No. 65/20-3 A

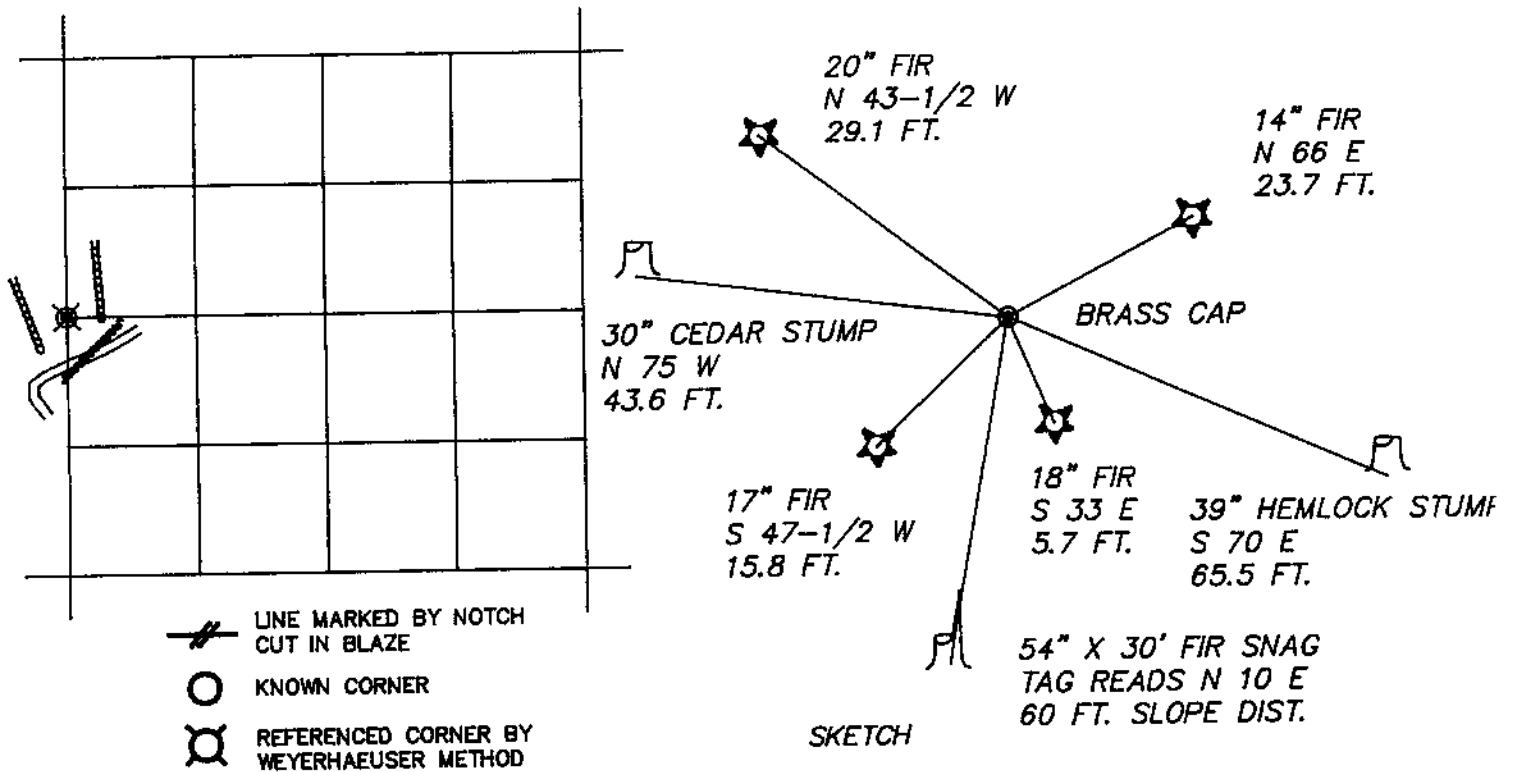

CORNER LIES IN SLIGHT DEPRESSION ON EASTERLY SIDE OF WIDE RIDGE.
ROAD SWITCHBACK AND LANDING BEARS N 65 W ABOUT 300 FT. DISTANT

WEYERHAEUSER COMPANY
CORNER REFERENCE METHOD

A "W" NAIL DRIVEN INTO A NOTCH LOW ON A TREE OR STUMP. TWO BLAZES SCRIBED AS APPROPRIATE TO CORNER LOCATION. AN ENSCRIBED BEARING TREE TAG PLACED HEAD HIGH WITH DISTANCE AND BEARING FROM THE "W" NAIL TO THE CORNER. PAINTED BAND ABOVE THE TAG.



IDENTIFIED ON PHOTO: SPINY-93 18A-7

INFORMATION ON CORNER AS NOW SET

GROUND COVER: SWORD FERN, OREGON GRAPE, CEDAR REPROD - FIR AND HEMLOCK TO 20"
 SLOPE FACE (BEARING) N 60 E (-) 67% %

FROM CORNER	NORTH	<u>-28% FOR 40' THEN STEEPER</u>
	SOUTH	<u>+36% FOR 40' THEN STEEPER</u>
	EAST	<u>-46% FOR 40'</u>
	WEST	<u>+ 57% FOR 180'</u>

BY: DAVID WELLMAN DATE: 1/8/98
 FIRM: BAKER & ASSOCIATES 1385 OAK SUITE 3
 ASSISTED BY: ERIN O'CONNOR EUGENE, OR 97401

COPIES TO: LANE COUNTY

ORS 672-025

REGISTERED PROFESSIONAL LAND SURVEYOR

David H. Wellman

OREGON JULY, 1985
DAVID H. WELLMAN
2163

EXPIRES 6/30/98