

# David A. Edwards - Professional Land Surveyor

P.O. Box 361  
Oakland, OR 97462



(541) 459-0512

SURVEY NUMBER M130-2

## SURVEY NARRATIVE TO COMPLY WITH CHAPTER 209, PARAGRAPH 250, OREGON REVISED STATUTES

SURVEY FOR: Roseburg Resources Co.  
P.O. Box 1088  
Roseburg, Oregon 97470

LOCATION: In Sections 26 and 27, T. 20 S., R. 7 W., W.M.  
in Douglas County, Oregon.

PURPOSE: To locate and monument certain boundaries in and  
around Sections 26 and 27 as shown on the  
accompanying map.

PROCEDURE: Utilizing existing control points and data  
established by this office on M 122-71 as well as  
additional ties to controlling corners, the  
necessary computations were made. Random  
traverses were then run along the boundaries to  
be marked. After prudent adjustment the random  
points were then offset to true line and the true  
line was blazed on each side and steel posts were  
set along the line. Red flagging was placed along  
all blazed lines and the blazes painted red. The  
East and West 1/4 corners of Section 27 were set  
by single proportion. These corners were searched  
for during M 122-71. Monuments set on this survey  
are described on the accompanying map and are  
stamped according to the 1972 B.L.M. Manual.  
Bearing trees are scribed according to said  
Manual, are measured to the center of tree at  
root crown and are situated as follows:

At the West 1/4 Corner of Section 27:

An 8" diam. Chinquapin brs. N.78°E., 15.22 ft.  
A 7" diam. Fir bears S. 40° W., 16.33 feet.  
A 10" diam. Fir bears S.88 1/2°W., 20.14 feet.  
A 10" diam. Chinquapin brs. N.52°W., 6.15 ft.

At the South 1/16 Cor. to Sections 27 and 28:

An 11" diam. Cedar brs. N. 63° E., 7.60 feet.  
A 10" diam. Cedar bears N. 2° W., 17.30 feet.

At the SW 1/16 Corner of Section 27:

A 6" diam. Fir bears N. 51° E., 15.10 feet.  
A 6" diam. Hemlock brs. N.78°W., 8.94 ft.

FILED

Date: 7-9-1998 By: DC

This survey consists of:

Map: M130-2

Narrative: 65/18-2 A-B

Corner Rpt: \_\_\_\_\_

DOUGLAS COUNTY  
SURVEYOR

# David A. Edwards - Professional Land Surveyor

P.O. Box 361  
Oakland, OR 97462



(541) 459-0512

At the CS 1/16 Corner of Section 27:

A 12" diam. Hemlock brs. S.37°W., 20.50 ft.  
A 6" diam. Fir bears N. 62° W., 20.10 feet.

At the West 1/16 Cor. to Sections 27 and 34:

An 11" diam. Alder brs. N.5 1/2°E., 13.55 ft.  
A 13" diam. Alder brs. S. 29° E., 22.59 feet.  
A found "T-iron" brs. N.10°30'E., 2.00 feet.

At the East 1/4 Corner of Section 27:

A 10" diam. Alder brs. N. 25° E., 57.20 feet.  
A 13" diam. Alder brs. S. 39° E., 12.38 feet.  
An 18" diam. Ash brs. S. 20° W., 53.30 feet.  
A 24" diam Ash bears N. 59° W., 7.00 feet.

At the Center 1/4 Corner to Section 26:

An 11" diam. Hemlock brs. N.67°E., 9.30 feet.  
A 13" diam. Alder brs. S. 3° E., 57.40 feet.  
A 19" diam. Alder brs. S. 75° W., 11.42 feet.  
A 10" diam. Hemlock brs. N. 6° W., 20.48 ft.

At the Corners to the Exception Tract:

Corner No. 1:

An 8" diam. Fir bears N. 43° E., 17.53 feet.  
A 13" diam. Fir bears N. 46° W., 26.01 feet.

Corner No. 2:

A 6" diam. Hemlock brs. S. 4° E., 11.29 feet.  
A 13 diam. Hemlock brs. N. 87° W., 14.69 ft.

Corner No. 3:

A 12" diam. Hemlock brs. S.16°E., 30.86 feet.  
An 11" diam. Alder brs. S. 59° W., 12.15 ft.

Corner No. 4:

A 10" diam. Alder brs. N. 29° W., 9.01 feet.  
An 8" diam. Cedar brs. S. 27° E., 15.40 ft.

Trees at the exception tract corners are  
scribed "PC BT" on a single blaze.

BASIS OF BEARINGS: Original G.L.O. as shown on the accompanying map.

EQUIPMENT: Nikon DTM 430 Electronic Total Station.

DATE COMPLETED: June 30, 1998.

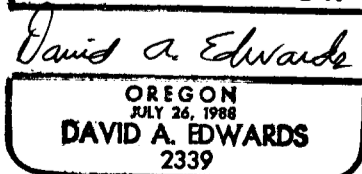
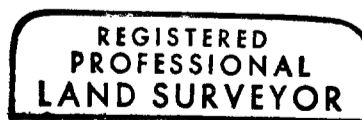

Expires 12/31/99

FILED

Date: 7-9-1998 By: SC  
This survey consists of:  
Map: M130-2  
Narrative: 65/18-2 A+B  
Corner Rpt: \_\_\_\_\_

DOUGLAS COUNTY  
SURVEYOR