

David A. Edwards - Professional Land Surveyor

P.O. Box 361
Oakland, OR 97462



(541) 459-0512

SURVEY NUMBER M 128-43

SURVEY NARRATIVE TO COMPLY WITH CHAPTER 209, PARAGRAPH 250,
OREGON REVISED STATUTES

SURVEY FOR: Scott Timber Company
P.O. Box 1088
Roseburg, Oregon 97470

LOCATION: In Section 12, T. 29 S., R. 4 W., W.M. in Douglas
County, Oregon.

PURPOSE: To locate and monument certain boundaries in and
around Section 12 as shown on the accompanying
map.

PROCEDURE: A series of looped control traverses were
executed which tied in the necessary controlling
corner monuments. After prudent adjustment the
random points were then offset to true line and
the true line was blazed on each side and steel
posts were set along the line. Red flagging was
placed along all blazed lines and the blazes
painted yellow. A thorough search was made for
original evidence of the North 1/4 corner to no
avail. This corner was therefore proportioned as
shown. Section 12 was subdivided pursuant to the
1973 B.L.M. Manual of Instructions. Monuments set
on this survey consist of 5/8" x 30" steel pins
with an aluminum cap mkd. "Roseburg Resources
Company" and "LS 2339" and "1998" together with
the stamped information called for in said
Manual. Bearing trees are scribed according to
said Manual, are measured to the center of tree
at root crown and are situated as follows:

At the North 1/4 Corner of Section 12:

A 6" diam. Fir bears N. 3° E., 1.08 feet.
A 10" diam. Fir bears S. 51° E., 15.27 feet.
An 8" diam. Fir bears S. 2° W., 18.25 feet.
An 8" diam. Fir bears N. 81° W., 15.13 feet.

At the West 1/16 Cor. to Sections 1 and 12:

A 7" diam. Fir bears N. 19° E., 19.85 feet.
A 6" diam. Fir bears S. 74° E., 13.85 feet.

At the CN 1/16 Corner of Section 12:

A 7" diam. Fir bears West, 7.50 feet.
A 9" diam. Fir bears N. 5 1/2° W., 16.29 ft.

FILED

Date: 3/31/98 By: JD

This survey consists of:

Map: M 128-43

Narrative: CS 65/18-1A#B

Corner Rpt: _____

DOUGLAS COUNTY
SURVEYOR

David A. Edwards - Professional Land Surveyor

P.O. Box 361
Oakland, OR 97462



(541) 459-0512

At the CW 1/16 Corner of Section 12:

A 13" diam. Fir bears S. 16° E., 6.70 feet.
A 15" diam. Fir bears N. 82° W., 4.40 feet.

At the Center 1/4 Corner of Section 12:

A 7" diam. Fir bears N. 32° E., 7.98 feet.
A 6" diam. Fir bears S. 31° E., 19.87 feet.
A 16" diam. Fir brs. S. 50° W., 14.20 feet.
A 16" diam. Fir brs. N. 63° W., 18.00 feet.

At the CS 1/16 Corner of Section 12:

A 6" diam. Cedar bears N. 66° E., 10.50 feet.
An 8" diam. Fir bears S. 17° E., 29.85 feet.

At the West 1/16 Cor. to Sections 12 and 13:

A 9" diam. Fir bears N. 32° E., 23.60 feet.
A 12" diam. Fir bears S. 57° E., 19.00 feet.

At the North 1/16 Cor. to Section 12 only:

A 6" diam. Cedar bears S. 3° W., 24.54 feet.
A 6" diam. Fir bears S. 73° W., 24.58 feet.

At the SW 1/16 Cor. to Section 12:

A 6" diam. Fir bears S. 56° W., 12.80 feet.
A 13 diam. Fir bears N. 40° W., 31.00 feet.

For the bearing trees bearings were measured with hand compass with declination set at 18° East.

BASIS OF BEARINGS: B.L.M. resurvey as shown on the accompanying map.

EQUIPMENT: Nikon DTM-A10LG Electronic Total Station.

DATE COMPLETED: March 24, 1998.

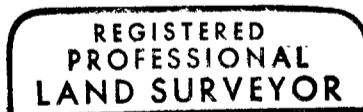

David A. Edwards

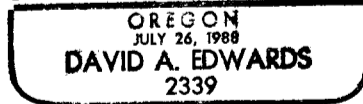

Expires 12/31/99