

CSF 64709

FILED

Date: 11-18-97 By: BC

This survey consists of:

Map: _____

Narrative: _____

Corner Rpt: CS 6515-21

DOUGLAS COUNTY SURVEYOR

C.S. File No. 6515-21

TWP. 20 S. R. 4 W.

TWP. 21 S. R. 4 W.

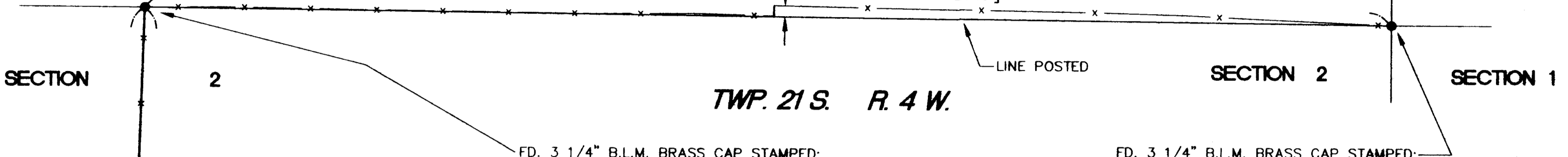
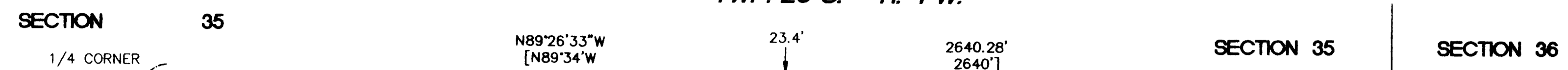

FD. 3 1/4\" B.L.M. BRASS CAP STAMPED:
T20S R4W
S 35 |
1/4 S 2 |
T21S R4W
1971

FD. 3 1/4\" B.L.M. BRASS CAP STAMPED:
T20S R4W
S 35 | S 36
S 2 | S 1
T21S R4W
1971

FROM WHICH:
A 17\" FIR SNAG BEARS N17°W 25.1' (TO FACE)
SCRIBING VISIBLE
A 18\" D. FIR BEARS N4°W 29.9' (S.C.)
HEALED FACE
A 19\" D. FIR BEARS N55°W 51.4' (S.C.)
HEALED FACE
A 17\" D. FIR BEARS S53°W 9.2' (S.C.)
HEALED FACE
A 27\" D. FIR STUMP BEARS S29°E 19.8',
VERY ROTTEN

FROM WHICH:
A 33\" FIR STUMP BEARS S4°W 33.0'
ROTTEN FACE
A 6\" BURNT CEDAR STAUB BEARS N25°W 54.1'
VERY ROTTEN
A 24\" D. FIR BEARS N58°E 6.5' (S.C.)
HEALED FACE
A 22\" D. FIR STUMP BEARS S52°E 18.8'
OPEN FACE, \"W\" NAIL VISIBLE
A 33\" D. FIR STUMP BEARS S15°W 33.0'
NO MARKS VISIBLE
A 45\" D. FIR STUMP BEARS N43°W 31.0'
HEALED FACE
A 16\" I. CEDAR BEARS N19°E 16.5'
HEALED FACE
A 23\" W. FIR BEARS S21°E 18.5'
HEALED FACE
A 7\" D. FIR BEARS N53°W 15.0'
HEALED FACE

LEGEND

- O SET 5/8\" x 30\" REBAR W/RED PLASTIC CAP MARKED \"GEOMAX INC.\"
- FD. MONUMENT AS NOTED
- CSF COUNTY SURVEY FILE NUMBER
- RXX/XX REEL NUMBER/DOCUMENT NUMBER, LANE COUNTY DEED RECORDS
- YPC YELLOW PLASTIC CAP
- S.C. SIDE CENTER MEASUREMENT
- () RECORD DATA PER CSF 27827
- [] RECORD DATA PER BUREAU OF LAND MANAGEMENT DEPENDENT RESURVEY OF T20S, R4W, W.M.; PLAT DATED 09/16/77
- { } RECORD AND/OR CALCULATED DATA PER G.L.O. PLAT OF T21S, R4W, W.M. DATED FEBRUARY 20, 1856
- x - FENCELINE

DOUGLAS COUNTY OF DOUGLAS COUNTY

BEARINGS
2659.80'
2659.46'

BASIS
N01°47'49\"E
(N01°47'49\"E)

1324.46'
{19.84 CH., CALC.}

1336.14'
{20 CH.}

LOT 2
{39.54 AC.}

DOUGLAS COUNTY

LANE COUNTY

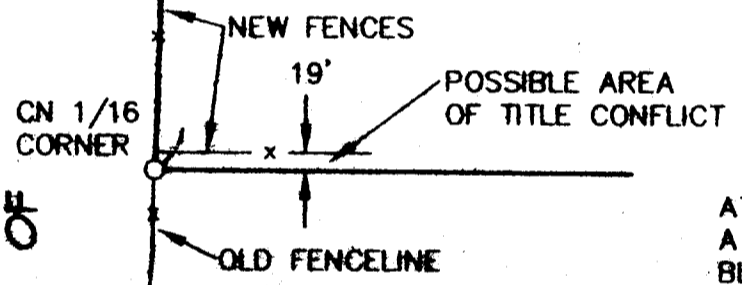

AT THE CN 1/16 CORNER:
A 20\" D. FIR BEARS S63°E 22.3' (S.C.)
BLAZED & SCRIBED \"CN1/16 S2\"
A 13\" D. FIR BEARS N42°E 12.1' (S.C.)
BLAZED & SCRIBED \"CN1/16 S2\"
A FENCE CORNER BEARS N2°W 18.4'

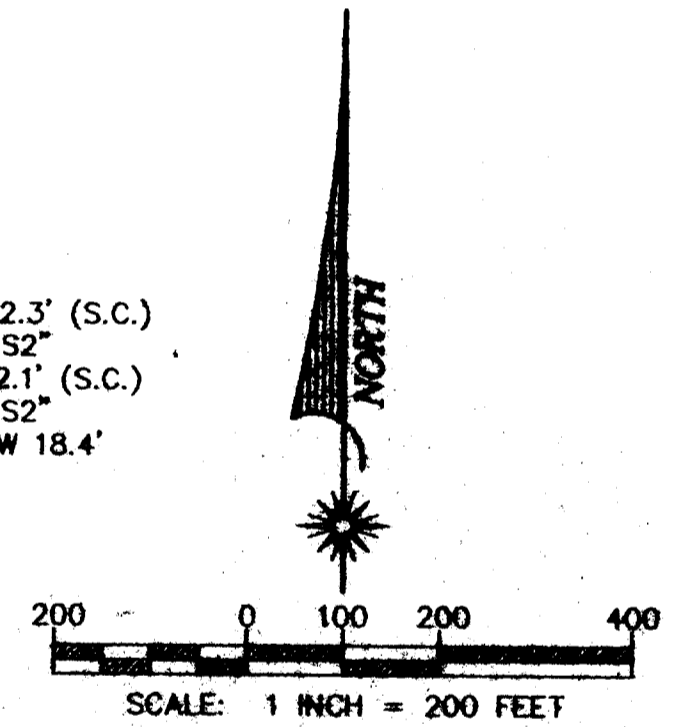

SURVEY REFERENCES

CSF 27827
G.L.O. PLAT OF T21S,
R4W, W.M., DATED FEB.
20, 1856
B.L.M. PLAT OF DEPENDENT
RESURVEY OF T20S, R4W,
W.M., DATED SEP. 16, 1977

REGISTERED
PROFESSIONAL
LAND SURVEYOR
[Signature]
OREGON
JUNE 30, 1997
KIRK F. ADKINS
02814LS
EXPIRES 12-31-97
11/4/97

PROPERTY OWNERS:
ARCHIE & MARJORIE HILL
30550 KENADY LANE
COTTAGE GROVE, OR 97424

**BOUNDARY SURVEY
FOR
ARCHIE HILL
NE1/4, SEC. 2,
T21S, R4W, W.M.,
LANE COUNTY, OR
T. L. 21-04-02-100, 200 & 300**

Geomax
INC.

ENGINEERING, LAND SURVEYING, BUILDING DESIGN
806 N. NINTH STREET COTTAGE GROVE, OREGON 97424
TELEPHONE- (541) 942-0126 FAX- (541) 942-7935
E-MAIL: geomax@ibm.net

JOB NO.: 97234	DRAWN: K.F.A.	CHECKED: K.F.A.
DATE: 10/09/97	REV.	

NARRATIVE

THE PURPOSE OF THIS SURVEY IS TO SET THE SOUTHWEST CORNER (THE CN 1/16) OF THAT TRACT OF LAND DESCRIBED IN R1719/9145994, AND TO STAKE THE NORTHERLY LINE OF SEC. 2 BETWEEN THE N 1/4 CORNER AND THE NE CORNER. THE BASIS OF BEARINGS IS THE NORTH-SOUTH CENTERLINE OF SEC. 2 BETWEEN THE 1\" IRON PIPE FOUND AT THE CENTER 1/4 CORNER AND THE BLM BRASS CAP FOUND AT THE N 1/4 CORNER, AND BEING NORTH 01°47'49\" EAST PER CSF 27827. NOTE THAT THE DESCRIPTION IN R1719/9145994 CALLS THE SUBJECT TRACT TO BE THE \"NW 1/4 OF THE NE 1/4 OF SEC. 2, T21S R4W...\", WHILE THE ORIGINAL GLO PLAT SHOWS THE SUBJECT TRACT TO BE A NON-ALIQUOT LOT (CALLED LOT 2 HEREON FOLLOWING STANDARD PRACTICE) NOMINALLY CONTAINING 39.54 ACRES. THE CN 1/16 WAS SET AND MAPPED HEREON TO CONFORM TO THE ORIGINAL GLO LOTTING, AND WAS LOCATED AT 20 CHAINS, PROPORTIONATE MEASURE, FROM THE CENTER 1/4 CORNER. THE SECTION LINE WAS POSTED WITH 60D NAILS, LATH AND FLAGGING FOR FUTURE FENCE RECONSTRUCTION.

FD. 1\" IRON PIPE W/YPC STAMPED:
\"GUILLE PLS 472\", PER CSF 27827,
FROM WHICH:
A 11\" D. FIR BEARS S63°W 18.5' (S.C.)
HEALED FACE;
A 12\" D. FIR BEARS N40°W 20.3' (S.C.)
HEALED FACE.

T. L. 21-04-02-100, 200 & 300

97234B.DWG 10/15/97

This survey submitted for CORNER REPORT PURPOSES ONLY.

C.S. File No. 6515-21