

AFFIDAVIT OF CORRECTION (Plat)

I, Mark A. Heimbürger, being duly sworn, depose and say that I am the surveyor who surveyed the partition plat as filed and recorded as Number 1996-0013 A & B, Douglas County, Oregon Plat Records; and

The following correction to said plat is necessary and is as follows:

Change "25.00 wide access and utility easement to benefit Parcel 2 and 3" to "25.00 wide access and utility easement to benefit Parcel 2."

The present fee owners of the property materially affected by said Affidavit are as follows:

Jimmie Hanna and Vivian Hanna

FILED

Date: 7-3-97 By: JP
This survey consists of:
Map: 1997-0013
Narrative:
Corner Rpt: C.S. 65/14-8

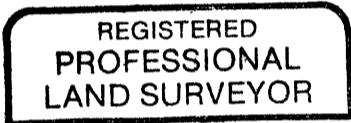

Mark A. Heimbürger

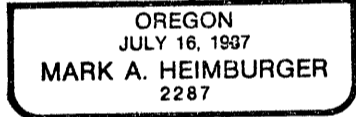

Exp. 6-30-99

Mark A. Heimbürger

DOUGLAS COUNTY SURVEYOR

Mark A. Heimbürger
Registered Professional Land Surveyor #2287
AA Surveying Service, Inc.
3076 N.E. Diamond Lake Blvd.
Roseburg, OR 97470

NOTARY CERTIFICATE

STATE OF OREGON)
COUNTY OF DOUGLAS) ss

Subscribed and sworn to before me this 1st day of July, 1997

Carole M. Cody
Notary Public for the State of Oregon
My Commission Expires 7-19-99



STATE OF OREGON) ss.
COUNTY OF DOUGLAS)
COUNTY CLERK AND RECORDER OF
CONVEYANCES, DO HEREBY CERTIFY THAT THIS
INSTRUMENT WAS RECORDED
97 JUL -3 AM 9:19
DOYLE SHAWER JR.
DOUGLAS COUNTY CLERK
IN THE OFFICIAL RECORDS OF DOUGLAS COUNTY
BY *Carole M. Cody* DEPUTY
FEE 5/10/15

HANDED

COUNTY SURVEYOR APPROVAL

I, Romanso Ware, Douglas County Surveyor, do hereby certify that said Affidavit of Correction for Partition Plat 1996-0013 has been examined by me and that it complies with ORS ~~209.275~~ 92.170.

Romanso E. Ware
Romanso Ware