

97-12846 AFFIDAVIT OF CORRECTION (Plat)

BOOK 1478 PAGE 777

I, Donald A. Bentz, being duly sworn, depose and say that I am the surveyor who surveyed the property as depicted, filed and recorded as Partition Plat No. 1997-0047, Douglas County, Oregon Survey Records; and

The following correction to said plat is necessary and is as follows:

The property lies in the Northwest 1/4 of Section 21, not the Northeast 1/4 of section 21, as the plat indicates in the title block.

The present fee owner of the property materially affected by said Affidavit is as follows:

Bill Stiles, President  
United Bancorp

  
Donald A. Bentz, P.L.S.  
License No. 839

Expires

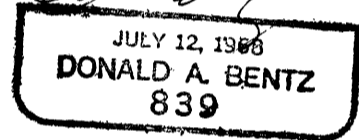
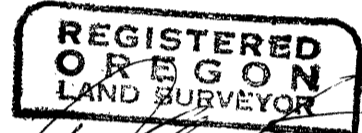

12/31/97

NOTARY CERTIFICATE

STATE OF OREGON  
COUNTY OF DOUGLAS

Subscribed and sworn to before me this 19<sup>th</sup> day of JUNE, 1997.

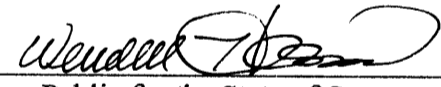
  
Notary Public for the State of Oregon  
My Commission Expires 1-18-99

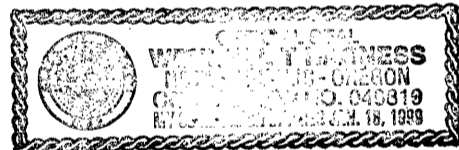

COUNTY SURVEYOR APPROVAL

FILED

Date: 6-23-97 By: JP  
This survey consists of:  
for Map: 1997-0047  
Narrative: \_\_\_\_\_  
Corner Ppt: \_\_\_\_\_

DOUGLAS COUNTY  
SURVEYOR

STATE OF OREGON ]  
COUNTY OF DOUGLAS ] SS.  
I, , COUNTY CLERK AND RECORDER OF  
CONVEYANCES, DO HEREBY CERTIFY THAT THIS  
INSTRUMENT WAS RECORDED

97 JUN 23 AM 8:11

DOYLE SWAYER JR.  
DOUGLAS COUNTY CLERK

IN THE OFFICIAL RECORDS OF DOUGLAS COUNTY

BY   
DEPUTY  
(81) ✓ FEE 5.00  
15.00

I, Romanso E. Ware, Douglas County Surveyor, do hereby certify that said Affidavit of Correction for Partition Plat No. 1997-0047 has been examined by me and that it complies with ORS 92.170.

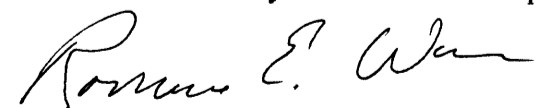
  
Romanso E. Ware, County Surveyor

C.S. File No. 65/14-7  
97-12846

✓ SURVEYOR