

GOVERNMENT CORNER RESTORATION FORM

FILED

Date: 9.5.96 By: PC

This survey consists of:

Township 31S Range 7W Sec. 29 County DOUGLAS

State OR Date 8-28-96 No. _____

Narrative: _____

Corner Rpt: 65/9-2

Corner Designation

S30	S29
S31	S32

DOUGLAS COUNTY SURVEYOR

- Condition Only
- Not Found
- Renewed
- Unrecorded
- Surveyed In
- Referenced Out

MONUMENT DETAIL

Previous Renewals 1963 DCSO PI # 200200

Monument(s) Found: (Condition and Source)

2 1/2" BRASS CAP ON 1 1/2" O.D. IRON PIPE PROTRUDES 18" ABOVE GROUND (1963 DCSO)

COUNTY SURVEYORS OFFICE

T 31 S
 S30 | S29
 S31 | S32
 1963

Accessories Found:

- 14" NOW 14" DIA. DOWN AND ROTTING MADRONE (FELL ON FACE) CENTER OF ROOTS BEARS S 81° W, 28.4 FT (AGREES WITH REC.) OBT
- 14" NOW 20" DIA 1 FT HIGH D. FIR STUMP, NO BARK SCRIBING VISIBLE, BEARS S 58° E 9.2 FT (AGREES WITH REC.) OBT
- 16" NOW 24" DIA. DIENG CEDAR, AXE MARKS ON BARK NO BLAZES VISIBLE, BEARS N 36° W, 37.6 FT (AGREES WITH 1963 DCSO REC.) OBT
- 8" LIVE OAK NOW ROOT HOLE NEAR REC " N 65° E, 16.9 FT " 1963
- 8" NOW 18" DIA. DOWN D. FIR, FACE BURIED UNDER SOIL REC " S 63° W, 34.3 HITS NORTH EDGE OF ROOT HOLE. 1963

U.S. GEO. SURV. 65/9-2

✓ 200200

RENEWAL

Monument Set (Procedure and Description)

N/A

Monument Detail

N/A

New Accessories

- 22" DIA. D. FIR DOUBLE BLAZED AND SCRIBED "T315 R7W S31 CS BT"
 - BEARS S4°W, 35.2 FT
 - 15" DIA. D. FIR DOUBLE BLAZED AND SCRIBED "T315 R7W S32 CS BT"
 - BEARS S32 1/2°E, 14.4 FT.
 - 16" DIA. LIVE OAK DOUBLE BLAZED AND SCRIBED "T315 R7W S29 CS BT"
 - BEARS N19°E, 30.6 FT.
 - 9" DIA. D. FIR DOUBLE BLAZED AND SCRIBED "T315 R7W S30 CS BT"
 - BEARS N64°W, 21.3 FT
- Sketch of Monument, Accessories, and General Area

Location & Comments

Location & Comments

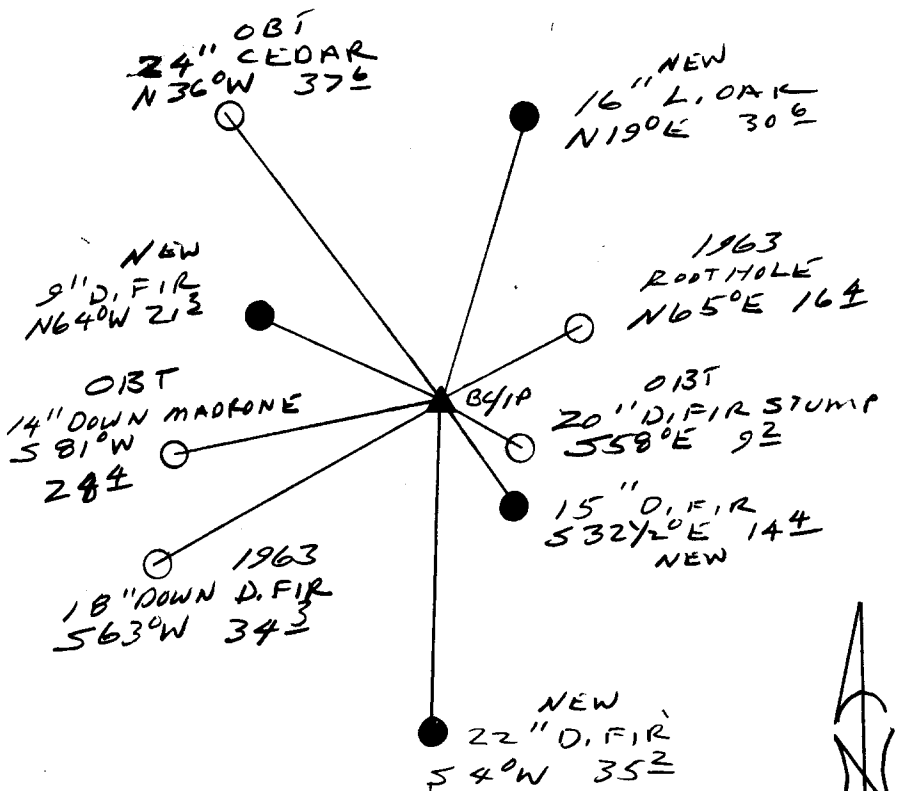

Comp. Declin. 17 3/4°E
 Agency DCSD
 Party Chief RANDALL W. SMITH
 Notekeeper [Signature]
 Witnesses STEPHEN J. FLAUSE

Address

Surveyor's Seal

REGISTERED PROFESSIONAL LAND SURVEYOR

Randall W. Smith
 EXPIRES 6-30-98

OREGON
 JULY 25, 1990
 RANDALL W. SMITH
 2469