

M 124-30

FILED

Date: 11-15-96 By: JC

This survey consists of:

Map: U124-30

Narrative: _____

Corner Ppt: 65/8-12A-C

OREGON CORNER RESTORATION FORM

Section 12 Township 28S Range 8W

County Douglas Date July 16, 1996

DOUGLAS COUNTY
SURVEYOR

Corner Designation

N 1/16
S12 | S7

- Condition Report Only
- Not Found
- Renewed
- Unrecorded
- Surveyed In
- Referenced Out

Previous Renewals/Surveys, etc. _____

None

Monument(s) & Accessories Found: (Condition and Source)

N/A

Monument Detail

Sketch

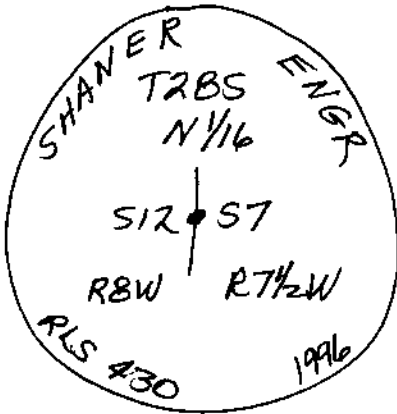

Monument Set (Procedures and Description)

I set a 3/4" Alum. Cap on a 2 1/2" x 28" Alum. Pipe, from which a:

New Accessories

6" D. Fir BT, I scribed "1/16 S7 BT" bears S29°E, 60 feet.
8" D. Fir BT, I scribed "1/16 S12 BT" bears S75°W, 14 1/2 feet.
6 Foot Steel Fence Post, South, 10 feet.

Location & Comments

North of USBLM
Road No. 28-B-120
approx. 120 feet

Compass Declination 20°E
 Firm/Agency Shaner Engineering, Inc.
 Address P.O. Box 1430
Roseburg, Oregon 97470
 Party Chief B. Shaner
 Notes _____
 Witness David Snyder
Clement Berlier

Surveyor's Seal

REGISTERED
PROFESSIONAL
LAND SURVEYOR

Bruce A Shaner

OREGON
OCT. 4, 1957
BRUCE A. SHANER
430

Renews June 30, '98

M 124-30

FILED

Date: 11-15-96 By: X

This survey consists of:

Map: M 124-30

Narrative: _____

Corner Ppt: 65/8-12 AC

OREGON CORNER RESTORATION FORM

Section 12 Township 28S Range 8W

County Douglas Date July 16, '96

DOUGLAS COUNTY SURVEYOR

Corner Designation

E 1/4 Corner

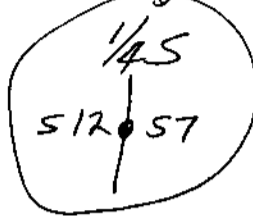

- Condition Report Only
- Not Found
- Renewed
- Unrecorded
- Surveyed In
- Referenced Out

Previous Renewals/Surveys, etc.

Same as recorded by Douglas County Surveyor report in 1994.

Monument(s) & Accessories Found: (Condition and Source)

Monument Detail

Sketch

Monument Set (Procedures and Description)

New Accessories

Location & Comments

Surveyor's Seal

Compass Declination 20°E

Firm/Agency Shaner

Engineering Inc.

Address P.O. Box 1430

Roseburg, OR 97470

Party Chief B. Shaner

Notes " "

Witness David Snyder

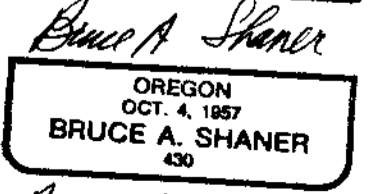
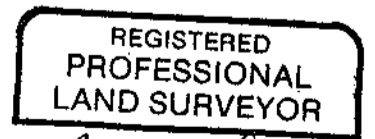

Renewal June 30, '98

C.S. File No. 65/8-12 B

M 124-30

FILED

Date: 11-15-96 By: XC

This survey consists of:

Map: M 124-30

Narrative: _____

Corner Rpt: 65/8-12 A-C

OREGON CORNER RESTORATION FORM

Section 12 Township 285 Range 8W

County Douglas Date July 16, 1996

DOUGLAS COUNTY
SURVEYOR

Corner Designation

NE Section Corner

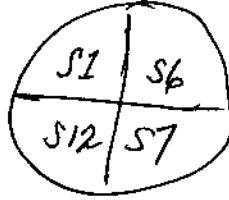

- Condition Report Only
- Not Found
- Renewed
- Unrecorded
- Surveyed In
- Referenced Out

Previous Renewals/Surveys, etc.

Same as reported by Ron Geister in 1986 Survey.

Monument(s) & Accessories Found: (Condition and Source)

Monument Detail

Sketch

Monument Set (Procedures and Description)

New Accessories

Location & Comments

Surveyor's Seal

Compass Declination 20°E

Firm/Agency Shaner Engineering, Inc.

Address P.O. Box 1430 Roseburg, OR 97470

Party Chief B. Shaner

Notes " "

Witness David Snyder

REGISTERED
PROFESSIONAL
LAND SURVEYOR

Bruce A. Shaner

OREGON
OCT. 4, 1957
BRUCE A. SHANER
430

Renews June 30, 1998

U.S. File No. 65/8-12C