

M 125-62 A & B

FILED

Date: 9-27-96 By: JC

This survey consists of:

Map: M 125-62 A & B

Narrative: CS 65/10-2 A & B

Corner Rpt: CS 65/8-7 A & B

OREGON CORNER RESTORATION FORM

Section 17 Township 27S Range 6W

County Douglas Date Sept. 17, 1996

DOUGLAS COUNTY SURVEYOR

Corner Designation

1/4 S
S 17 | S 16

- Condition Report Only
- Not Found
- Renewed
- Unrecorded
- Surveyed In
- Referenced Out

Previous Renewals/Surveys, etc.

Roger Gee reset corner by proportion, 1966.

Don Bentz found corner & set 5/8" Iron Rod in 1988.

Monument(s) & Accessories Found: (Condition and Source)

Found 5/8" Iron Rod set by Bentz in 1988, from which a:

48" Black Oak BT with overgrown face, now blown down, bears N 3 1/2° W, 132 ± feet

Monument Detail

Sketch

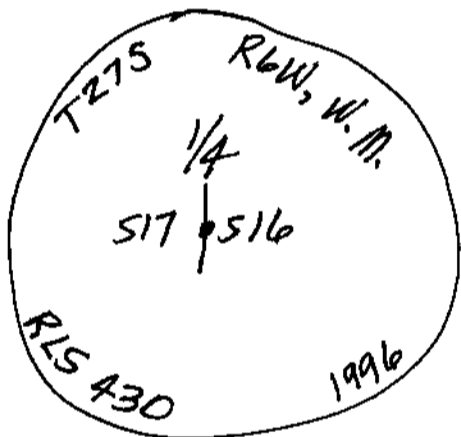

Monument Set (Procedures and Description)

I set a 3" Alum. Pipe with a 3 1/2" Alum. Cap, marked as above, from which a:

(5/8" Iron Rod by Bentz, I reset alongside Alum. Pipe)

New Accessories

- 14" Madrone BT, I scribed "1/4 S 17 BT" bears S 53° W, 85 ± feet.
- 12" Madrone BT, " " "1/4 S 17 BT" bears N 31° W, 48 ± feet.
- 6" Oak BT, I scribed "1/4 S 16 BT" bears N 10° E, 50 ± feet.
- 6 Foot Steel Fence Post, I set North, 10 feet
- " " " " " " West, 10 feet

Location & Comments

Corner is 85 Feet East of N-S Fenceline. Compass Declination 20° E
 Firm/Agency Shaner Engineering, Inc.
 Address P.O. Box 1430 Roseburg, OR 97470
 Party Chief B. Shaner
 Notes " "
 Witness David Snyder

Surveyor's Seal

REGISTERED PROFESSIONAL LAND SURVEYOR

Bruce A. Shaner

OREGON OCT. 4, 1957
 BRUCE A. SHANER
 430

Renews June 30, 1998

M125-62 A:B

FILED

Date: 9-27-96 By: JC

This survey consists of:

Map: M125-62 A:B

Narrative: CS 65/10-2 A:B

Corner Rpt: CS 65/8-7 A:B

OREGON CORNER RESTORATION FORM

Section 16 Township 27S Range 6W

County Douglas Date Sept. 17, 1996

DOUGLAS COUNTY SURVEYOR

Corner Designation

S.W. Corner
McKinney OLC No. 50

- Condition Report Only
- Not Found
- Renewed
- Unrecorded
- Surveyed In
- Referenced Out

Previous Renewals/Surveys, etc.

Douglas County Surveyor's Office, Smith & Flouse, 1993.

Monument(s) & Accessories Found: (Condition and Source)

Found Brass Cap & BT's, etc. as recorded by
County Surveyors, 1993.

Monument Detail

Sketch

See Above.

Monument Set (Procedures and Description)

N/A

New Accessories

N/A

Location & Comments

Compass Declination 20°E

Firm/Agency Shaner
Engineering, Inc.

Address P.O. Box 1430
Roseburg, OR 97470

Party Chief B. Shaner

Notes " "

Witness David Snyder
Clement Berlier

Surveyor's Seal

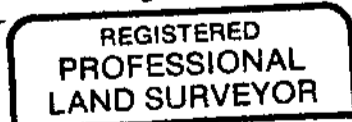

Bruce A. Shaner

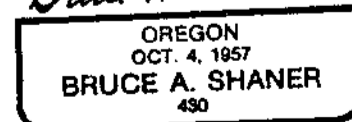

Renews June 30, 1998