

GOVERNMENT CORNER RESTORATION FORM

Date: 2/24/1998 By: JC

This survey consists of:

Township 24S Range 7W Sec. 13 County DOUGLA

Map: _____

State OR Date 2-17-98

Narrative: _____

Corner Rpt: 64/79-32

Corner Designation

DOUGLAS COUNTY SURVEYOR

- Condition Report Only
- Not Found
- Renewed
- Unrecorded
- Surveyed In
- Referenced Out

S14 | S13
S23

MONUMENT DETAIL

Previous Renewals 1893, 1958 DCSO

Monument(s) Found: (Condition and Source)

2 1/2" DIA BRASS CAP ON A 1 1/2" DIA IRON PIPE PROTRUDING 12" ABOVE GROUND. (1958)

TWO STONES ARE FOUND ALONG EASTERN EDGE OF BC/IP.

COUNTY SURVEYORS OFFICE
T245

S14 | S13
S23
R7W
1958

Accessories Found:

15" NOW 36" DIA 4 FT HIGH ROTTED D.FIR STUMP WITH A FULLY HEALED BLAZE BEARS S78°W, 23.8 FT (AGREES WITH REC.) ORT

10" NOW 30" DIA 3 FT HIGH ROTTED D.FIR STUMP SINKING FOUND "24" BEARS N41°W, 40.9 FT (AGREES WITH REC.) - 1893

13" NOW 25" DIA. R. CEDAR WITH A FULLY HEALED DOUBLE BLAZE BEARS N61 1/2°W, 64.2 FT (REC. N60 1/2°W, 64.2 FT) 1958

10" NOW 33" DIA. W. FIR WITH A FULLY HEALED DOUBLE BLAZE BEARS N23 1/2°E, 46.5 FT (AGREES WITH REC.) 1958

CHISELED "+" ON SAND STONE FROM 1958 NOT FOUND

Monument Set (Procedure and Description)

Monument Detail

NONE

N/A

New Accessories

10" DIA MYRTLE DOUBLE BLAZED AND SCRIBED "T245 R7W S13CS BT"
BEARS N 83° E, 9.6 FT

9" DIA ALDER DOUBLE BLAZED AND SCRIBED "T245 R7W S13CS BT"
BEARS N 34 1/2° E, 27.0 FT

Sketch of Monument, Accessories, and General Area

Location & Comments

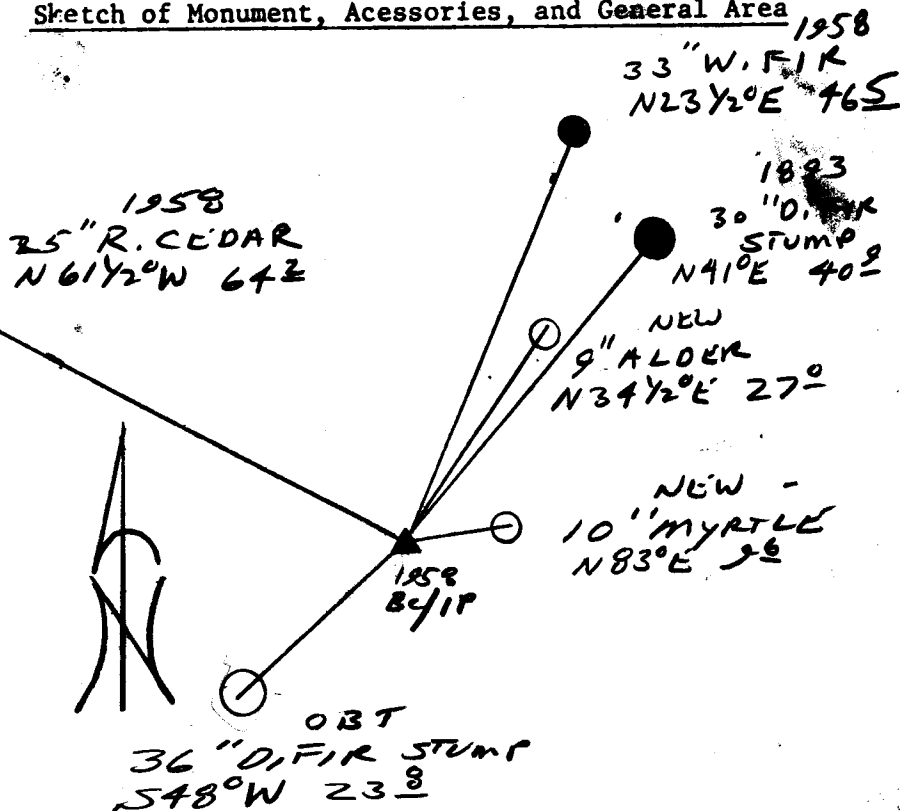

1958
33" W. FIR
N 23 1/2° E 46.5

1893
30" OAK STUMP
N 41° E 40.0

NEW
9" ALDER
N 34 1/2° E 27.0

NEW -
10" MYRTLE
N 83° E 9.6

1958
36" OAK STUMP
S 48° W 23.0

1958
25" R. CEDAR
N 61 1/2° W 64.2

Comp. Declin. 17 3/4° E
Agency DCSG
Party Chief RANDALL W. SMITH
Notekeeper [Signature]
Witnesses STEPHEN T. FLAUG

Address

Surveyor's Seal

REGISTERED
PROFESSIONAL
LAND SURVEYOR

[Signature]
EXPIRES 6-30-90

OREGON
JULY 25, 1990
RANDALL W. SMITH
2468