

GOVERNMENT CORNER RESTORATION FORM

Date: 2/2/98 By: X
This survey consists of:

Township 30 Range 2 Sec. 4 County DOUGLAS Map: _____
State OR Date 2-10-98 No. _____
Narrative: _____
Corner Rpt: 64/79-28

Corner Designation

$\frac{1}{4}$ $\frac{S4}{S9}$

DOUGLAS COUNTY
SURVEYOR

- Condition Report Only
- Not Found
- Renewed
- Unrecorded
- Surveyed In
- Referenced Out

MONUMENT DETAIL

Previous Renewals 1962 MARKHAM JK

Monument(s) Found: (Condition and Source)

4" DIA 15" DIA 10" HIGH CEDAR
STUMP, DOWNED TREE HAS HEALED
BLAZES, ORIG. CORNER TREE

5/8" IRON ROD PROTRUDES 9"
ABOVE GROUND IS FOUND ALONG
SOUTH EDGE OF CEDAR STUMP.
1962

N/A

Accessories Found:

90" NW RATED 6 FT HIGH D. FIR SNAG WITH AXE
MARKS AND RATED BLAZE NO SCRIBING VISIBLE,
BEARS S60°E, 13.9 FT CABLES WITH ORIG. REC.)
QBT
NE QBT NOT FOUND

13" NW 21" DIA. D. FIR WITH A FULLY HEALED DOUBLE
BLAZE BEARS N 67°E, 4.6 FT CABLES
(WITH REC.) 1962

10" NW 15" DIA. D. FIR WITH A FULLY HEALED DOUBLE
BLAZE, BEARS S 57°W, 9.0 FT, (CABLES WITH REC.) 1962

Monument Set (Procedure and Description)

A 7" ~~WOOD~~ NAIL THROUGH A METAL WASHER IS SET IN TOP OF CEDAR STUMP NEAR CENTER. WASHER STAMPED "DCSO 1998".

N/A

New Accessories

19" DIA. D. FIR DOUBLE BLAZED AND SCRIBED "1454CS BT" BEARS N 17° E, 19.8 FT

21" DIA. W. FIR DOUBLE BLAZED AND SCRIBED "1459CS BT" BEARS S 25° E, 26.9 FT

Sketch of Monument, Accessories, and General Area

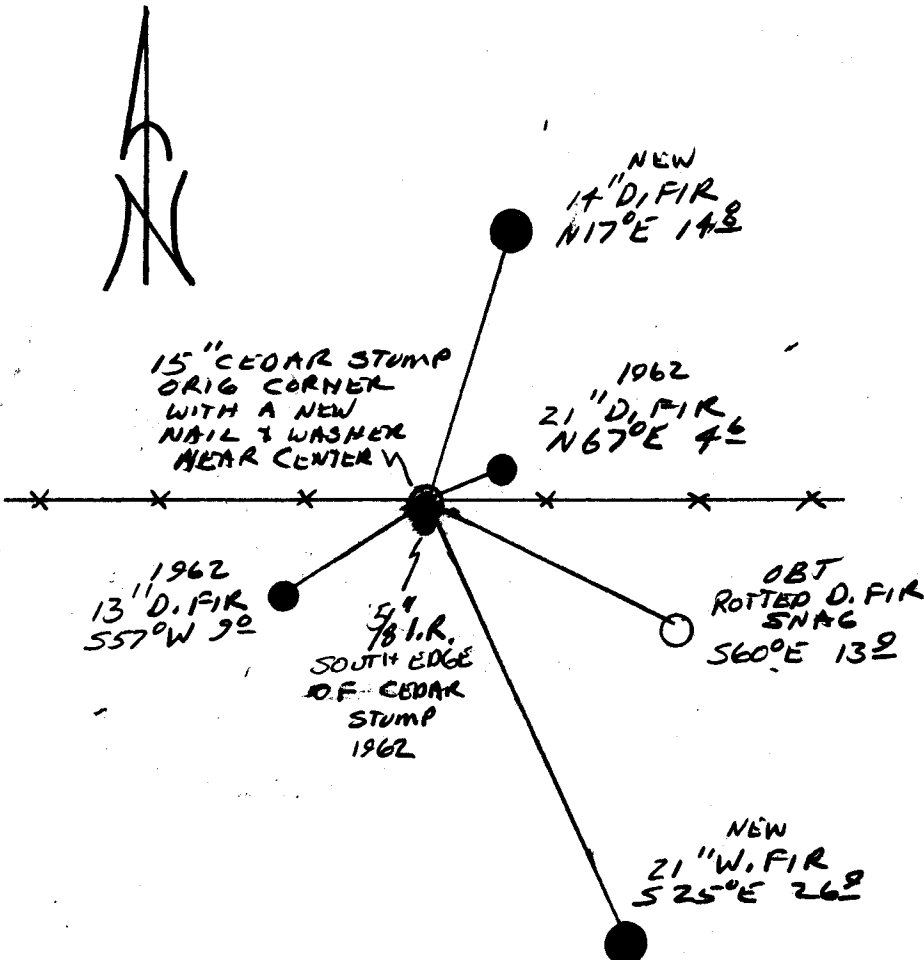

Location & Comments

CORNER LIES IN AN EAST - WEST FENCE LINE

Comp. Declin. 17 3/4° E
 Agency DCSO
 Party Chief RANDALL W. SMITH
 Notekeeper [Signature]
 Witnesses STEPHEN J. FRAUSE

Address

Surveyor's Seal

REGISTERED PROFESSIONAL LAND SURVEYOR

[Signature]

EXPIRES 6-30-98

OREGON
 JULY 25, 1980
 RANDALL W. SMITH
 2469