

Monument Set (Procedure and Description)

Monument Detail

NINE

N/A

New Accessories

30" DIA D. FIR BARK SCRIBED "T255 R6WS36 CS BT"
BEARS N13°W, 427.0 FT

30" DIA D. FIR BARK SCRIBED "T255 R5WS31 CS BT"
BEARS N60°E, 324.0 FT

Sketch of Monument, Accessories, and General Area

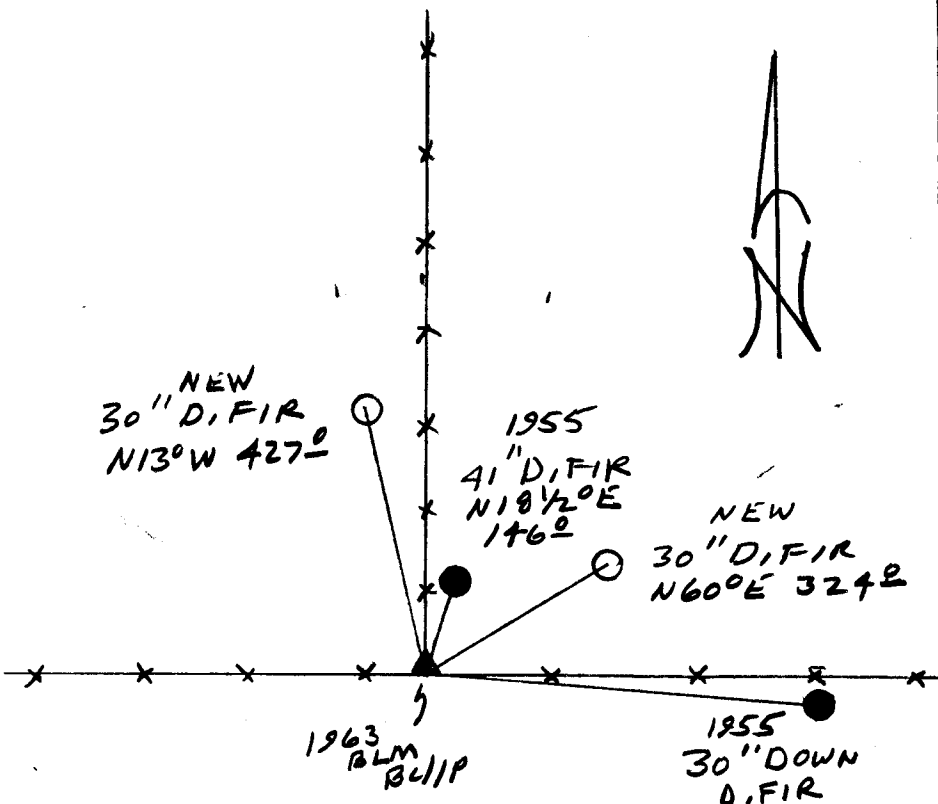

Location & Comments

CORNER LINS AT THE INTERSECTION
OF FENCES RUNNING EAST
WEST AND NORTH

NO TREES SOUTH
OF LINE

Comp. Declin. 17 3/4° E
Agency DC33
Party Chief RANDALL W SMITH
Notekeeper [Signature]
Witnesses STEPHEN J FLAISE

Address

Surveyor's Seal

REGISTERED
PROFESSIONAL
LAND SURVEYOR

[Signature]
EXPIRES 6-30-98

OREGON
JULY 25, 1890
RANDALL W. SMITH
2409