

GOVERNMENT CORNER RESTORATION FORM

Date: 2/12/98 By: X  
This survey consists of:

Township 25S Range 7W Sec. 23

County DOUGLAS Map: \_\_\_\_\_

State OR

Date 2-9-98

No. \_\_\_\_\_

Narrative: \_\_\_\_\_

Corner Rpt: 64/19-24

Corner Designation

1/4 523/524

DOUGLAS COUNTY

SURVEYOR

Condition Report Only

Not Found

Renewed

Unrecorded

Surveyed In

Referenced Out

MONUMENT DETAIL

Previous Renewals 1958 DCSO

Monument(s) Found: (Condition and Source)

2 1/2" BRASS CAP ON A 1 1/2" O.D. IRON  
PIPE PROTRUDES 10" ABOVE GROUND.  
1958

COUNTY SURVEYORS OFFICE  
T 25 S

1/4 23/24

R 7W

1958

Accessories Found:

NO OBT'S FOUND  
1958 SE BT NOW GONE

16" NOW 20" DIA. DEAD D. FIR WITH A FULLY HEALED  
DOUBLE BLAZE, BEARS S80°W 18.5 FT/  
(AGREES WITH REC.) 1958

Monument Set (Procedure and Description)

Monument Detail

NONE

N/A

New Accessories

- 13" DIA. MADRONE DOUBLE BLAZED AND SCRIBED "1/4 S23CS BT" BEARS S 73° W 15.2 FT
  - 13" DIA. D. FIR SINGLE BLAZED AND SCRIBED "1/4 S23CS BT" BEARS S 56° W 3.5 FT
  - 10" DIA. MADRONE DOUBLE BLAZED AND SCRIBED "1/4 S24CS BT" BEARS S 41 1/2° E 26.4 FT
  - 15" DIA. B. OAK DOUBLE BLAZED AND SCRIBED "1/4 S24CS BT" BEARS N 21° E 47.4 FT
- Sketch of Monument, Accessories, and General Area

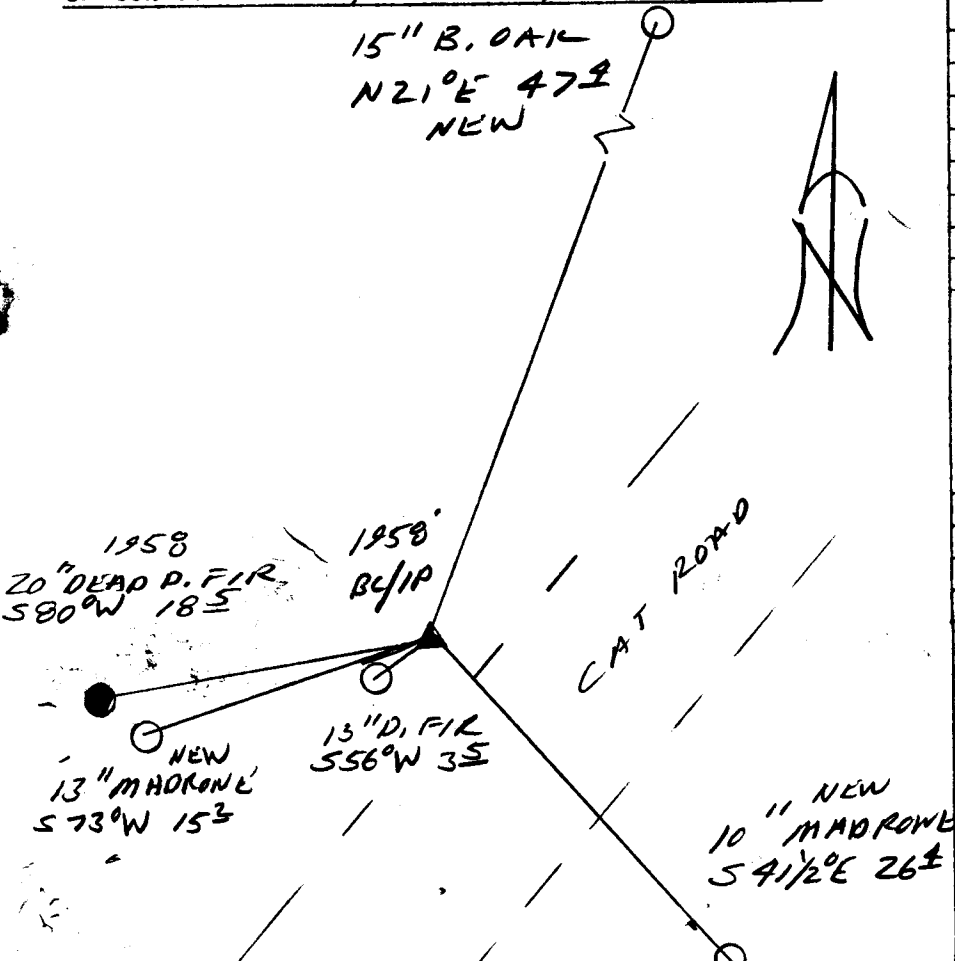

Location & Comments

CAT ROAD IS 15 FT SOUTH OF CORNER

Comp. Declin. 17 3/4' E  
 Agency DC58  
 Party Chief RANDALL W. SMITH  
 Notekeeper [Signature]  
 Witnesses STEPHEN J. FLAUSCH

Address

Surveyor's Seal

REGISTERED PROFESSIONAL LAND SURVEYOR

[Signature]

EXPIRES 6-30-98

OREGON JULY 25, 1980 RANDALL W. SMITH 2400