

GOVERNMENT CORNER RESTORATION FORM

Date: 2/12/98 By: X

Township 25S Range 6W Sec. 16

County DOUGLAS This survey consists of:

State OR Date 2-4-98 No. _____

Narrative: _____

Corner Designation _____

Corner Rpt: 64/79-17

NNW
COR
DLC 51

- DOUGLAS COUNTY SURVEYOR Only
- Condition Not Found
 - Renewed
 - Unrecorded
 - Surveyed In
 - Referenced Out

Previous Renewals 1910? + 1962 DCSO

Monument(s) Found: (Condition and Source)

2 1/2" DIA. BRASS CAP ON A
1 1/2" O.D. IRON PIPE, PROTRUDES
10" ABOVE GROUND, 1962

IRON BOLT IS FOUND
ALONG EAST EDGE OF REIP,
PROTRUDES 2" ABOVE GROUND.
SOURCE UNKNOWN

COUNTY SURVEYORS OFFICE
T 25 S R 6 W

N. N. W. COR.

D. L. C. | 51

1962

Accessories Found:

13" NOW 14" DIA. W. OAK WITH A FULLY HEALED DOUBLE
BLAZE, BEARS N 72 1/2° E, 40.3 FT (AGREES WITH REC.)
1962

14" NOW 17" DIA. W. OAK WITH A FULLY HEALED DOUBLE
BLAZE, BEARS S 30° W, 19.5 FT (AGREES WITH REC.)
1962

6" NOW REMAINS OF D. FIR RETIED TO GROUND,
NO SCRIBING OR BLAZE FOUND NEAR RECORDED
POSITION "N 40 1/2° W, 13.2 FT" 1910?

Monument Set (Procedure and Description)

Monument Detail

NONE

N/A

New Accessories

7" DIA D.FIR DOUBLE BLAZED AND SCRIBED "NNW DLC 51CS 17"
BEARS N71 1/2° E, 21.7 FT

16" DIA. W.OAK SINGLE BLAZED AND SCRIBED "NNW DLC 51CS PT"
BEARS S42° E, 14.9 FT (NOTE IN GROWN FENCE WIRE
3 FT ABOVE GROUND)

Sketch of Monument, Accessories, and General Area

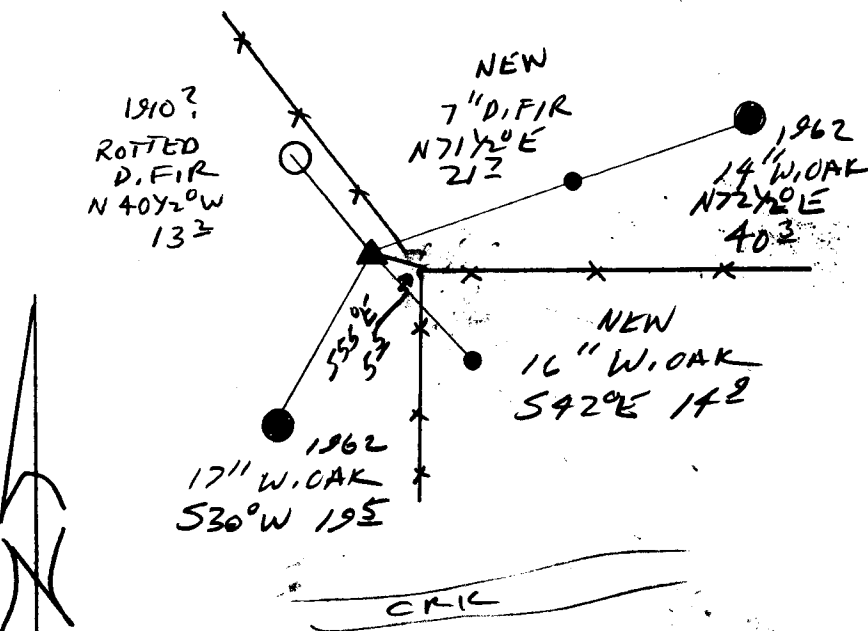

Location & Comments

CORNER LIES N 55° W,
5.5 FT FROM A FENCE
CORNER WITH OLD FENCES
RUNNING SOUTH + NORTH
WEST AND GOOD FENCE
RUNNING EAST

Comp. Declin. 173/4° E
Agency DCSO
Party Chief RANDALL W. SMITH
Notekeeper [Signature]
Witnesses STEPHEN J. FRAUSE

Address

Surveyor's Seal

REGISTERED
PROFESSIONAL
LAND SURVEYOR

[Signature]
EXPIRES 6-30-28

OREGON
JULY 25, 1990
RANDALL W. SMITH
2408