

GOVERNMENT CORNER RESTORATION FORM

Date: 1-5-98 By: x

Township 25S Range 4W Sec. 9

County DOUGLAS

This survey consists of:

State OR

Date 12-23-97

No.

Narrative:

Corner Rpt: 64/78-42

Corner Designation

59 | 510

516 | 515

DOUGLAS COUNTY

- Condition SURVEY ONLY
- Not Found
- Renewed
- Unrecorded
- Surveyed In
- Referenced Out

Previous Renewals 1958 BLM

Monument(s) Found: (Condition and Source)

BRASS CAP ON A IRON PIPE
16" BELOW GROUND, UNABLE
TO REAP STAMPING. (1958)

A METAL FENCE POST IS
ALONG S'LY EDGE OF
BC/IP.

N/A

Accessories Found:

CEDAR CORNER POST WITH FENCING RUNNING
RUNNING NORTH AND EAST HAS FALLEN OVER NEAR
REC POSITION. " N 22° 35' E 17.8 FT" 1958

POWER POLE WITH SCRIBING " X BO" BEARS
S 70° 4' W 462.6 FT (REC. S 70° 4' W, 463.3 FT) 1958

POWER POLE WITH SCRIBING " X BO" BEARS
N 70° 4' W, 592.0 FT (AGREES WITH REC) 1958

Monument Set (Procedure and Description)

Monument Detail

NONE

N/A

DOUBLE TRUNKED W. OAK DOUBLE BLAZED AND SCRIBED "T255 R4W S15 CS BT" ON 16" DIA NORTHERLY TRUNK, CENTER OF ROOT CROWN BEARS, S52°E, 445.1 FT

New Accessories

16" W. OAK DOUBLE BLAZED AND SCRIBED "T255 R4W S9 CS BT" BEARS N47 1/2° W, 36.6 FT

8" PEAR DOUBLE BLAZED AND SCRIBED "X BT" BEARS N59 1/2° E, 179.9 FT

17" CEDAR DOUBLE BLAZED AND SCRIBED "T255 R4W S10 CS BT" BEARS N85° E, 173.6 FT

Sketch of Monument, Accessories, and General Area

Location & Comments

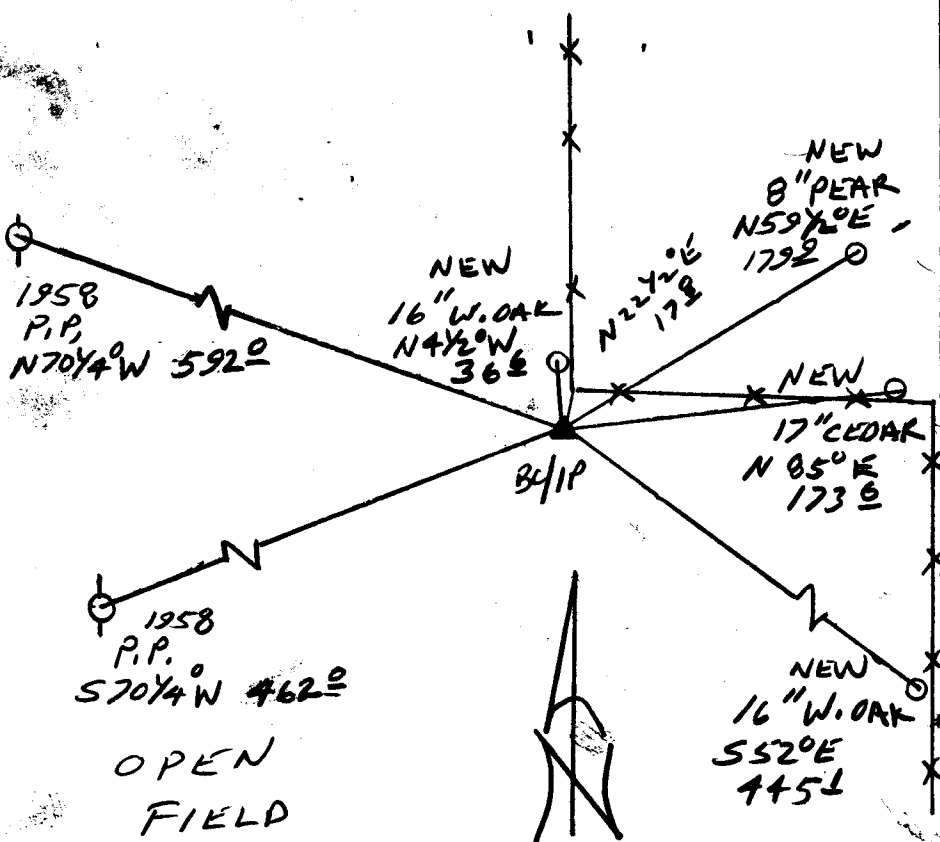

Comp. Declin. $17\frac{3}{4}^{\circ}E$
 Agency DCS
 Party Chief RANDALL W SMITH
 Notekeeper Randall W Smith
 Witnesses JOHN PIKE

Address

Surveyor's Seal

REGISTERED
PROFESSIONAL
LAND SURVEYOR

Randall W Smith
EXPIRES 6-30-98

OREGON
JULY 26, 1980
RANDALL W. SMITH
2489