

GOVERNMENT CORNER RESTORATION FORM

Date: 11-7-97 By: PC

Township 29S Range 8W Sec. 7 County DOUGLAS

This survey consists of:

State OREGON Date 10/21/97 No. _____

Map: _____

Narrative: _____

Corner Designation

Corner Rpt: CS 64/78-23

DOUGLAS COUNTY

Condition SURVEYED Only

Not Found

Renewed

Unrecorded

Surveyed In

Referenced Out

MONUMENT DETAIL

DLC 50

Previous Renewals 1954 AND 1958

Monument(s) Found: (Condition and Source)

N/A

FROM 1954 RENEWAL A 1 1/2 INCH O.D. IRON PIPE FIRMLY SET, PROTRUDING APPROX 18 INCHES ABOVE GROUND AND LEANING SOUTHWESTERLY APPROX 1 1/2 FEET. AFTER CHECKING BEARING OBJECTS TO PLUMB POSITION OF IRON PIPE, POSITION IS REFERENCED, PIPE IS REMOVED FROM GROUND AND FOUND TO MEASURE 44 INCHES LONG (RECORD 1 1/2" X 40" GALV. PIPE) MONUMENT IS ON NORTH STREAM BANK AND UNDER A BRIDGE DECK.

Accessories Found:

NO EVIDENCE OF THE ORIGINAL BEARING TREE IS FOUND.

FROM THE 1954 RENEWAL AN 18" YEWWOOD NOW A DEAD AND SEVERELY LEANING 17 INCH D.B.H. YEW WITH A PARTIALLY HEALED BLAZE, NO SCRIBING VISIBLE, THE ROOT CROWN OF WHICH BEARS S 58 1/4° W, 80 ± FEET DISTANT (RECORD S 60° W, 80.71 FT.)

FROM THE 1958 RENEWAL A SAWED-OFF 12 INCH DIAMETER BRIDGE PILING PROTRUDING APPROXIMATELY 2 1/2 FEET ABOVE GROUND BEARS S 19° E, 60 FEET DISTANT (AS PER RECORD) THE BEARING FOR THIS REFERENCE IS MEASURED UNDER THE BRIDGE DECK AND MAY HAVE A LOCALIZED MAGNETIC DEFLECTION, THE DISTANCE IS A FACE MEASUREMENT TO THE BRIDGE PILING.

RENEWAL

Monument Set (Procedure and Description)

Monument Detail

FOUND IRON PIPE MONUMENT IS RESET PLUMB AT REFERENCED POSITION AND NOW PROTRUDES APPROXIMATELY 6 INCHES ABOVE GROUND.

N/A

New Accessories

CONCRETE

CORNERS AT THE TOP OF THE NORTH AND SOUTH BRIDGE ABUTMENT WALLS ARE TIED AS REFERENCE POINTS FOR THE IRON PIPE MONUMENT (SEE SKETCH). THE SOUTHEAST CORNER OF THE NORTH ABUTMENT WALL BEARS N28°E, 14³/₄ FEET DISTANT. THE NORTHWEST CORNER OF THE SOUTH ABUTMENT WALL BEARS S16°W, 84¹/₄ FEET DISTANT. THE SOUTHWEST CORNER OF THE NORTH ABUTMENT WALL BEARS N57³/₄W, 25⁰/₄ FEET DISTANT.

Sketch of Monument, Accessories, and General Area

Location & Comments

MONUMENT IS LOCATED ON NORTH HIGHBANK OF THE MIDDLE FORK OF THE COQUILLE RIVER APPROXIMATELY 6 FEET LOWER THAN AND BENEATH THE BRIDGE DECK OF DANCER ROAD BRIDGE OVER SAID RIVER FORK.

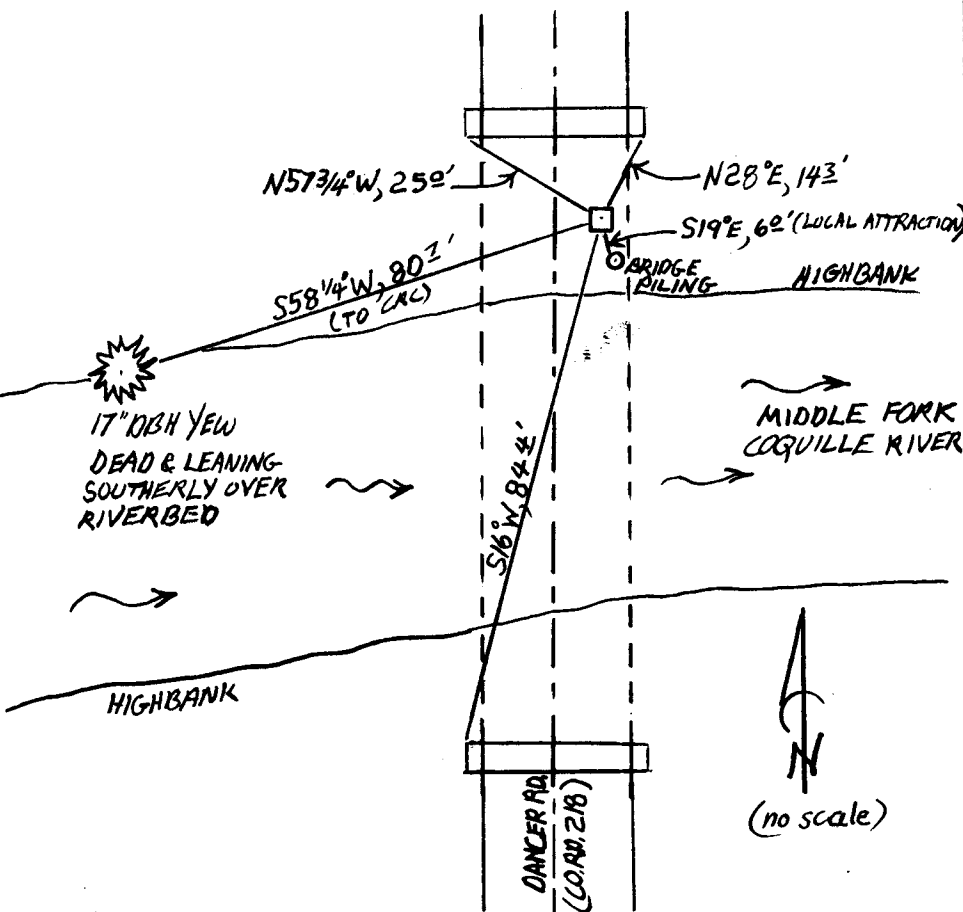

Comp. Declin. 17³/₄°E
 Agency DCSO
 Party Chief STEPHEN FLAISE
 Notekeeper Stephen John Flaese
 Witnesses JOHN PIKE

Address

Surveyor's Seal

2488
 RANDALL W. SMITH
 JULY 25, 1980
 OREGON
 REGISTERED
 LAND SURVEYOR
 6-20-88
 [Signature]

(no scale)