

GOVERNMENT CORNER RESTORATION FORM

Date: 9-23-97 By: SP  
This survey consists of:

Township 29S Range 8W Sec. 8 County DOUGLAS

State OR Date 8-21-97 No. \_\_\_\_\_

Map: \_\_\_\_\_  
Narrative: \_\_\_\_\_  
Corner Rpt: CS 64/78-1

Corner Designation

**DOUGLAS COUNTY  
SURVEYOR**

$\frac{1}{4} \frac{S8}{S17}$

- Condition Report Only
- Not Found
- Renewed
- Unrecorded
- Surveyed In
- Referenced Out

Previous Renewals 1962 DCSO, 1973 BLM

Monument(s) Found: (Condition and Source)

3/4" DIA. BRASS CAP ON A 2 1/2" O.D. BY 30" LONG IRON PIPE IS FOUND LEANING AGAINST NEW CUT BANK OF CREEK NEAR W.C. RECORD POSITION. (1973 BLM)

1" I.D. IRON PIPE BENT WESTERLY 0.5 FT FLUSH WITH GROUND. BRASS CAP IS GONE (1962 DCSO)

1" I.D. IRON PIPE LEANING NW'ly PLUMBSS UP LOOSELY 2 1/2' ABOVE GROUND IS FOUND NEAR BLM CORNER POSITION IN CREEK, (SOURCE UNKNOWN)

U.S. DEPT. OF THE INTERIOR  
WC →  
 $\frac{1}{4} \frac{S8}{S17}$   
T29S R8W  
1973

BUR. OF LAND MANAGEMENT

Accessories Found:

From 1962 DCSO I.P.

14" NOW 25" DIA 3 FT HIGH D.FIR STUMP WITH A FULLY HEALED SINGLE BLAZE, BEARS S 38 1/2° W, 42.4 FT (AGREES WITH REC) 1962 DCSO

10" NOW 18" DIA W.OAK WITH A FULLY HEALED BLAZE, BEARS N 15 1/2° E 136.6 FT (REC. N 13° E, 136.6 FT) 1962 DCSO

From 1973 BLM W.C. POSITION

-12" NOW 17" DIA 5 FT HIGH D.FIR STUMP WITH A FULLY HEALED SINGLE BLAZE, BEARS N 74 1/2° E 311.7 FT (AGREES WITH REC) 1973 BLM

-12" B. OAK NOW 16" DIA W.OAK WITH A FULLY HEALED DOUBLE BLAZE, BEARS S 65 1/2° E, 42.2 FT (AGREES WITH REC.) 1973 BLM

DCSO I.P. BEARS N 55 1/2° E 88.5 FT

FD 1" I.P. IN CREEK BEARS S 89 1/2° E 45.2 FT  
REC. POSITION OF BLM CORNER IS S 89° 58' W, 46.2 FT  
(SOURCE UNKNOWN)

RENEWAL

Monument Set (Procedure and Description)

Monument Detail

SET A 5/8" X 5 FT LONG IRON ROD AT A POSITION DETERMINE BY W.C. BT'S FROM 1973 BLM RENEWAL, 2" BELOW GROUND. 1973 BLM BC/IP IS SET OVER I.R. AND SURROUNDED BY STONE ON SOUTHERLY EDGE, PROTRUDES 6 INCHES

U.S. DEPT. OF THE INTERIOR  
DCSO  
WC →  
RESET 1997  
Y4 S8  
Y4 S17  
T29S R8W  
1973  
BLM OF LAND MANAGEMENT

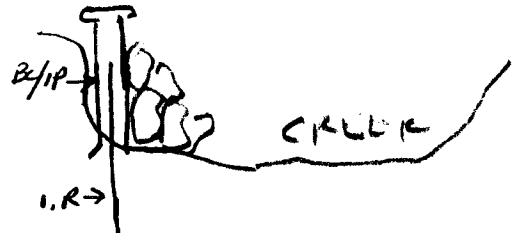

New Accessories

13" D.I.P. D.FIR DOUBLE BLAZED AND SCRIBED  
"WC Y4 S 17 CS BT" BEARS S 6 1/2° E 43.5 FT  
1962 DCSO 18" W.OAK WITH A FULLY HEAL'D BLAZE,  
BEARS N 30 3/4° E, 212.3 FT

Sketch of Monument, Accessories, and General Area

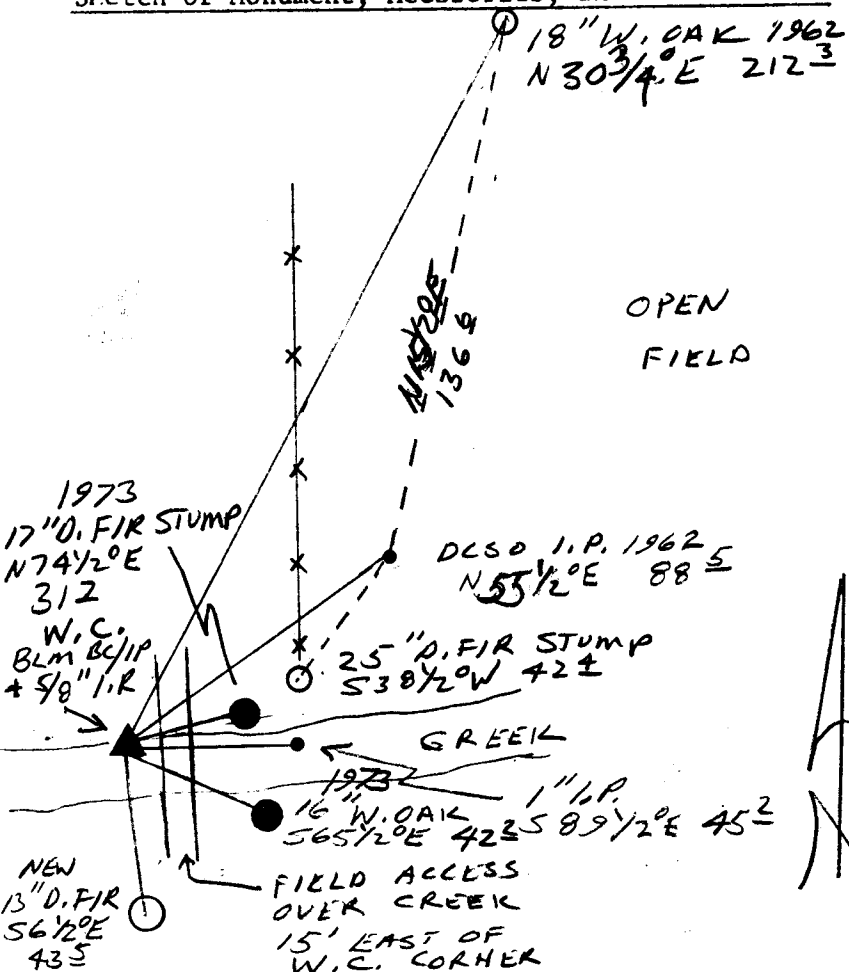

Location & Comments

CORNER LIES ALONG NORTH EDGE OF CREEK 15' WEST OF FIELD ACCESS ROAD OVER CREEK.

Comp. Declin. 17 3/4° E  
Agency DCSO  
Party Chief RANDALL W. SMITH  
Notekeeper  
Witnesses STEPHEN J. FLASK

Address

Surveyor's Seal

REGISTERED PROFESSIONAL LAND SURVEYOR  
Randall W. Smith  
EXPIRES 6-30-98  
OREGON  
JULY 25, 1990  
RANDALL W. SMITH  
2469