

GOVERNMENT CORNER RESTORATION FORM

Date: 7/25/97 By: BC

Township 25S Range 5W Sec. 25 County DOUGLAS

This survey consists of:

State OK Date 7-16-97 No. \_\_\_\_\_

Narrative: CS 64/75-28  
Corner Rpt: 65/65/15-28

Corner Designation

1/4 S 27 / S 26

DOUGLAS COUNTY

Condition  Only

Not Found

Renewed

Unrecorded

Surveyed In

Referenced Out

MONUMENT DETAIL

Previous Renewals 1973 DCSO

Monument(s) Found: (Condition and Source)

5/8" IRON ROD PROTRUDES  
4" ABOVE GROUND

N/A

Accessories Found:

6" NAW 15" DIA. DIFIR WITH A FULL HEALD  
DOUBLE BLAZE BEARS S 82° W, 22.0 FT  
(REC S 85° W, 122.0 FT) 1973

12" NAW 17" DIA. MARKER WITH A FULL HEALD  
DOUBLE BLAZE, BEARS S 36° E, 18.5 FT

Monument Set (Procedure and Description)

Monument Detail

NINE

N/A

New Accessories

10" D. FIR DOUBLE BLAZED AND SCRIBED "Y4527CS BT"  
BEARS N27°W, 11.8 FT

17" D. FIR DOUBLE BLAZED AND SCRIBED "Y4526CS BT"  
BEARS S84°E, 49.7 FT

Sketch of Monument, Accessories, and General Area

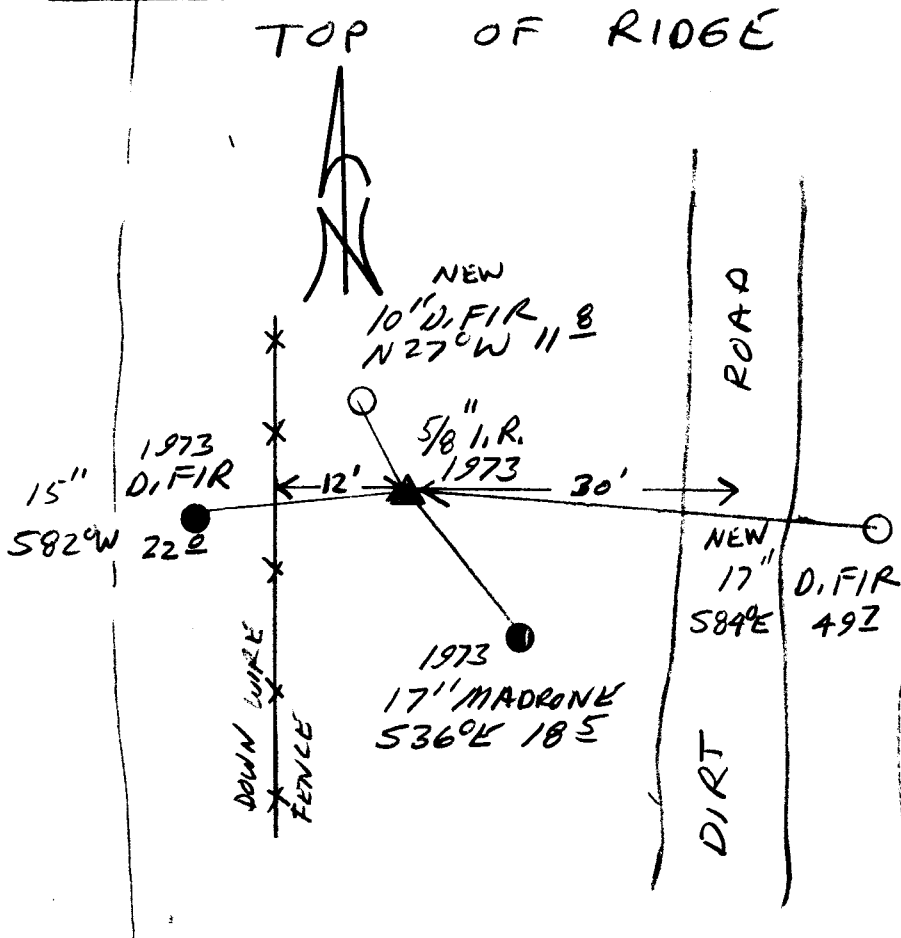

Location & Comments

CORNER LIES ON TOP  
OF A N-S RUNNING  
RIDGE 12 FT EAST  
OF A DOWN N-S  
FENCE LINE AND  
30 FT WEST OF  
RIDGE TOP RUNNING  
ROAD

Comp. Declin. 17 3/4° E  
Agency JCS  
Party Chief R. RANDALL W. SMITH  
Notekeeper [Signature]  
Witnesses STEPHEN J. FARRER

Address

Surveyor's Seal

REGISTERED  
PROFESSIONAL  
LAND SURVEYOR

[Signature]  
JULY 25, 1900  
RANDALL W. SMITH  
2400