

GOVERNMENT CORNER RESTORATION FORM

FILED

Date: 6/30/97 By: AR

Township 25S Range 6W Sec. 29 County DOUGLAS

This survey consists of:

State OR Date 6-25-97 No. \_\_\_\_\_

Map: \_\_\_\_\_  
Narrative: \_\_\_\_\_  
Corner Rpt: CS 64/75-13

Corner Designation

$\frac{1}{4}$   $\frac{S29}{S32}$

DOUGLAS COUNTY SURVEYOR

Condition: Surveyed

Not Found

Renewed

Unrecorded

Surveyed In

Referenced Out

Previous Renewals 1963 DCSO PI # 240200

MONUMENT DETAIL

Monument(s) Found: (Condition and Source)

2 1/2" BRASS CAP ON A 1 1/2" IRON PIPE  
PROTRUDES 9" ABOVE GROUND.

COUNTY SURVEYORS OFFICE

T255

$\frac{1}{4}$   $\frac{S29}{S32}$   
1963

Accessories Found:

24" NOW 48" W. OAK WITH A PARTIALLY HEALED  
PREVIOUSLY OPENED BLAZE, BEARS "S 78° E, 305.2 FT"  
(AGREES WITH REC) OBT

22" W. OAK NOW ROOTED REMAINS OF AN OAK STUMP  
BEARS "N 85° E, 338.6 FT" (AGREES WITH REC.)  
OBT

20" NOW 26" DIA. B. OAK WITH A FULLY HEALED  
DOUBLE BLAZE, BEARS "S 10 1/2° W, 133.9 FT" 1963  
(AGREES WITH REC) 1963

14" NOW 25" DIA. W. OAK WITH A FULLY HEALED  
BLAZE, BEARS "N 76° E, 213.3 FT" (AGREES WITH REC.)  
1963

C.S. File No. 64/75-13

1240200

Monument Set (Procedure and Description)

Monument Detail

NONE

N/A

New Accessories

26" DIA. ASH DOUBLE BLAZED AND SCRIBED "Y4532CSBT"  
BEARS S40°E, 23.5 FT

14" DIA. ASH DOUBLE BLAZED AND SCRIBED "Y4529CSBT"  
BEARS N36°W, 15.9 FT.

Sketch of Monument, Accessories, and General Area

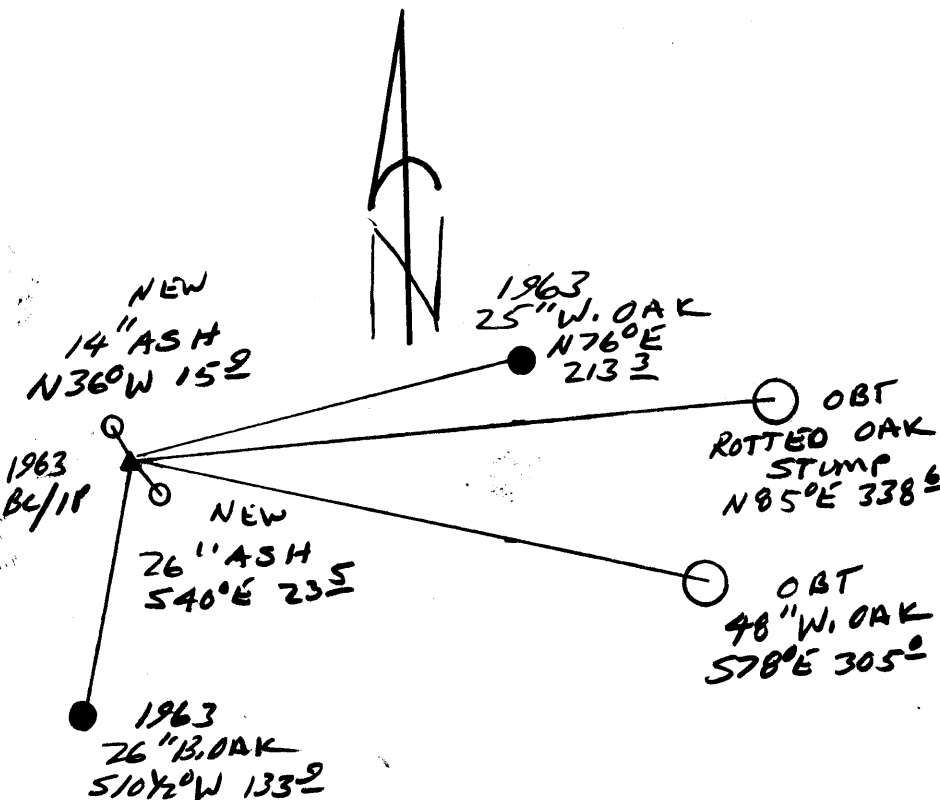

Location & Comments

Comp. Declin. 17 3/4° E  
 Agency DS  
 Party Chief RANDALL W. SMITH  
 Notekeeper [Signature]  
 Witnesses STEPHEN J. FINE

Address

Surveyor's Seal

REGISTERED  
PROFESSIONAL  
LAND SURVEYOR

[Signature]  
ED 0105 C-30-98

OREGON  
JULY 25, 1980  
RANDALL W. SMITH  
2469