

Monument Set (Procedure and Description)

NONE

N/A

- 4" MADRONE DOUBLE BLAZED AND SCRIBED
"X BT BEARS S 43° W, 30.0 FT

New Accessories

- 5" MADRONE BARK SCRIBED "T245 R5W S36 CS BT"
BEARS N 56° E 9.8 FT
- 6" B. OAK DOUBLE BLAZED AND SCRIBED "T255 R5W S1 CS BT"
BEARS S 25 1/2° E, 25.5 FT TO CENTER OF SCRIBED
TRUNK OF DOUBLE BASED TREE.
- 7" MADRONE DOUBLE BLAZED AND SCRIBED "T245 R5W S35 CS BT"
BEARS N 46° W, 25.5 FT

Sketch of Monument, Accessories, and General Area

N 12° W 1'
TO FC COR

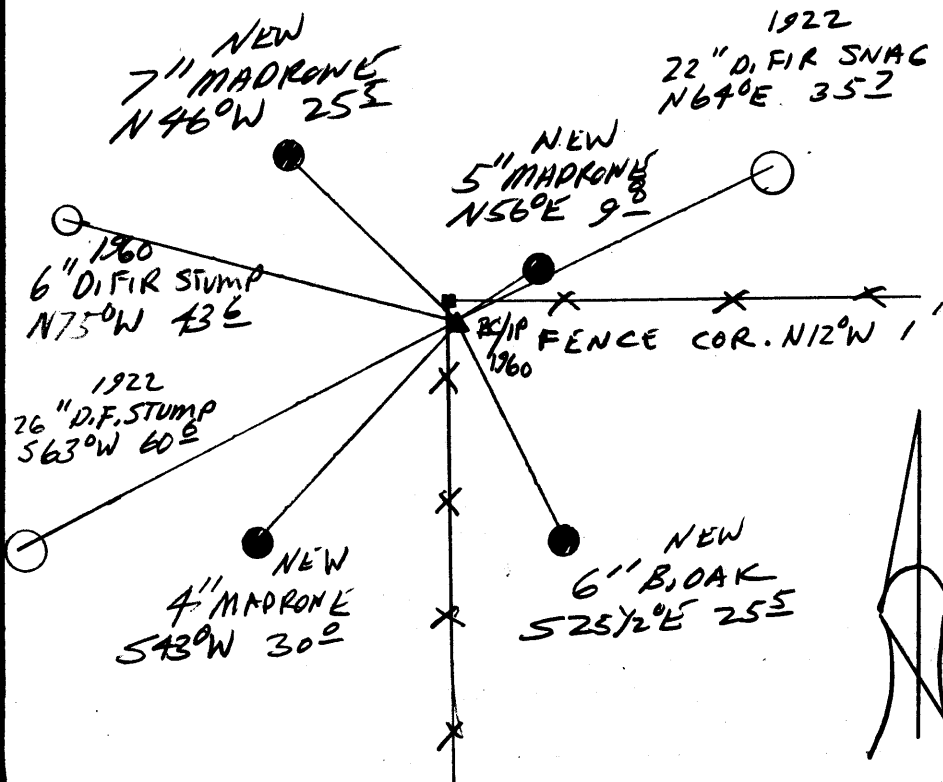

Location & Comments

CORNER LIES AT THE
INTERSECTION OF A
FENCE CORNER FENCE
RUN SOUTH AND EAST.

Comp. Declin. 17 3/4° E
 Agency DCSO
 Party Chief RANDALL W. SMITH
 Notekeeper [Signature]
 Witnesses STEPHEN J. FLAISE

Address

Surveyor's Seal

REGISTERED
PROFESSIONAL
LAND SURVEYOR

Randall W. Smith
EXPIRES 6/30/98

OREGON
JULY 25, 1990
RANDALL W. SMITH
2469