

GOVERNMENT CORNER RESTORATION FORM

Date: 6/13/97 By: BC

Township 25S Range 5N Sec. 1

County DOUGLAS

This survey consists of:

State OR Date 6-5-97

No. _____

Narrative: _____

Corner Fpt: CS 64/75-7

Corner Designation

1/4S2/S1

DOUGLAS COUNTY

Condition SURVEY ONLY

Not Found

Renewed

Unrecorded

Surveyed In

Referenced Out

Previous Renewals 1984

MONUMENT DETAIL

Monument(s) Found: (Condition and Source)
2" DIA. ALUM. CAP ON A 5/8"
L.R. PROTRUSORS 2" ABOVE GROUND
(1984)

T25S R5W

1/4
S2/S1

LS 418 1984

Accessories Found:

11" NOW 12" DIA. W/OAK WITH A PARTIALLY HEALED
SINGLE BLAZE, ILLIGIBLE SCRIBING VISIBLE
BEARS N 19° E, 24.4 FT (REC N 21° E, 24.9 FT)
1984

12" NOW 17" DIA. D/FIR WITH A FULLY HEALED
SINGLE BLAZE, BEARS S 35° W, 12.2 FT
(ARRESTS WITH REC) 1984

Monument Set (Procedure and Description)

Monument Detail

NONE

N/A

New Accessories

7" DIA MADRONE DOUBLE BLAZED AND SCRIBED "Y452 CSBT"
BEARS N16°W, 37.4 FT

13" DIA MADRONE DOUBLE BLAZED AND SCRIBED "Y451 CSBT"
BEARS S61°E, 19.2 FT

Sketch of Monument, Accessories, and General Area

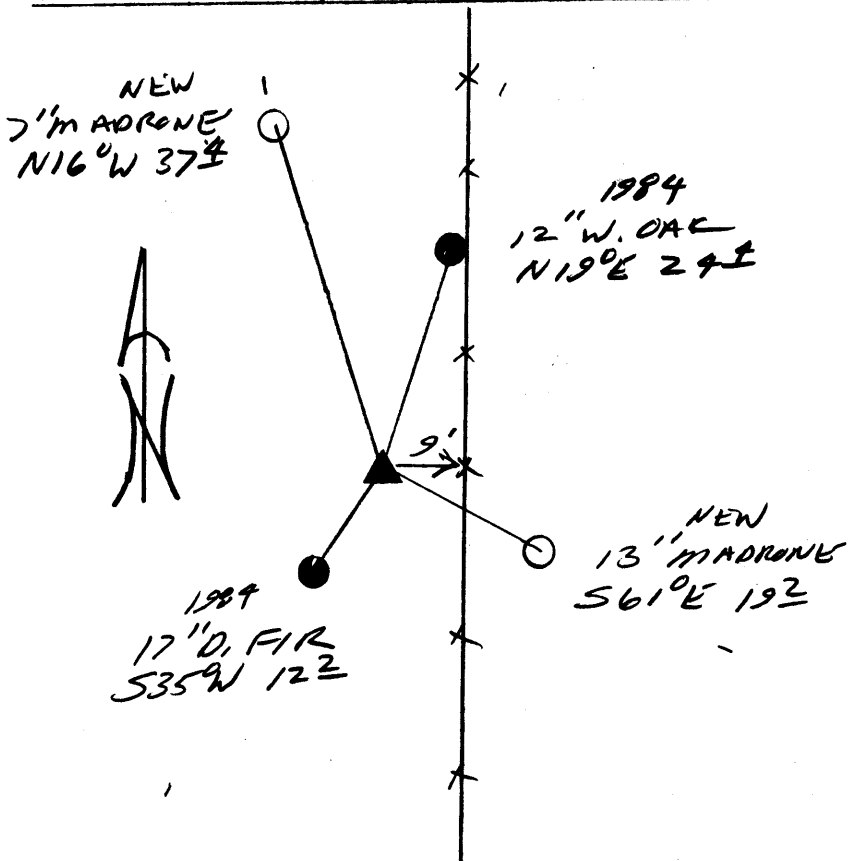

Location & Comments

CORNER LIES 9' WEST
OF A N-S FENCE
LINE ON A WEST
SLOPE

Comp. Declin. 17 3/4° E
Agency DCSO
Party Chief RANDALL W. SMITH
Notekeeper [Signature]
Witnesses STEPHEN J. FLAUGH

Address

Surveyor's Seal

REGISTERED
PROFESSIONAL
LAND SURVEYOR

[Signature]

EXPIRES 6-30-99

OREGON
JULY 25, 1990
RANDALL W. SMITH
2469