

GOVERNMENT CORNER RESTORATION FORM

Date: 5-22-97 By: PC

Township 26S Range 5W Sec. 18

County DOUGLAS

This survey consists of:

State OR

Date 5-13-97

No. _____

Narrative: _____

Corner Rpt: CS 64/74-31

Corner Designation

DLC	DLC
46	48

DOUGLAS COUNTY

Condition SURVIVOR Only

Not Found

Renewed

Unrecorded

Surveyed In

Referenced Out

PI# 046010

Previous Renewals 1921 AND 1959 DCSS

MONUMENT DETAIL

Monument(s) Found: (Condition and Source)

NF

N/A

Accessories Found:

13" MAPLE WITH A PREVIOUSLY OPENED BLAZE, ILLEGIBLE SCRIBING VISIBLE BEARS S 32°W, 26.0 FT (1959 REC S 32°W 25.0, DIST. FITS CENTER OF TRUNK)?

12" NOW 16" DIA B. OAK WITH A FULLY HEALED DOUBLE BLAZE, BEARS N 77°W, 11.8 FT (AGREES WITH REC.) 1959

8" NOW 11" DIA. W. OAK WITH A FULLY HEALED DOUBLE BLAZE, BEARS S 63°W, 22.6 FT (AGREES WITH REC.) 1959

Monument Set (Procedure and Description)

CHISELED 5" "T" IN ROCK BLUFF
3" OF SOIL ON TOP OF "T"

N/A

New Accessories

20" DIA. B. OAK DOUBLE BLAZED AND SCRIBED "NW DLC 48"
CS BT BEARS S 84° E, 70.5 FT TO CENTER OF
ROOT CROWN.

Sketch of Monument, Accessories, and General Area

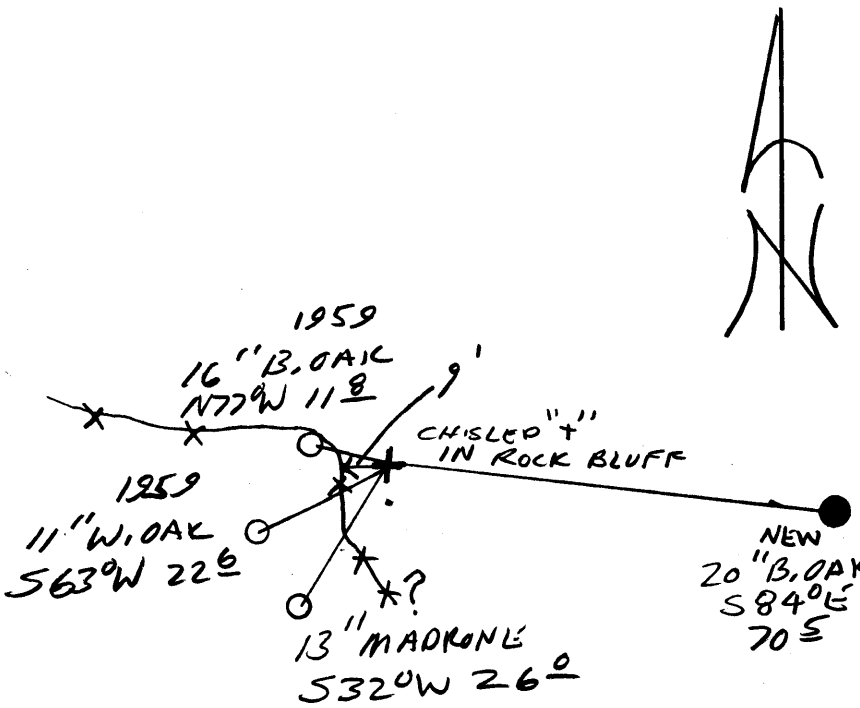

Location & Comments

CORNER LIES 2 FT
EAST OF A RANDOM
FENCE LINE

Comp. Declin. 17 3/4° E
Agency DCSO
Party Chief RANDALL W. SMITH
Notekeeper [Signature]
Witnesses STEPHEN J. LAUSE
HOGE HICKMAN

Address

Surveyor's Seal

REGISTERED
PROFESSIONAL
LAND SURVEYOR

[Signature]
EXPIRES 6-30-98

OREGON
JULY 25, 1990
RANDALL W. SMITH
2469