

GOVERNMENT CORNER RESTORATION FORM

Date: 5-13-1997 By: BC

Township 26S Range 6W Sec. 21 County DOUGLAS Map: _____

This survey consists of:

State OK Date 5-7-97 No. _____

Narrative: _____
Corner Fpt: CS 6474-28

Corner Designation

SE
COR
DLC 61

DOUGLAS COUNTY
SURVEYOR

Condition Report Only

Not Found

Renewed

Unrecorded

Surveyed In

Referenced Out

MONUMENT DETAIL

Previous Renewals 1921 + 1969 OCSO

Monument(s) Found: (Condition and Source)

1 I.P. IRON PIPE IS FOUND
2" BELOW GROUND (1921)

N/A

Accessories Found:

13" NOW 18" DIA W/OAK WITH A FULLY HEALED SINGLE
BLAZE, BEARS N35°W, 28.8 FT (AGREES WITH REC.) 1969

24" NOW 26" DIA W/OAK WITH A FULLY HEALED DOUBLE
BLAZE, BEARS S87°W, 102.7 FT (AGREES WITH REC.) 1969

EVIDENCE OF A ROTTED OAK STUMP, BEARS
N70°W, 31.7 FT. (AGREES WITH REC.) OIST

C.S. File No. 6474-28

RENEWAL

Monument Set (Procedure and Description)

IRON PIPE IS REFERENCED AND REMOVED, MEASURED 19" LONG A 2 3/8" BRASS CAP ON A 1 7/8" D.O. BY 32" LONG IRON PIPE IS SET AT REFERENCED POSITION PROTRUDING 1" ABOVE GROUND. 1" I.P. IS SET ALONG NORTH EDGE OF BC/IP 3" UNDER GROUND.

Monument Detail

DOUGLAS COUNTY SURVEYORS
T263

DLC | R
61 | 6
SE COR W

1997
OFFICE

New Accessories

20" DIA MADRONE DOUBLE BLAZED AND SCRIBED "SE DLC 61 CS BT"
BEARS N62°W, 44.0 FT.
7" DIA MADRONE BARK SCRIBED "SE DLC 61 CS BT"
BEARS S63 1/2°E, 31.2 FT.

Sketch of Monument, Accessories, and General Area

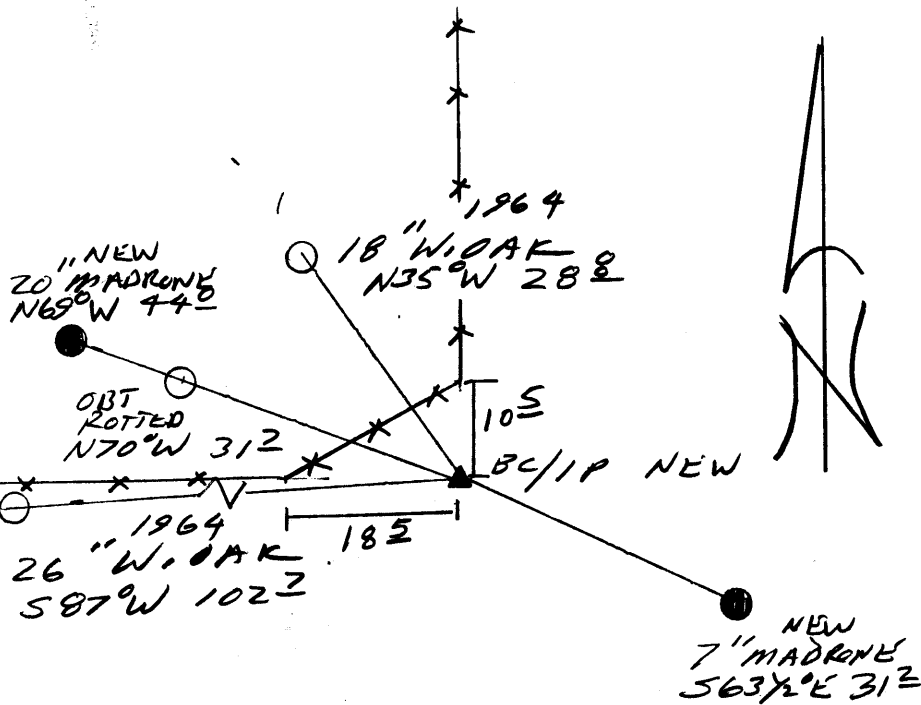

Location & Comments

CORNER UBS AT THE PROJECTION OF A NORTH AND WEST RUNNING FENCE LINE

Comp. Declin. 17 3/4° E
Agency DCSO
Party Chief RANDALL W. SMITH
Notekeeper [Signature]
Witnesses STEPHEN J. FLAUSE

Address

Surveyor's Seal

REGISTERED PROFESSIONAL LAND SURVEYOR

[Signature]

DATE 6-30-98

OREGON
JULY 25, 1990
RANDALL W. SMITH
2489